

SMART LIVING



DESIGNER HOOD



One Touch Cleaning



Dismantable Front Ducting Panel For Easy Cleaning



SMART SENSOR

Just WAVE to POWER ON /OFF and changing SPEEDS

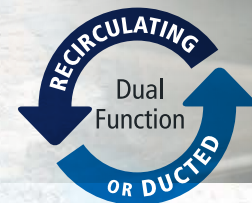

The future of kitchen innovation is now here! Morgan's Powerful Revolution Smart Series Hood with GESTURE CONTROL & AUTO HEAT CLEANING redefines the way you cook, and clean-up after cooking. No more oily or wet hands touching function buttons. Just a convenient wave of the hand will do!



Heating Device Heats Up Oil



Oil Softens and is Dissolved



Oil Residues Flow Into Oil Cup

AUTO HEAT CLEANING

Morgan's innovative Auto Heat Cleaning Technology uses centrifugal force to heat up and dissolve oil residues in the air chamber and metal exhaust fan. Your kitchen hood stays clean for optimal performance.

DESIGNER HOOD

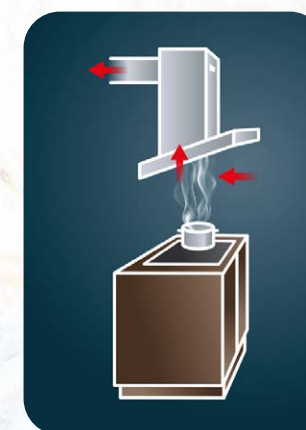

Ducted Ventilation

- Extracts odours up to 98%
- Extracts steam
- Requires ducting system

* It is recommended to leave a window ajar when operating the ducting system.

TO DUCT OR RECIRCULATE?

In the kitchen, it is ideal to use a ducted hood that vents outdoors to ensure optimal air extraction. However, this may not always be practical.

In contrast, the majority of Morgan range hoods are equipped with a recirculation made that passes air through a metal filter to remove grease, and then through a carbon returning the purified air to the kitchen.

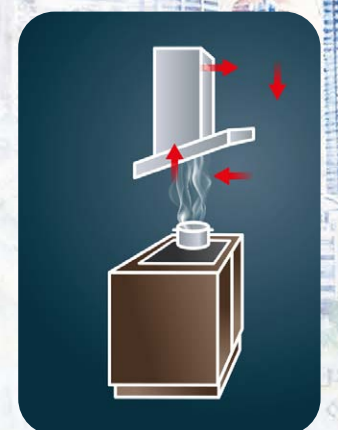

Recirculated Ventilation

- Clean air filter eliminates cooking odours
- Easy installation – requires no ducting
- Requires separate recirculation kit

BUILT-IN HOB



Blue Concentrated Flame

For maximum heating power and better combustion

Multi-directional Air Supply

For stable, consistent combustion

Extended Ejector Tube

Fully mixes air & gas with strong gas suction

The Morgan OPTIFLEX series ensure powerful, heat-concentrated flames with stable combustion and it elevate your cooking with enhanced flavours and cooking results.

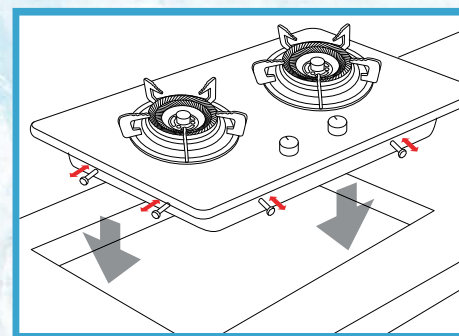

FITS EASILY INTO YOUR EXISTING COOKTOP SPACE

Recommended fitting dimensions (mm):

- MBH-622 OPTIFLEX:
635-735(W) x 350-421(D)
- MBH-SD625 OPTIFLEX:
640-730(W) x 360-410(D)
- MBH-SD636 OPTIFLEX:
635-820(W) x 350-460(D)

you can easily make use of its adaptable cut-out dimension to replace your old burner and experience the differences.



BUILT-IN HOB



Powerful Flame with Heat Deflector



Dupicast Iron Trivets



Energy concentrator for stronger flame



Safety Valve



Burner Cap

Outer Burner

Burner Base

Safety Device

MBH-SD2112

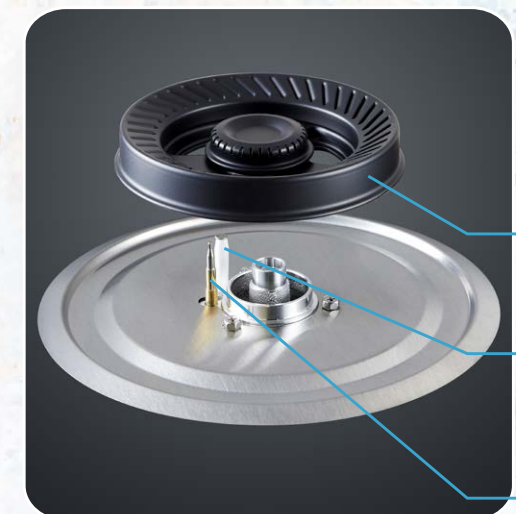

Burner

Sparker

Safety Device

BUILT-IN PACKAGE



Metal Blower

Oil Collector

LED Light

OR



DESIGNER HOOD MDH-926MHC

- Product Dimension(mm): 865L x 450D x 505+455H
- Black Coated Stainless Steel & Tempered Glass Finishing
 - Suction Power: Up to 1400m³/hr
 - Control Panel: 3 Speed Touch Control & Touchless Smart Motion Sensor
 - With Heat Auto-Cleaning Function
 - Washable baffle filter
 - LED light
 - With rectangle oil cup
 - With Charcoal filter
 - 2 Chimneys
 - With Metal blower
 - Duct out or Recirculation system

RM999(WM) RM1099(EM)
RRP: RM1158(WM) RM1258(EM)

RANGE HOOD MCH-ND390(BK)

- Product Dimension(mm): 900L x 470D x 146H
- 900mm Slim Hood
 - Wall Mount
 - Twin motors with suction power up to 900m³/h
 - 3-Ply aluminum filters for efficient removal of cooking grease
 - Charcoal filters for removal of odors
 - Duct Out or Recirculating System
 - Push Button
 - 3 Speed Selection
 - 2 X LED light
 - Washable Filter
 - Copper Motor
 - Full black chassis with black front panel

RM699(WM) RM749(EM)
RRP: RM908(WM) RM958(EM)



UPGRADE From MBH-SD2112 or MBH-166SS



BUILT-IN HOB MBH-SD2112

- Product Dimension(mm): 730L x 410D x 168H
- Tempered glass 8mm
 - Powerful flame – L/R: 4.5kW
 - Duplicast iron trivets
 - 2 Burner caps (mm): 125 x 125
 - Battery Ignition
 - Easy to maintain and clean surface
 - With Safety device

RRP: RM419(WM) RM439(EM)

OR



BUILT-IN HOB MBH-166SS

- Product Dimension(mm): 720L x 400D x 140H
- Stainless steel top
 - Powerful flame: L/R: 4.25kW
 - 2 Burner stainless steel hob
 - With safety valve
 - Battery ignition
 - Easy to clean surface

RRP: RM419(WM) RM439(EM)



BUILT-IN HOB MBH-SD636 OPTIFLEX

- Product Dimension(mm): 860L x 500D x 151H
- Tempered glass 8mm
 - Powerful flame – L/R: 5.0kW
 - Duplicast iron trivets
 - With heat deflector
 - With energy concentrator
 - With safety valve
 - Flexible to fit in any cut out size

RRP: RM779(WM) RM809(EM)

ADD ON: **RM360(WM) RM370(EM)**



BUILT-IN HOB MBH-622 OPTIFLEX

- Product Dimension(mm): 800L x 450D x 156H
- Tempered glass 8mm
 - Powerful flame – L/R: 4.3kW
 - Flexible to fit in any cut out size
 - Duplicast iron trivets

RRP: RM629(WM) RM649(EM)

ADD ON: **RM210(WM) RM210(EM)**

BUILT-IN PACKAGE

PWP

with purchase of any
MORGAN Hob Hood package
will entitle to buy:



Ceramic Cooker (MCC-2002) at
RM149(WM) / RM159(EM)

OR



Pan Grill (MPG-DA898NS) at
RM189(WM) / RM199(EM)

INDIVIDUAL PURCHASE



BUILT-IN HOB MBH-SD2112

RM379(WM) RM399(EM)
RRP: RM419(WM) RM439(EM)



BUILT-IN HOB MBH-166SS

RM379(WM) RM399(EM)
RRP: RM419(WM) RM439(EM)



BUILT-IN HOB MBH-SD636 OPTIFLEX

RM709(WM) RM739(EM)
RRP: RM779(WM) RM809(EM)



BUILT-IN HOB MBH-622 OPTIFLEX

RM569(WM) RM589(EM)
RRP: RM629(WM) RM649(EM)



DESIGNER HOOD MDH-926MHC

RM669(WM) RM749(EM)
RRP: RM739(WM) RM819(EM)



RANGE HOOD MCH-ND390(BK)

RM449(WM) RM479(EM)
RRP: RM489(WM) RM519(EM)

HOB/HOOD SPECIFICATION

* MBH-SD636 OPTIFLEX



Duplicast Iron Trivets



Safety Valve

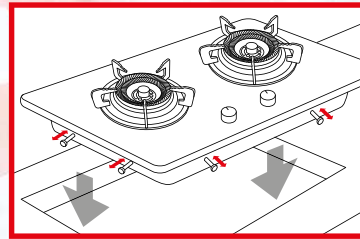

FITS EASILY INTO YOUR EXISTING COOKTOP SPACE

Recommended fitting dimensions (mm):

- MBH-622 OPTIFLEX: 635-735(W) x 350-421(D)
- MBH-SD625 OPTIFLEX: 640-730(W) x 360-410(D)
- MBH-SD636 OPTIFLEX: 635-820(W) x 350-460(D)

MBH-622 OPTIFLEX



Powerful Flame



Duplicast Iron Trivets

MBH-SD2112



Powerful Flame



Duplicast Iron Trivets/
Safety Valve

MBH-1665S



Powerful Flame



Duplicast Iron Trivets

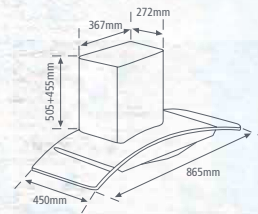

MDH-926MHC



MCH-ND390(BK)

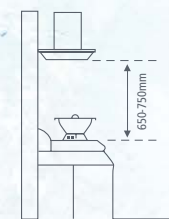

T-HOOD/ARCH-GLASS
HOOD

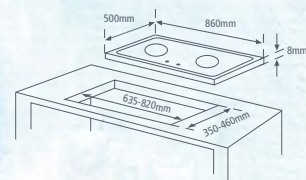

MBH-SD636 OPTIFLEX

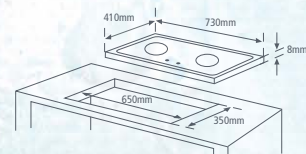

MBH-GC1122 ENDURE /
MBH-SD2112

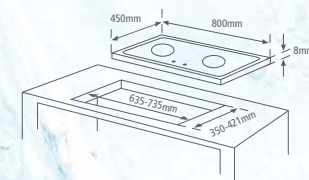

MBH-622 OPTIFLEX

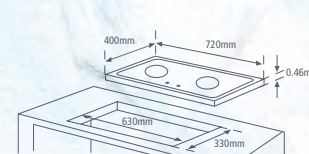

MBH-1665S

GAS STOVE

1yr
Warranty



DOUBLE GAS STOVE

MGS-8812G

- Product Dimension(mm): 720L x 380D x 135H
- 115mm x 115mm Cast Iron Burner Head
 - Powerful flame – L/R: 3.6kW
 - Glass Top For Elegant Look & Easy Cleaning
 - Black Coated Iron Base
 - Enamel Trivet for Durability

RM179(WM) RM189(EM)
RRP: RM189(WM) RM199(EM)



DOUBLE GAS STOVE

MGS-9613S

- Product Dimension(mm): 710L x 370D x 150H
- 125mm x 125mm Copper Burner Head
 - Powerful flame – L/R: 4.5kW
 - 100% Stainless Steel Body
 - Elegant Design
 - Enamel Trivet for Durability

RM159(WM) RM169(EM)
RRP: RM169(WM) RM179(EM)



DOUBLE GAS STOVE

MGS-7010

- Product Dimension(mm): 710L x 370D x 130H
- 100mm x 100mm Beehive Burner Head
 - Powerful flame – L/R: 3.2kW
 - Elegant Design
 - Enamel Trivet for Durability

RM69(WM) RM79(EM)
RRP: RM79(WM) RM89(EM)



DOUBLE GAS STOVE

MGS-7313S

- Product Dimension(mm): 710L x 390D x 150H
- 130mm x 130mm stainless steel burner head
 - Powerful flame – L/R: 3.6kW
 - Stainless steel top
 - Double pipe
 - Double 8 jets burner
 - Piezo ignition

RM129(WM) RM139(EM)
RRP: RM139(WM) RM149(EM)



DOUBLE GAS STOVE

MGS-7212S

- Product Dimension(mm): 710L x 390D x 128H
- 120mm x 120mm stainless steel burner head
 - Powerful flame – L/R: 3.1kW
 - Stainless steel top
 - Double pipe
 - Enamel trivet for durability
 - Piezo ignition

RM119(WM) RM129(EM)
RRP: RM129(WM) RM139(EM)



FOOD STEAMER



FOOD STEAMER MFS-29 NUTRISTEAM (BK) MFS-29 NUTRISTEAM (WH)

- Product Dimension(mm): 466L x 349D x 401H
- Power: 1600W
 - Capacity: 28L
 - Come with double heaters
 - Rice steaming container and water refill cup
 - Stackable steam tray for easy storage
 - Exterior water refill funnel with visible water level indicator
 - Anti-dry thermostat protection
 - 2 levels structure for convenient cooking
 - 60 minutes timer with bell

RM279(WM) RM299(EM)
RRP: RM309(WM) RM329(EM)



Stackable for easy Storage



Removable Tray for Larger Steaming Compartment



Individual Steaming Compartment



Convenient Refill



Accessories



PAN GRILL

PAN GRILL MPG-DA898NS

- Product Dimension(mm): 660L x 260D x 180H
- Power rating: 1500-1800W
 - Dual temperature control
 - Oil free cooking for healthier meals

RM219(WM) RM229(EM)
RRP: RM239(WM) RM249(EM)



Grill Feature



Steamboat Function



Oil Drip Tray



INSTANT BOILER



INSTANT BOILER MIB-6620

- Product Dimension(mm): 271L x 151D x 317H
- Power rating: 2000-2300W
 - Capacity: 3.0L
 - Removable transparent water tank with water level indicator for easy refilling and cleaning
 - Digital LED Display and Touch Sensor Control
 - Child Safety Lock
 - 5 water dispensing settings: 100ml, 200ml, 300ml, 400ml & 000 (continuous flow).
 - 7 temperature settings: 45°C, 55°C, 65°C, 75°C, 85°C, 100°C & 000 (normal temperature).
 - One-touch presets: Milk (40°C) & Coffee (92°C).
 - Error message E7 display with sound alert when water tank is empty.
 - Removable water drip tray for easy cleaning.

RM319(WM) RM329(EM)
RRP: RM349(WM) RM359(EM)



Removable transparent water tank



One-touch presets: Milk (40°C)



Digital LED Display and Touch Sensor



One-touch presets: Coffee (92°C)

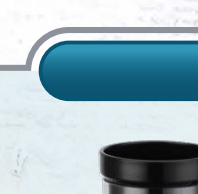

JUICE EXTRACTOR



JUICE EXTRACTOR MJE-SD400W

Product Dimension(mm): 210L x 180D x 280H

- Power rating: 400W
- Capacity: 600ml
- Durable Design: This juicer features a lightweight yet robust plastic body encased in a sleek stainless steel housing for added stability and a touch of elegance in your kitchen.
- Efficient Extraction: The 1L residue cup efficiently collects pulp, while the stainless steel filter with a plastic frame ensures maximum juice extraction and easy cleaning.
- Versatility and Convenience: The extra-large 65mm feeding tube accommodates a wider variety of fruits and vegetables, whole or cut into larger pieces, saving you prep time.
- Effortless Control: The two-speed control allows you to tackle both soft and hard ingredients with ease, while the secure lock

RM109(WM) RM119(EM)
RRP: RM119(WM) RM129(EM)



Non-stick Coated Nut Plate



Non-stick Coated Sandwich Plate



Non-stick Coated Waffle Plate

SANDWICH MAKER



3 IN 1 DETACHABLE SANDWICH MAKER MDM-383

- Product Dimension(mm): 225L x 226D x 95H
- Power rating: 750W
 - With detachable Sandwich plate, Waffle plate and Nut plate (BAHULU Egg Sponge Cakes)
 - Non-stick coated plate for easy cleaning
 - Automatic temperature control
 - Horizontal & Vertical for compact storage and space saving
 - With power and ready indicator light
 - Anti-slip feet design
 - Cool touch handle with lock
 - Cord storage

RM109(WM) RM119(EM)
RRP: RM119(WM) RM129(EM)



TOASTER



TOASTER MTS-32

- Product Dimension(mm): 250L x 150D x 170H
- Power rating: 650W
 - 2 slice pop-up toaster
 - 6 levels adjustable browning control
 - With cancel function
 - With removable crumb tray
 - Cord storage

RM53(WM) RM63(EM)
RRP: RM59(WM) RM69(EM)

TOASTER MTS-22A

- Product Dimension(mm): 250L x 151D x 182H
- Power rating: 750W
 - Auto bread centralizing feature
 - Wider slot for thicker breads
 - With dust cover
 - With defrost, reheat, cancel functions & 7 levels of browning control.
 - With crumb tray

RM62(WM) RM72(EM)
RRP: RM69(WM) RM79(EM)



ELECTRIC OVEN

1yr
Warranty



ELECTRIC OVEN MEO-GLAMO 150RCSS

Product Dimension(mm): 860L x 610D x 465H

- Power: 2800W
- Capacity: 150L
- 8 function selector: OFF, Fermentation, Upper heating, Lower heating, Upper + Lower heating, Upper + Lower heating with Convection, Upper + Lower heating with Rotisserie and Upper + Lower heating with Convection + Rotisserie.
- With defrost function (at top temperature control knob)
- 70°C to 250°C adjustable temperature selector for various cooking functions
- 2pcs "M" shape Stainless steel heating elements
- Independent temperature control. (Top & bottom temperature can be adjusted separately.)
- 120 minutes switch off timer with ring.
- With inner oven lamp
- Accessories: 3pcs enamel baking tray, rotisserie set, rotisserie Basket, wire rack, crumb tray and tray handle

RM859(WM) RM959(EM)
RRP: RM949(WM) RM1049(EM)



ELECTRIC OVEN MEO-GLAMO 100RC

Product Dimension(mm): 740L x 505D x 465H

- Power: 2800W
- Capacity: 100L
- 8 function selector: OFF, Fermentation, Upper heating, Lower heating, Upper + Lower heating, Upper + Lower heating with Convection, Upper + Lower heating with Rotisserie and Upper + Lower heating with Convection + Rotisserie.
- With defrost function (at top temperature control knob)
- 70°C to 250°C adjustable temperature selector for various cooking functions
- 2pcs "M" shape Stainless steel heating elements
- Independent temperature control. (Top & bottom temperature can be adjusted separately.)
- 120 minutes switch off timer with ring.
- With inner oven lamp
- Accessories: Rotisserie set, wire rack, 2pcs enamel baking tray, crumb tray and tray handle.

RM519(WM) RM589(EM)
RRP: RM569(WM) RM639(EM)

AIR FRYER

1yr
Warranty



Frying without Oil



Ideal for Roasting



Ideal For Grilling



AIR FRYER MAF-C707

Product Dimension(mm): 375L x 314D x 380H

- Power: 1800W
- Capacity: 7.7L
- Temperature control 80°C-200°C
- With timer up to 30 minutes
- Ideal for Roasting, Grilling and Frying without oil
- With non-stick coating pot
- Extra large capacity for various cooking needs
- With rapid air circulation system

RM219(WM) RM239(EM)
RRP: RM239(WM) RM259(EM)



Frying without Oil



Ideal for Roasting



Ideal For Grilling



Large LED Digital Display



DIGITAL AIR FRYER MAF-946D

Product Dimension(mm): 310L x 265D x 320H

- Power: 1300-1500W
- Capacity: 4.5L
- Adjustable Temperature Setting 80°C-200°C
- Touch screen with 12 presets control panel
- LED digital display
- With timer up to 60 minutes
- FDA Safe Non-stick Coating Frying Pot and easy cleaning
- With Rapid Air Circulation Technology
- With safety cut-off switch when basket is pull out during operation.
- Automatic shut-off

RM219(WM) RM229(EM)
RRP: RM239(WM) RM249(EM)

RICE COOKER

1yr
Warranty



COMMERCIAL RICE COOKER MCR-VAST 10

Product Dimension(mm): 595L x 503D x 378H

- Power rating: 2800W
- Capacity: 10L
- Large control panel with 1 button easy operation
- Stainless steel large handle lid with holder for hung on the side of the pot
- Removable non-stick inner pot
- With keep warm functions
- With overheat cut-off protection
- Max rice volume: 7.5kgs & min rice volume 2kgs; Max. up to 50 persons

RM359(WM) RM389(EM)
RRP: RM399(WM) RM429(EM)



Accessories



COMMERCIAL RICE COOKER MCR-VAST 7

Product Dimension(mm): 542L x 441D x 345H

- Power rating: 2500W
- Capacity: 6.6L
- Large control panel with 1 button easy operation
- Stainless steel large handle lid with holder for hung on the side of the pot
- Removable inner pot with non-stick coating
- With keep warm functions
- With overheat cut-off protection
- Max rice volume: 5kgs & min rice volume 1.6kgs; Max. up to 35 persons

RM269(WM) RM289(EM)
RRP: RM289(WM) RM309(EM)



RICE COOKER MRC-TC06NS

Product Dimension(mm): 252L x 222D x 216H

- Power rating: 350W
- Capacity: 0.6L
- Glass Lid
- Non-stick Coated Inner Pot
- With Over-heating Protection
- Cook & auto keep warm function
- Accessories: rice scoop and measuring cup

RM69(WM) RM79(EM)
RRP: RM79(WM) RM89(EM)

JUG KETTLE

1yr
Warranty



DOUBLE WALL JUG KETTLE MJK-DW8218

Product Dimension(mm): 226L x 152D x 256H

- Rated wattage: 1850W
- Capacity: 1.8L
- SUS304 Stainless Steel Seamless Inner Pot For Easy Cleaning
- Colour Steel Cool Touch Exterior
- Automatic Shut-off and Boil-dry Protection
- ON/OFF Switch
- 360° Rotating Base

RM99(WM) RM109(EM)
RRP: RM109(WM) RM119(EM)

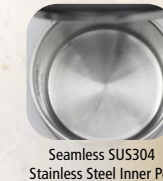

ON/OFF Switch with Indicator Light



JUG KETTLE MJK-917

Product Dimension(mm): 226L x 127D x 245H

- Rated wattage: 1850-2200W
- Capacity: 1.7L
- Removable Filter For Easy Cleaning
- Stainless Steel Heating Element
- ON/OFF Switch with Light Indicator

RM44(WM) RM54(EM)
RRP: RM49(WM) RM59(EM)



DOUBLE WALL JUG KETTLE MJK-G1117

Product Dimension(mm): 210L x 155D x 235H

- Rated wattage: 1850-2200W
- Capacity: 1.7L
- Transparent glass body
- Concealed heating plate with blue light ring
- Automatic Shut-off and Boil-dry Protection
- Cord storage

RM59(WM) RM69(EM)
RRP: RM69(WM) RM79(EM)



JUG KETTLE MJK-G1120

Product Dimension(mm): 235L x 160D x 250H

- Rated wattage: 1850-2200W
- Capacity: 2.0L
- Transparent glass body
- Concealed heating plate with blue light ring
- Automatic Shut-off and Boil-dry Protection
- Cord storage

RM69(WM) RM79(EM)
RRP: RM79(WM) RM89(EM)

THERMO POT

1yr
Warranty

THERMO POT MTP-266TSS

- Product Dimension(mm): 313L x 222D x 345H
- Power rating: 1200-1428W
 - Capacity: 6.0L
 - SUS304 Stainless steel inner pot
 - With safety lock function
 - 5 Temperature control: 90°C, 80°C, 60°C, 40°C and Auto Cool
 - Stainless steel steam vent
 - Screwless design lid
 - Unique base designed inner pot

RM170(WM) RM180(EM)
RRP: RM189(WM) RM199(EM)



THERMO POT MTP-350TSS

- Product Dimension(mm): 313L x 223D x 304H
- Power rating: 1200-1428W
 - Capacity: 5L
 - 'SUS 304' stainless steel interior pot
 - Screwless design lid
 - Stainless steel steam venting hole
 - Unique base designed inner pot

RM169(WM) RM179(EM)
RCP: RM179(WM) RM189(EM)

FOOD PROCESSOR / CHOPPER

1yr
Warranty



FOOD PROCESSOR/CHOPPER MCP-30P

- Product Dimension(mm): 198L x 157D x 257H
- Power rating: 300W
 - 4 stainless steel blades
 - Multifunction peeler (to peel garlic and peanut)
 - 1.2L capacity of glass bowl
 - 4D glass bowl design (allows the upper and lower blades to chop food evenly)
 - With safety operation design
 - User-friendly design

RM99(WM) RM109(EM)
RRP: RM109(WM) RM119(EM)

CERAMIC COOKER

1yr
Warranty



Ideal for Glassware



Ideal for Clay Pots



Ideal for Stainless Steel Grill Plate or Pot



CERAMIC COOKER MCC-2002

- Product Dimension(mm): 280L x 360D x 65H
- Power rating: 2000W
 - With stainless steel grill plate

RM169(WM) RM179(EM)
RRP: RM179(WM) RM189(EM)



STAND / HAND MIXER

1yr
Warranty



STAND MIXER MSM-SB1500

- Product Dimension(mm): 394L x 282D x 377H
- Power rating: 1500W powerful motor, low noise
 - 6.7L brushed stainless steel bowl
 - Variable 8 stepless speed and pulse function

RM679(WM) RM699(EM)
RRP: RM749(WM) RM769(EM)



Dough Kneading

Egg Beating



Batter Mixing

Splashguard with Convenient Ingredients Inlet



STAND MIXER MSM-MIXTE 12

- Product Dimension(mm): 445L x 290D x 384H
- Power rating: 1200W powerful motor
 - 5.5L Stainless Steel Bowl
 - Stepless speed and pulse function
 - Non-slipping rubber feet
 - Accessories: Whisk, Beater and Hook

RM399(WM) RM419(EM)
RRP: RM439(WM) RM459(EM)



Egg Whisking



Batter Mixing



Dough Kneading



Splash Guard with Convenient Ingredient Inlet



STAND MIXER MSM-NC400HM

- Gift Box (mm): 335L x 234D x 227H
- Power rating: 400W
 - Capacity: 3.5L mixer bowl
 - 5 speeds with turbo function

RM149(WM) RM159(EM)
RRP: RM159(WM) RM169(EM)



Hook



Beater



Whisk



HAND MIXER MHM-MIXX 300

- Product Dimension(mm): 218L x 105D x 225H
- Power rating: 300W
 - 6 speeds with Turbo function
 - With individual eject button
 - Accessories: 2pcs stainless steel beater, 2pcs dough hook and 1pc of whisk
 - With accessories storage box

RM59(WM) RM69(EM)
RRP: RM69(WM) RM79(EM)

CHEST FREEZER

CHEST FREEZER MCF-7307L

Product Dimension(mm): 2030L x 725D x 910H
 • Gross Capacity: 700L
 • CFC Free
 • 2 Doors
 • Durable Epoxy Inner
 • Fridge or Freezer Adjustable thermostat
 • Fridge Temperature: 2°C to 10°C
 • Freezer Temperature: -10°C to -20°C

RM2819(WM) RM3229(EM)
 RRP: RM3129(WM) RM3539(EM)

CHEST FREEZER MCF-6307L

Product Dimension(mm): 1800L x 760D x 827H
 • Gross Capacity: 600L
 • CFC Free
 • 2 Doors
 • Durable Epoxy Inner
 • Fridge or Freezer Adjustable thermostat
 • Fridge Temperature: 5°C to -3°C
 • Freezer Temperature: -8°C to -24°C

RM2239(WM) RM2489(EM)
 RRP: RM2479(WM) RM2729(EM)

CHEST FREEZER MCF-4607L

Product Dimension(mm): 1355L x 710D x 845H
 • Gross Capacity: 430L
 • CFC Free
 • Durable Epoxy Inner
 • Fridge or Freezer Adjustable thermostat
 • Fine Foam Technology
 • Wheels & Feet: 2 Feet + 2 Wheels
 • Coated Wire Basket
 • Fridge Temperature: 5°C to -3°C
 • Freezer Temperature: -8°C to -24°C

RM1639(WM) RM1879(EM)
 RRP: RM1819(WM) RM2059(EM)

CHEST FREEZER MCF-5607L

Product Dimension(mm): 1662L x 715D x 820H
 • Gross Capacity: 520L
 • CFC Free
 • 2 Doors
 • Durable Epoxy Inner
 • Fridge or Freezer Adjustable thermostat
 • Fridge Temperature: 5°C to -3°C
 • Freezer Temperature: -8°C to -24°C

RM2089(WM) RM2229(EM)
 RRP: RM2319(WM) RM2459(EM)



CHEST FREEZER

CHEST FREEZER MCF-3507LS

Product Dimension(mm): 1105L x 675D x 830H
 • Gross Capacity: 327L
 • CFC Free
 • Durable Epoxy Inner
 • Fridge or Freezer Adjustable thermostat
 • Fridge Temperature: 5°C to -3°C
 • Freezer Temperature: -8°C to -24°C
 • 2 Star Rating

RM1239(WM) RM1379(EM)
 RRP: RM1369(WM) RM1509(EM)

CHEST FREEZER MCF-3007LS

Product Dimension(mm): 955L x 675D x 830H
 • Gross Capacity: 271L
 • CFC Free
 • Durable Epoxy Inner
 • Fridge or Freezer Adjustable thermostat
 • Fridge Temperature: 5°C to -3°C
 • Freezer Temperature: -8°C to -24°C
 • 2 Star Rating

RM1099(WM) RM1239(EM)
 RRP: RM1219(WM) RM1359(EM)

CHEST FREEZER MCF-2178LS

Product Dimension(mm): 905L x 570D x 829H
 • Gross Capacity: 210L
 • CFC Free
 • Durable Epoxy Inner
 • Fridge or Freezer Adjustable thermostat
 • Fridge Temperature: 5°C to -3°C
 • Freezer Temperature: -8°C to -24°C
 • 2 Star Rating

RM989(WM) RM1149(EM)
 RRP: RM1089(WM) RM1249(EM)

CHEST FREEZER MCF-1678LS

Product Dimension(mm): 820L x 560D x 825H
 Gross Capacity: 175L
 • CFC Free
 • Durable Epoxy Inner
 • Fridge or Freezer Adjustable thermostat
 • Fridge Temperature: 5°C to -3°C
 • Freezer Temperature: -8°C to -24°C
 • 2 Star Rating

RM829(WM) RM939(EM)
 RRP: RM919(WM) RM1029(EM)

CHEST FREEZER MCF-0958LS

Product Dimension(mm): 530L x 440D x 830H
 • Gross Capacity: 80L
 • CFC Free
 • Durable Epoxy Inner
 • Fridge or Freezer Adjustable thermostat
 • Fridge Temperature: 5°C to -3°C
 • Freezer Temperature: -8°C to -24°C
 • 2 Star Rating

RM589(WM) RM719(EM)
 RRP: RM649(WM) RM779(EM)

CHEST FREEZER MCF-H105S

Product Dimension(mm): 545L x 476D x 836H
 • Gross Capacity: 102L
 • CFC Free
 • Durable Epoxy Inner
 • Fridge or Freezer Adjustable thermostat
 • Fridge Temperature: 1.4°C to -3°C
 • Freezer Temperature: -19°C to -27°C
 • 4 Star Rating

RM649(WM) RM739(EM)
 RRP: RM719(WM) RM809(EM)

CHEST FREEZER MCF-EVEREST 210

Product Dimension(mm): 545L x 476D x 835H
 • Gross Capacity: 102L
 • CFC Free
 • Epoxy Inner
 • With Key Lock
 • Deep and Quick Freezing
 • High Energy Efficiency Compressor
 • Easy to Clean
 • Fridge or Freezer Adjustable Thermostat
 • Coated Wire Basket
 • Compressor: 5 Year Warranty
 • Fridge Temperature: 3°C ~ -2°C
 • Freezer Temperature: -19°C ~ -30°C

RM629(WM) RM669(EM)
 RRP: RM699(WM) RM739(EM)

CHEST FREEZER MCF-EVEREST 220

Product Dimension(mm): 823L x 556D x 835H
 • Gross Capacity: 207L
 • CFC Free
 • Epoxy Inner
 • With Key Lock
 • Deep and Quick Freezing
 • High Energy Efficiency Compressor
 • Easy to Clean
 • Fridge or Freezer Adjustable Thermostat
 • Coated Wire Basket
 • Compressor: 5 Year Warranty
 • Fridge Temperature: 2.2°C ~ -2.5°C
 • Freezer Temperature: -16°C ~ -27°C

RM899(WM) RM969(EM)
 RRP: RM999(WM) RM1069(EM)

CHEST FREEZER MCF-EVEREST 230

Product Dimension(mm): 1125L x 610D x 835H
 • Gross Capacity: 308L
 • CFC Free
 • Epoxy Inner
 • With Key Lock
 • Deep and Quick Freezing
 • High Energy Efficiency Compressor
 • Easy to Clean
 • Fridge or Freezer Adjustable Thermostat
 • Coated Wire Basket
 • Compressor: 5 Year Warranty
 • Fridge Temperature: 3°C ~ -2°C
 • Freezer Temperature: -19°C ~ -30°C

RM1079(WM) RM1259(EM)
 RRP: RM1189(WM) RM1369(EM)



GLASS DOOR CHEST FREEZER

GLASS DOOR CHEST FREEZER MCF-G606L

- Product Dimension(mm): 1824L x 653D x 900H
- Gross Capacity: 586L
 - CFC Free
 - Epoxy Inner
 - With Key Lock
 - Deep and quick freezing
 - High Energy Efficiency Compressor
 - Fridge or Freezer Adjustable Thermostat
 - Easy to clean
 - With 2 Baskets
 - Fridge Temperature: 0°C to 10°C
 - Freezer Temperature: -1°C to -18°C
 - Maximum fit up to 5 Baskets

RM2599(WM) RM2919(EM)
RRP: RM2879(WM) RM3199(EM)



GLASS DOOR CHEST FREEZER MCF-G516L

- Product Dimension(mm): 1630L x 650D x 866H
- Gross Capacity: 516L
 - CFC Free
 - Epoxy Inner
 - With Key Lock
 - High Energy Efficiency Compressor
 - Fridge or Freezer Adjustable Thermostat
 - With 2 Baskets
 - Fridge Temperature: 0°C to 10°C
 - Freezer Temperature: -1°C to -18°C
 - Maximum fit up to 5 Baskets

RM2279(WM) RM2349(EM)
RRP: RM2529(WM) RM2599(EM)

GLASS DOOR CHEST FREEZER MCF-G456L

- Product Dimension(mm): 1434L x 651D x 870H
- Gross Capacity: 456L
 - CFC Free
 - Epoxy Inner
 - With Key Lock
 - High Energy Efficiency Compressor
 - Fridge or Freezer Adjustable Thermostat
 - With 2 Baskets
 - Fridge Temperature: 0°C to 10°C
 - Freezer Temperature: -1°C to -18°C
 - Maximum fit up to 4 Baskets

RM2009(WM) RM2069(EM)
RRP: RM2229(WM) RM2289(EM)



GLASS DOOR CHEST FREEZER MCF-G336L

- Product Dimension(mm): 1034L x 651D x 870H
- Gross Capacity: 336L
 - CFC Free
 - Epoxy Inner
 - With Key Lock
 - High Energy Efficiency Compressor
 - Fridge or Freezer Adjustable Thermostat
 - With 2 Baskets
 - Fridge Temperature: 0°C to 10°C
 - Freezer Temperature: -1°C to -18°C
 - Maximum fit up to 3 Baskets

RM1709(WM) RM1749(EM)
RRP: RM1899(WM) RM1939(EM)

GLASS DOOR CHEST FREEZER MCF-G256L

- Product Dimension(mm): 834L x 653D x 900H
- Gross Capacity: 256L
 - CFC Free
 - Epoxy Inner
 - With Key Lock
 - High Energy Efficiency Compressor
 - Fridge or Freezer Adjustable Thermostat
 - With 2 Baskets
 - Fridge Temperature: 0°C to 10°C
 - Freezer Temperature: -1°C to -18°C
 - Maximum fit up to 2 Baskets

RM1529(WM) RM1609(EM)
RRP: RM1689(WM) RM1769(EM)



CHILLER SHOWCASE

CHILLER SHOWCASE MCS-299

- Product Dimension(mm): 510L x 530D x 1676H
- Rated wattage: 210W
 - Gross Capacity: 240L
 - Adjustable Thermostat
 - Adjustable Leveling Leg
 - Double Glass Door (One with Tempered)
 - With Key Lock
 - 3 Coated Wire Rack
 - Self-evaporation water tray
 - Frost Free
 - Temperature: from 0°C to 10°C
 - Each shelf is able to hold up to: 20Kgs
 - Compressor 5 year warranty

RM1529(WM) RM1659(EM)
RRP: RM1689(WM) RM1819(EM)



CHILLER SHOWCASE MCS-850D

- Product Dimension(mm): 1050L x 640D x 2020H
- Rated wattage: 410W
 - Gross Capacity: 850L
 - Digital Thermostat
 - 4 Casters (70mm) + 1 Adjustable Leveling Leg
 - Door Glass: Double Layer Tempered with Single Low-E film and Electric Heating (Electric Heating with ON/OFF function)
 - With 2 Key Lock
 - 8 Coated Wire Rack
 - With 3 vertical LED light
 - Self-evaporation water tray
 - Frost Free
 - Temperature: from 1°C to 10°C
 - Each shelf is able to hold up to: 25Kgs
 - Compressor 5 year warranty

RM4369(WM) RM4719(EM)
RRP: RM4849(WM) RM5199(EM)

CHILLER SHOWCASE MCS-339

- Product Dimension(mm): 510L x 530D x 1826H
- Rated wattage: 220W
 - Gross Capacity: 280L
 - Adjustable Thermostat
 - Adjustable Leveling Leg
 - Double Glass Door (One with Tempered)
 - With Key Lock
 - 4 Coated Wire Rack
 - Self-evaporation water tray
 - Frost Free
 - Temperature: from 0°C to 10°C
 - Each shelf is able to hold up to: 20Kgs
 - Compressor 5 year warranty

RM1659(WM) RM1749(EM)
RRP: RM1839(WM) RM1929(EM)



"HEATING SYSTEM" can prevent fogging on the glass

CHILLER SHOWCASE MCS-488

- Rated wattage: 330W
- Gross Capacity: 430L
- Frost Free
- Inner dimension(mm): 523W x 510D x 1565H
- Product dimension(mm): 606W x 665D x 2000H
- Temperature: 0°C to 10°C
- Each shelf is able to hold up to 36kgs

RM2879(WM) RM2889(EM)
RRP: RM3189(WM) RM3199(EM)





REFRIGERATOR



NEW



TWO DOOR REFRIGERATOR MRF-M7460 TD

- Product Dimension(mm): 685L x 595D x 1700H
- Rated wattage: 180W
 - Gross Capacity: 446L
 - Frost Free Design
 - Multi Air Flow cooling system
 - Interior LED Light
 - Electronic temperature control.
 - Safety Glass Shelves
 - 3 Door Balcony (Fridge); 2 Door Balcony (Freezer)
 - Jumbo Fruit & Vegetable Box (with Humidity Control)
 - Anti-Bacterial Door Seal
 - High energy efficiency compressor
 - Fast & Efficient Cooling
 - Fridge Temperature: 0.4°C ~ 8 °C
 - Freezer Temperature: -12.3°C ~ -25°C
 - Adjustable Front Legs
 - Reversible door
 - Compressor: 10 Years Warranty

RM1699(WM) RM1919(EM)
RRP: RM1879(WM) RM2099(EM)



SINGLE DOOR REFRIGERATOR MRF-M7200 SD

- Product Dimension(mm): 519L x 572D x 1292H
- Rated wattage: 80W
 - Gross Capacity: 191L
 - Semi-auto defrost
 - Interior Lighting
 - Easy-to-use mechanical temperature control.
 - Separate chiller compartment
 - Safety Glass Shelves
 - 4 Door Balcony
 - Jumbo Fruit & Vegetable Box
 - Anti-Bacterial Door Seal
 - High energy efficiency compressor
 - Fast & Efficient Cooling
 - Fridge Temperature: 0°C ~ 10 °C
 - Freezer Temperature: -5.7°C ~ -16°C
 - Adjustable Front Legs
 - Reversible door
 - Compressor: 10 Years Warranty

RM809(WM) RM959(EM)
RRP: RM899(WM) RM1049(EM)



SINGLE DOOR REFRIGERATOR MRF-M7110 SD

- Product Dimension(mm): 474L x 445D x 830H
- Rated wattage: 60W
 - Gross Capacity: 101L
 - Easy-to-use mechanical temperature control.
 - Separate chiller compartment
 - 1 Safety Glass Shelves
 - 3 Door Balcony
 - Jumbo Fruit & Vegetable Box
 - Anti-Bacterial Door Seal
 - Reversible Door
 - High energy efficiency compressor
 - Fast & Efficient Cooling
 - Fridge Temperature: 0°C ~ 10°C
 - Freezer Temperature: -12.6°C ~ -17.8°C
 - Adjustable Front Legs
 - Reversible door
 - Compressor: 10 Years Warranty

RM589(WM) RM619(EM)
RRP: RM649(WM) RM679(EM)



REFRIGERATOR

TWO DOOR REFRIGERATOR MRF-M7280 TD

- Product Dimension(mm): 545L x 575D x 1695H
- Rated wattage: 80W
 - Gross Capacity: 270L
 - Frost Free Design
 - Multi Air Flow cooling system
 - Interior LED Light
 - Electronic temperature control.
 - Safety Glass Shelves
 - 3 Door Balcony (Fridge); 2 Door Balcony (Freezer)
 - Jumbo Fruit & Vegetable Box (with Humidity Control)
 - Anti-Bacterial Door Seal
 - High energy efficiency compressor
 - Fast & Efficient Cooling
 - Fridge Temperature: 0°C ~ 10 °C
 - Freezer Temperature: -5.7°C ~ -16°C
 - Adjustable Front Legs
 - Reversible door
 - Compressor: 10 Years Warranty

RM1279(WM) RM1499(EM)
RRP: RM1419(WM) RM1639(EM)



TWO DOOR REFRIGERATOR MRF-M7230 TD

- Product Dimension(mm): 567L x 580D x 1460H
- Rated wattage: 70W
 - Gross Capacity: 225L
 - Frost Free Design
 - Multi Air Flow cooling system
 - Interior LED Light
 - Electronic temperature control.
 - Safety Glass Shelves
 - 3 Door Balcony (Fridge); 2 Door Balcony (Freezer)
 - Jumbo Fruit & Vegetable Box (with Humidity Control)
 - Frameless design
 - Anti-Bacterial Door Seal
 - High energy efficiency compressor
 - Fast & Efficient Cooling
 - Fridge Temperature: 0°C ~ 10 °C
 - Freezer Temperature: -5.7°C ~ -16°C
 - Adjustable Front Legs
 - Reversible door
 - Compressor: 10 Years Warranty

RM1099(WM) RM1329(EM)
RRP: RM1219(WM) RM1449(EM)



MINI BAR



MINI BAR MMB-NB62LSL

- Capacity: 50L
- CFC Free
- Adjustable thermostat
- Product Dimension(mm): 475L x 450D x 487H

RM439(WM) RM449(EM)
RRP: RM479(WM) RM489(EM)



MINI BAR MMB-NC66(SL)

- Capacity: 50L
- CFC Free
- Adjustable thermostat
- Product Dimension(mm): 474L x 447D x 496H

RM439(WM) RM449(EM)
RRP: RM479(WM) RM489(EM)



UPRIGHT FREEZER

5yrs
Warranty
COMPRESSOR

1yr
Warranty
GENERAL



UPRIGHT FREEZER MUF-EC318LW

Product Dimension(mm): 710L x 770D x 1570H

- Rated wattage: 180W
- Gross Capacity: 351L
- Inverter compressor
- Frost Free & Auto Defrost Functions
- CFC Free
- Fridge or Freezer Adjustable Thermostat
- Digital Touch Control Panel with LED display
- Easy to Clean 5 Freezer Compartments
- External Easy-open Handle
- LED Light
- Stay Organized and Easy Access
- Super Energy Saving
- Multi Airflow Design
- Child Lock function
- Fridge Temperature: 2°C ↔ 3°C ↔ 4°C ↔ 5°C ↔ 6°C ↔ 7°C ↔ 8°C
- Freezer Temperature: -16°C ↔ -17°C ↔ -18°C ↔ -19°C ↔ -20°C ↔ -21°C ↔ -22°C ↔ -23°C ↔ -24°C
- Compressor: 5 Years Warranty

RM2639(WM) RM2839(EM)
RRP: RM2929(WM) RM3129(EM)



UPRIGHT FREEZER MUF-EC278L

Product Dimension(mm): 600L x 660D x 1850H

- Rated wattage: 130W
- Gross Capacity: 274L
- Frost Free & Auto Defrost Functions
- CFC Free
- Precise Electronics Control Panel
- Easy to Clean 7 Freezer Compartments (3 shelves + 4 drawers)
- Freezer Door with 2 Shelf Bars
- External Easy-open Handle
- Deep and Quick Freezing
- High Energy Efficiency Compressor
- LED Light
- Required Less Floor Space
- Stay Organized and Easy Access
- Freezer Temperature: -14°C ~ -22°C
- Compressor: 5 Years Warranty

RM2359(WM) RM2519(EM)
RRP: RM2619(WM) RM2779(EM)



UPRIGHT FREEZER MUF-EC208L

Product Dimension(mm): 540L x 600D x 1710H

- Rated wattage: 140W
- Gross Capacity: 204L
- Frost Free & Auto Defrost Functions
- CFC Free
- Precise Electronic Control Panel
- Easy to Clean 6 Freezer Compartments (2 trays + 4 drawers)
- Recessed Handle
- Deep and Quick Freezing
- High Energy Efficiency Compressor
- Required Less Floor Space
- Stay Organized and Easy Access
- Freezer Temperature: -14°C ~ -22°C
- Compressor: 5 Years Warranty

RM1609(WM) RM1769(EM)
RRP: RM1779(WM) RM1939(EM)



CIRCULATION FAN

1yr
Warranty

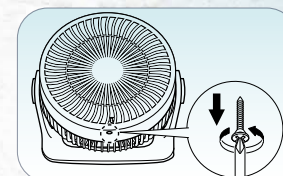

Remove the power plug from the power supply before disassembling the fan for cleaning. Remove the screw under the front cover.

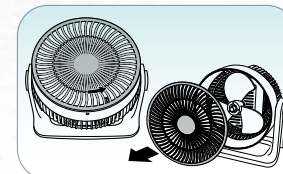

Twist the front cover to the left to detach it.

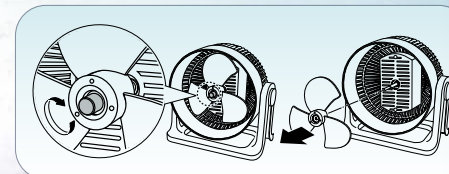

Twist the fan blade screw to the right and detach the fan blade. Proceed to clean the fan blade.

CIRCULATION FAN MFQ-SB35W(BK)

Product Dimension(mm): 249L x 155D x 240H

- Power: 35W
- 3 Speeds Hi / Mid. / Low
- Manual Oscillation up and down
- Adjustable tilt position.
- Easy dismantle for cleaning

RM69(WM) RM79(EM)
RRP: RM89(WM) RM99(EM)



CIRCULATION FAN MFQ-SC61M MFQ-SC61M(WH)

Product Dimension(mm): 282L x 262D x 355H

- Power: 60W
- Fan size: Ø265mm
- Fan blades size: Ø228mm
- Mechanical control
- Easy detachable front net cover for cleaning
- 4 setting speeds
- Left and right auto-oscillation angle up to 65°
- Up and down auto-oscillation angle up to 85°

RM199(WM) RM209(EM)
RRP: RM219(WM) RM229(EM)



CIRCULATION FAN MFQ-D3RC

Product Dimension(mm): 260L x 275D x 991H

- Power: 105W
- Fan Blades: Ø8" x 3
- Three Independent fan with 3 speed control.
- Adjustable tilt position.
- Auto Oscillation for left and right.
- Manual Oscillation for up and down.
- Timer setting up to 7 hours
- With remote control
- Easy dismantle for cleaning

RM379(WM) RM409(EM)
RRP: RM419(WM) RM449(EM)

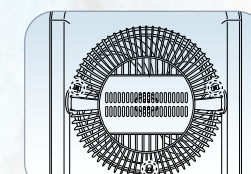

Remove the power plug from the power supply before disassembling the fan for cleaning. Remove the three screws from the back cover.

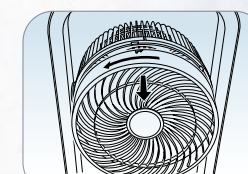

Twist the front cover to the left to detach it.

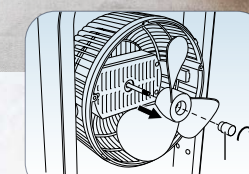

Twist the fan blade screw to the right and detach the fan blade. Proceed to clean the fan blade.



STAND FAN / WALL FAN



STAND FAN MSF-16P5

- Product Dimension(mm): 450L x 410D x 1185-1360H
- Power rating: 50W
 - 5 AS Fan Blade
 - Pure copper motor
 - Smooth Oscillation
 - 3 Speed mode
 - 2 Hours Timer
 - Adjustable Height (170mm)

RM129(WM) RM139(EM)
RRP: RM139(WM) RM149(EM)



WALL FAN MWF-180M

- Product Dimension(mm): 500L x 365D x 500H
- Power rating: 80W
 - With 6 PP Fan Blade
 - Wider and High Air Delivery
 - 3 Speed Setting
 - Smooth Oscillation
 - Flexible neck adjustment
 - Stronger Fan Guard with Reinforcement Ring
 - Equipped with a durable 100% Copper Motor
 - Built-in Safety Thermal Fuse

RM159(WM) RM179(EM)
RRP: RM169(WM) RM189(EM)



WALL FAN MWF-NC169RC

- Product Dimension(mm): 435L x 320D x 525H
- Power rating: 50W
 - 3 AS Fan Blade
 - High Quality & Durable copper motor
 - Smooth Oscillation
 - 3 Speed mode
 - 12 Hours Timer
 - Comes with Remote Control
 - Convenient Guard Ring Clip

RM149(WM) RM159(EM)
RRP: RM159(WM) RM169(EM)



WALL FAN MWF-NC168MS

- Gift Box (mm): 460L x 210D x 460H
- Power rating: 45W
 - Thermal safety fuse
 - High Quality & Durable Motor
 - Smooth Oscillation
 - 3 Speed Mode

RM129(WM) RM149(EM)
RRP: RM139(WM) RM159(EM)



PORTABLE AIR-COND



PORTABLE AIR-COND MAC-093 Lite

- Product Dimension(mm): 325L x 295D x 700H
- Cooling capacity: 9000btu/hr (1Hp)(2600W)
 - Suitable for room size up to 14-20m²
 - Refrigerant: R410A
 - Washable filters
 - Auto left & right swing louvers
 - Automatic Evaporative system
 - 3 in 1 function of Cooling/Dehumidifying/Fan
 - High & Low Fan Speeds
 - 24 Hour ON/OFF Timer
 - With Remote Control

RM969(WM) RM1009(EM)
RRP: RM1069(WM) RM1109(EM)



PORTABLE AIR-COND MAC-121 SIERRAIRE

- Product Dimension(mm): 430L x 357D x 813H
- Cooling capacity: 12000btu/hr (1.5Hp)(3500W)
 - Suitable for room size up to 25-30m²
 - Refrigerant: R410A
 - Auto Up/Down Swing Louvers
 - Automatic Evaporative System
 - 3-in-1 Function of Cooling, Dehumidifying and Fan
 - With LOW/MID/HIGH Fan Speeds
 - 24 hour ON/OFF Timer
 - With Remote Control

RM1489(WM) RM1539(EM)
RRP: RM1649(WM) RM1699(EM)



VENTILATION FAN

VENTILATION FAN MVF-CA12XS

- Product Dimension(mm): 255L x 255D x 170H
- Power rating: 30W
 - Ceiling Mounted Type
 - For Shop, Office Room, Living Room & Kitchen
 - Elegant Design
 - Energy Efficient
 - Fan size: 120mm

RM80(WM) RM90(EM)
RRP: RM89(WM) RM99(EM)



VENTILATION FAN MVF-CB12XW

- Product Dimension(mm): 255L x 255D x 170H
- Power rating: 30W
 - Ceiling Mounted Type
 - For Shop, Office Room, Living Room & Kitchen
 - Elegant Design
 - Energy Efficient
 - Fan size: 120mm

RM80(WM) RM84(EM)
RRP: RM85(WM) RM89(EM)



VENTILATION FAN MVF-WA120

- Product Dimension(mm): 400L x 145D x 400H
- Power rating: 45W
 - Wall Mounted Type
 - For Shop, Office Room, Living Room & Kitchen
 - Elegant Design
 - Powerful Motor
 - Fan size: 300mm

RM80(WM) RM90(EM)
RRP: RM89(WM) RM99(EM)

VENTILATION FAN MVF-WA100

- Product Dimension(mm): 345L x 138D x 345H
- Power rating: 35W
 - Wall Mounted Type
 - For Shop, Office Room, Living Room & Kitchen
 - Energy Efficient
 - Powerful Motor
 - Fan size: 250mm

RM71(WM) RM81(EM)
RRP: RM79(WM) RM89(EM)

VENTILATION FAN MVF-WA80

- Product Dimension(mm): 279L x 130D x 279H
- Power rating: 30W
 - Wall Mounted Type
 - For Shop, Office Room, Living Room & Kitchen
 - Energy Efficient
 - Powerful Motor
 - Fan size: 200mm

RM62(WM) RM72(EM)
RRP: RM69(WM) RM79(EM)



AIR COOLER

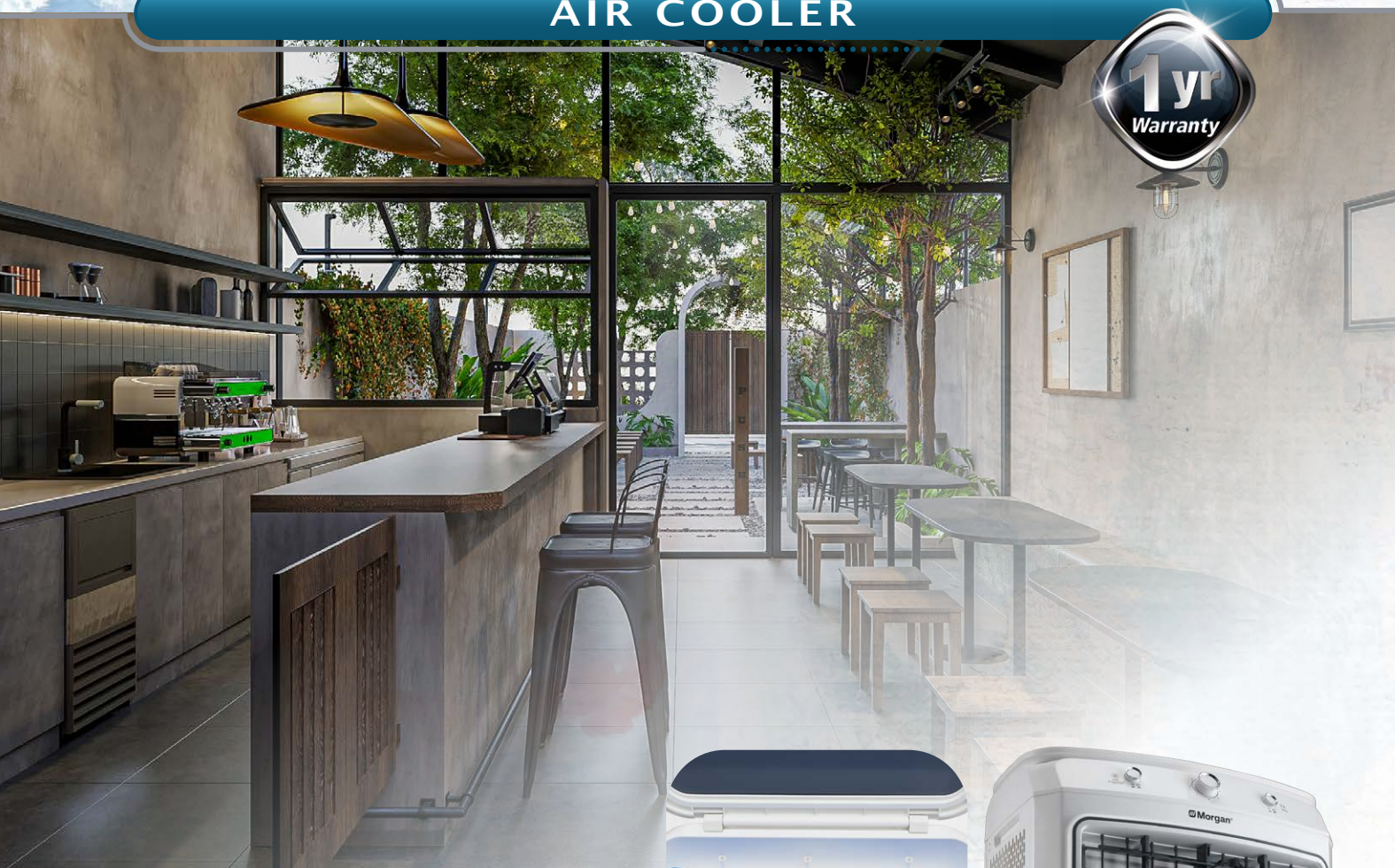

AIR COOLER MAC-AMPLEFLOW 16

- Product Dimension(mm): 720L x 475D x 1455H
- Power: 660W
 - Large water tank capacity: 135L
 - Air flow: 18,000m³/hr
 - Suitable for room size up to 80-90m²
 - 3-Sided Durable honeycomb filter for Max Cooling
 - 3 Speed Selection (L/M/H)
 - Metal body
 - With Automatic water inlet
 - 5 cooler packs

RM1249(WM) RM1409(EM)
RRP: RM1379(WM) RM1539(EM)



AIR COOLER MAC-COOL 9A

- Product Dimension(mm): 590L x 380D x 1200H
- Power: 350W
 - Large water tank capacity: 60L
 - Air flow: 7000m³/hr
 - Suitable for room size up to 50m²
 - 3-sided Durable Honeycomb filter for Max Cooling
 - 3 Speed Selection (L/M/H)
 - 2 Cooler Packs

RM569(WM) RM659(EM)
RRP: RM629(WM) RM719(EM)



AIR COOLER



AIR COOLER MAC-COOL7A

- Product Dimension(mm): 435L x 345D x 975H
- Power: 90W
 - Large water tank capacity: 35L
 - Air flow: 3000m³/hr
 - Suitable for room size up to 20-30m²
 - 3-Sided Durable honeycomb filter for Max Cooling with dust proof cover
 - LED Display With touch Control
 - Timer Setting Function Up to 12 Hours
 - 2 Cooler Packs

RM559(WM) RM609(EM)
RRP: RM619(WM) RM669(EM)



AIR COOLER MAC-CX12

- Product Dimension(mm): 280L x 295D x 730H
- Power: 65W
 - Large water tank capacity: 12L
 - Air flow: 1150m³/hr
 - Suitable for room size up to 20m²
 - Durable Honeycomb Filter with Dust Proof Cover
 - 4 Cooler Packs

RM269(WM) RM299(EM)
RRP: RM299(WM) RM329(EM)



AIR COOLER MAC-COOL 8A

- Product Dimension(mm): 530L x 355D x 1130H
- Power: 150W
 - Large water tank capacity: 60L
 - Air flow: 7000m³/hr
 - Suitable for room size up to 50m²
 - 3-Sided Durable honeycomb filter for Max Cooling with dust proof cover
 - LED Display With touch Control
 - Timer Setting Function Up to 4 Hours
 - 3 Speed Selection (L/M/H)
 - With remote control
 - Detachable water tank
 - 2 Cooler Packs

RM619(WM) RM679(EM)
RRP: RM679(WM) RM739(EM)



AIR COOLER MAC-CX10DW

- Product Dimension(mm): 235L x 264D x 600H
- Power: 65W
 - Large water tank capacity: 10L
 - Air flow: 1100m³/hr
 - Suitable for room size up to 15m² – 20m²
 - Durable Honeycomb filter with dust proof cover
 - 3 in 1 Air Cooler / Air Purifier / Humidifier
 - 2 cooler packs
 - 3 speed selection (L/M/H)
 - Removable water tank
 - With casters

RM209(WM) RM259(EM)
RRP: RM229(WM) RM279(EM)

GARMENT STEAMER



GARMENT STEAMER MSI-GB206

- Product Dimension(mm): 335L x 245D x 312H
- Power: 1350-1650W
 - Stainless Steel Steam Panel
 - Powerful Steam
 - Translucent 2.0L water tank
 - Steam rate 32g/min

RM189(WM) RM209(EM)
RRP: RM209(WM) RM229(EM)



Stainless Steel Steam Panel with Powerful Steam



Fabric Brush

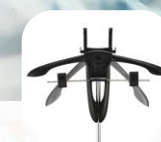

Rotatable & Collapsible Hanger



Little Helper – for Easy Ironing

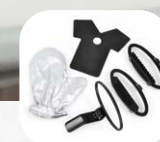

Accessories



VACUUM CLEANER



Motorized Dust Mite Brush



Ellipse Brush Easily Remove Dirt



Crevice Tool Clean Hard To Reach Places



Power Brush with LED Light



Detachable & Washable Filter



Washable Fiber Filter



Power Brush with 180° Swivels sideways and 90° up and down



LED Control Panel



Crevice Tool with Flexible Hose



Accessories



Hanger with Charger

Cordless 3 In 1 Stick/Handheld Vacuum Cleaner MVC-CHS198DB

Product Dimension(mm): 1160L x 250D x 220H

- Power rating: 450W
- Dust capacity: 0.5L
- Digital screen
- Charging time: 5 Hours
- Suction pressure: ≥ 120 AW
- Detachable and Rechargeable 2000mAh Lithium-Ion Battery
- 25000PA (High speed) / 14000PA (Middle speed) / 9000PA (Low speed)
- LED Front Light Multi-tasker Power Brush with 180° Swivels sideways and 90° up and down for convenient handling in corners and around obstacles.
- Operating time: 12 minutes (High speed), 25 minutes (Middle speed), 50 minutes (Low speed)
- Washable bagless dust container with cyclone stainless steel mesh filter
- Convenient and hygienic dust bucket emptying
- Three speed control for effective and thorough cleaning on various occasions
- Accessories: Mini turbo dust mite brush, 2 in 1 dusting brush, Crevice tool and Flexible hose.

RM659(WM) RM669(EM)
RRP: RM729(WM) RM739(EM)



UPRIGHT VACUUM CLEANER MVC-CYCLONE 60

Product Dimension(mm): 145L x 142D x 1100H

- Power rating: 600W
- Max Suction 150W, Max Vacuum 16 -18.72kpa
- Capacity: 1.2L
- Noise level ≤ 73 dB
- Upright and Handheld dual-usage
- With 2 stages filtering system
- Bagless design, simple dust disposal
- Detachable and extendable handle for different height level
- With 5 meter of power cord
- Compact size and easy storage
- Accessories: Dual function suction nozzle

RM99(WM) RM109(EM)
RRP: RM119(WM) RM129(EM)

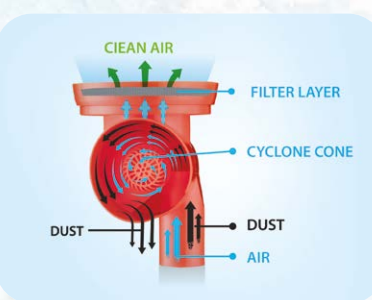

- This Cyclone Filter come with separation technology of dust and dirt to result optimal performance of the vacuum.
- It uses the principle of cyclone separation to pull dust and dirt to the bottom of the dust cup without blocking its performance.
- This is washable Cyclone filter.



Swivel Floor Brush for Easy Floor Cleaning



Cyclone Filter



Ellipse Brush Easily Removes Stubborn Dirt



Washable Filter



Crevice Tool Cleans Tight Places



Convenient Cord Storage

FULLY AUTO WASHING MACHINE



FULLY AUTO WASHING MACHINE MWM-TANZANITE 10TL

Product Dimension(mm): 550L x 560D x 940H

- Washing Capacity: 10.0Kg
- Spinning Capacity: 10.0Kg
- Washing power: 525W
- Stainless Steel Drum
- Transparent Tempered Glass Lid
- LED display panel
- Magic cleaning filter
- Anti-rat base design (Base cover)
- Power Off Memory
- Powerful & Durable Motor for Efficient Washing
- With Adjustable foot
- With Detergent Dispenser
- Fuzzy Control
- Functions: Delay End, ONE TOUCH, Child Lock
- With 7 program selection

RM1019(WM) RM1119(EM)
RRP: RM1129(WM) RM1229(EM)



FULLY AUTO WASHING MACHINE MWM-TANZANITE 7TL

Product Dimension(mm): 495L x 520D x 870H

- Washing Capacity: 7.0Kg
- Spinning Capacity: 7.0Kg
- Rated power: 360W
- Stainless Steel Drum
- Transparent Plastic Lid
- Rust-proof plastic body
- LED display panel
- Magic cleaning filter
- Anti-rat base design (Base cover)
- Power Off Memory
- Powerful & Durable Motor for Efficient Washing
- With Adjustable foot
- Fuzzy Control
- Functions: Delay End, ONE TOUCH, Child Lock
- With 10 program selection

RM679(WM) RM759(EM)
RRP: RM749(WM) RM829(EM)



FULLY AUTO WASHING MACHINE MWM-TANZANITE 8TL

Product Dimension(mm): 525L x 558D x 900H

- Washing Capacity: 8.0Kg
- Spinning Capacity: 8.0Kg
- Rated power: 495W
- Stainless Steel Drum
- Transparent Plastic Lid
- LED display panel
- Magic cleaning filter
- Anti-rat base design (Base cover)
- Power Off Memory
- Powerful & Durable Motor for Efficient Washing
- With Adjustable foot
- Fuzzy Control
- Functions: Delay End, ONE TOUCH, Child Lock
- With 7 program selection

RM849(WM) RM939(EM)
RRP: RM939(WM) RM1029(EM)



FULLY AUTO WASHING MACHINE MWM-7 ZIRCON

Product Dimension(mm): 515L x 508D x 875H

- Washing Capacity: 7.0Kg
- Spinning Capacity: 7.0Kg
- Washing power: 325W
- Spinning power: 250W
- Stainless Steel Drum
- Magic Cleaning Filter
- Foldable transparent lid
- Anti-Rat Base Design
- With Memory Back Up Function
- Powerful & Durable Motor for Efficient Washing
- With 8 program selection

RM679(WM) RM779(EM)
RRP: RM749(WM) RM849(EM)



FULLY AUTO WASHING MACHINE MWM-13 AQUAMARINE

Product Dimension(mm): 570L x 600D x 980H

- Washing Capacity: 13.0Kg
- Spinning Capacity: 13.0Kg
- Washing power: 410W
- Spinning power: 330W
- Stainless Steel Drum
- Magic Cleaning Filter
- Tempered Glass Transparent Lid
- With delay wash function
- Child Lock
- With Detergent drawer Compartment
- Fuzzy Control function
- Anti-Rat Base Design
- Powerful & Durable Motor for Efficient Washing
- With 9 program selection

RM1189(WM) RM1319(EM)
RRP: RM1319(WM) RM1449(EM)

SEMI AUTO WASHING MACHINE



SEMI AUTO WASHING MACHINE

MWM-1312SA

Product Dimension(mm): 893L x 515D x 997H

- Washing Capacity: 12.0Kg
- Spinning Capacity: 6.5Kg
- Washing power: 420W
- Spinning power: 180W
- Anti-rat Base Design
- With Lint Filter

RM689(WM) RM829(EM)

RRP: RM759(WM) RM899(EM)

SEMI AUTO WASHING MACHINE

MWM-1310SA

Product Dimension(mm): 823L x 475D x 978H

- Washing Capacity: 10.0Kg
- Spinning Capacity: 6.5Kg
- Washing power: 380W
- Spinning power: 180W
- Anti-rat Base Design
- With Lint Filter

RM589(WM) RM709(EM)

RRP: RM649(WM) RM769(EM)



SEMI AUTO WASHING MACHINE

MWM-1370SA

Product Dimension(mm): 730L x 400D x 810H

- Washing Capacity: 7.0Kg
- Spinning Capacity: 5.0Kg
- Washing power: 350W
- Spinning power: 160W
- Anti-rat Base Design
- With Lint Filter

RM449(WM) RM529(EM)

RRP: RM499(WM) RM579(EM)

FRONT LOAD WASHER DRYER



FRONT LOAD WASHER DRYER

MWD-SPACEPRO 10CB

Product Dimension(mm): 600L x 577D x 850H

- Washing power rating: 2000W
- Drying power rating: 1600W
- Washing Capacity: 10Kg
- Drying Capacity: 6Kg
- Wash & Dry Combo
- Extra Slim Body design
- Ozone sterilization function
- 16 Washing Programmers
- Washing Temperature: Cold, 20°C, 40°C, 60°C, 80°C, 85°C
- ECS system "Reduce vibration and running noise by correcting polarization timely."
- M-smart: One key to start the washing mode
- Door Lock & Child Safety Lock Display

RM1799(WM) RM1899(EM)

RRP: RM1999(WM) RM2099(EM)



TUMBLE DRYER



Front Lint Filter



LED Display



Hot Air Vent Hose



Front Lint Filter



LED Display



TUMBLE DRYER

MTD-SENSDRY 8

Product Dimension(mm): 595L x 525D x 843H

- Power rating: 1700W
- Capacity: 7Kg
- Dryer type: Venting
- Electronic control
- LED display
- 16 drying programs: Extra Dry, Standard Dry, Mix Dry, Airing, Iron Dry, Quilt, Towels, Shake the Quilt, Sportswear, Jeans, Fiber, 2.5 hours, 2 hours, 1.5 hours, 1 hour, 30 mins.
- Heat Setting: Full heating, Half heating and Airing.
- Crease Guard (Anti-Crease function to reduce wrinkling.)
- Delay timer: 1 – 12 hours
- Front lint filter
- Child lock indicator and Error alarm.

RM949(WM) RM1039(EM)

RRP: RM1049(WM) RM1139(EM)



TUMBLE DRYER

MTD-SENSDRY 10

Product Dimension(mm): 595L x 605D x 840H

- Power rating: 2000W
- Capacity: 10Kg
- Dryer type: Venting
- LED display
- 12 drying programs
- Material Selection : Mix, Cotton, Chemical Fiber, Wool
- Drying Time: Smart, 2 hours, 1 hour, 30 minutes
- Dryness Level : Extra Dry, Standard Dry Iron Dry, Airing
- Front lint filter
- Transparent door with 180° open
- Auto-power off and Auto stop drying
- Child lock indicator and Error alarm.

RM1189(WM) RM1289(EM)

RRP: RM1319(WM) RM1419(EM)





Exclusive Dealer:

- Offer valid while stocks last
- Prices shown are not valid for redemption project & duty-free sales
- We reserve the right to alter, modify or replace the product price, specifications & models without prior notice
- All items featured in this catalogue may differ from the actual product in terms of colour & design details
- The recommended retail price is the price which the importer recommends that the retailer sell the product. Retailers are able to independently set the retail price.

Market Expansion
Services by
www.dksh.com



DKSH

DKSH Malaysia Sdn Bhd 196101000441 (4476-U)
B-11-01, The Ascent Paradigm,
No. 1, Jalan SS7/26A, Kelana Jaya,
47301 Petaling Jaya, Selangor Darul Ehsan.
Tel: +603 7882 8888 Fax: +603 7882 5555
www.morgan.my

Customer Care Hotline: **03-7781 9229**



facebook.com/morganappliances