

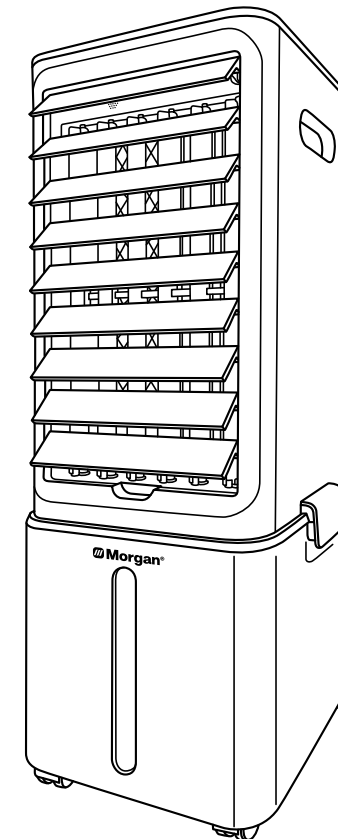

USER MANUAL



Air Cooler

MAC-CX10DW

Market Expansion
Services by
www.dksh.com



DKSH

E-mail: electrical.appliance@dksh.com
www.morgan.my

facebook.com/morganappliances



OPERATING INSTRUCTIONS

FILLING THE WATER TANK

(Refer to the illustrations below)

1. Lift up the 2 side buckles on the water tank behind the air cooler.
2. Detach the water storage body from the water tank. You may remove the water tank separately and add water to the water tank or use a container to add water to the water tank, and installing it after adding water.
3. Open the upper tank cover to add water directly. Do not add water too fast as water may overflow to the upper tank's external electrical components, resulting in a hazard. Pay attention to the water level display when filling water. Also note that:
 - The water level in the water tank must be less than "max." during filling.
 - The water level in the water tank must exceed the "min." for cooling and humidification function.
 - Cooler pack are placed into the water tank for rapid cooler effect.

WARNING: Ensure water level does not exceed "MAX" after placing the cooler pack.

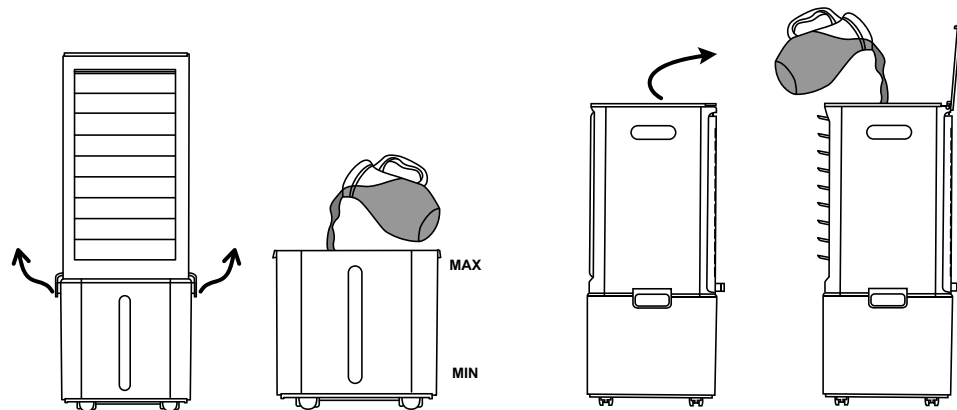

COOLER PACK

- The cooler pack can store is designed to cool and slowly absorb the cool air from water and reduce room temperature during operation.
- Place the cooler pack into the freezer.
- Open the flip plate of the upper water tank and put the cooler pack directly into the upper water tank.

- Keep the appliance away flammable and explosive objects. Do not operate appliance near flammable gases, fire and/or heat sources.
- Always keep power cord away to avoid tripping the appliance over.
- When not in use for a prolonged period, power off the appliance, unplug it from the power supply, and store it in dry, cool place.

PARTS IDENTIFICATION

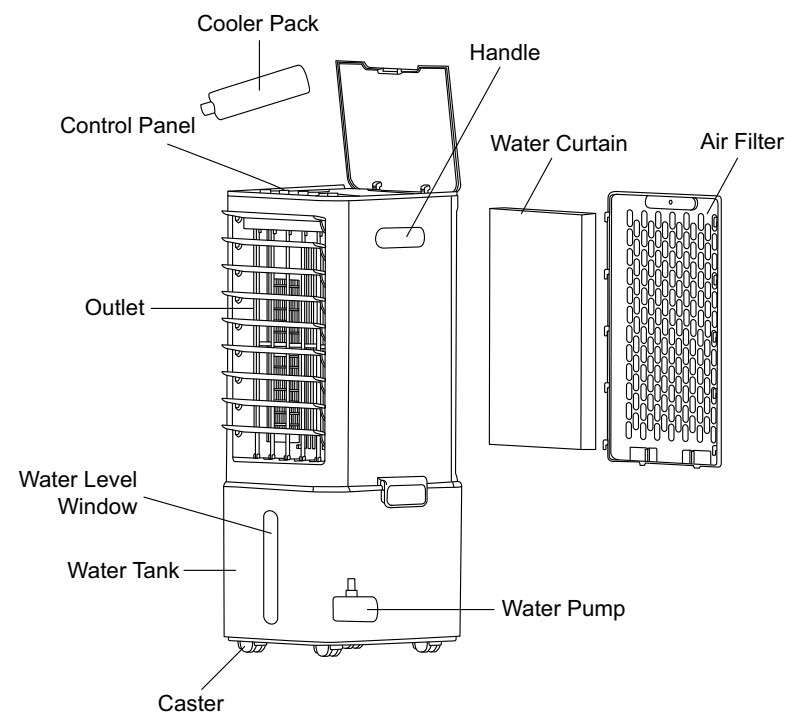

SPECIFICATIONS

MODEL NO.	MAC-CX12
RATED VOLTAGE	220-240V~
FREQUENCY	50-60HZ
RATED WATTAGE	65W
WATER TANK CAPACITY	10L

CONTROL PANEL

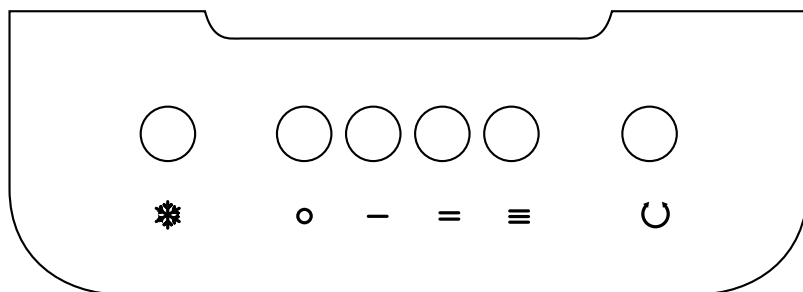

CONTROL PANEL OPERATION POWER ON/OFF BUTTON

Press the () button to turn appliance off/on.

SPEED BUTTON

Press the () -- () -- () button to select low→medium→high speed.

COOL BUTTON

- Press this () button after adding cold water and cooler pack to the tank.
- Cooler pack must be stored in the freezer for at least 4 hours.
- Place the frozen cooler pack in the tank together with the water.
- The two cooler pack can be used simultaneously or consecutively.
- Press this button again to close the change function

WARNING: Cold Air function will not operate when the water level of the water tank is too low or when there is no water. NEVER activate this function without water in the tank.

SWING BUTTON

Press the () button to swing the fan blades left and right. Press button again to stop.

WARNING DO NOT move the appliance during the refrigeration process of the upper cooling fan. Doing so may cause water to enter the electrical components, resulting in damage or malfunction of the appliance and other hazards.

INSTALLATION

INSTALLATION AND USE METHODS

1. Installation diagram of water pump and water pump knob

Then insert the water pump into the corresponding slot of the water tank, as shown in figure 1 below, and pay attention to the direction.

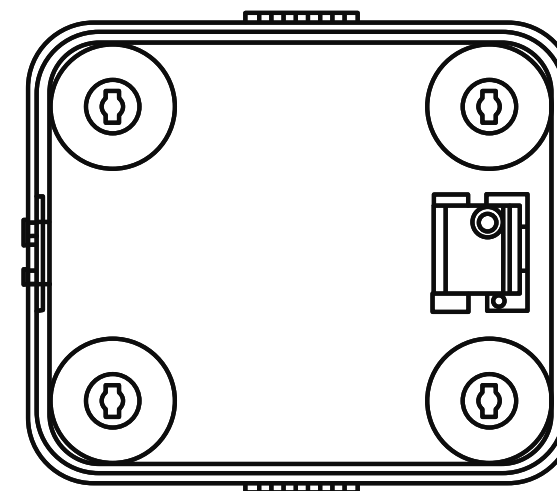

Figure 1

Thank you for purchasing a quality MORGAN appliance. We trust that you will have a pleasant experience with your new product. To guarantee safety and best efficiency, please read this manual carefully and keep a copy for future reference.

IMPORTANT SAFEGUARDS

When using electric appliances, basic safety precautions should always be adhered to, including the following:

- Read all instructions carefully and retain them for future reference.
- Before connecting to the power supply, ensure that the unit is earthed and its voltage corresponds to the voltage indicated on the power supply rating label.
- Inspect the power cord for any signs of damage, and have it replaced by the manufacturer, its service agent or similarly qualified persons in order to avoid a hazard.
- This appliance is not intended for use by persons (including children) with reduced physical, sensory or mental capabilities, or lack of experience and knowledge, unless they have been given supervision or instruction concerning use of the appliance by a person responsible for their safety.
- Keep the appliance away from children.
- Do not place the air inlet or the air outlet near to curtain or walls during operation as these will obstruct air flow, resulting in a fire hazard. The appliance should be placed at minimum distance of 1 meter from the wall or other obstacle.
- Always keep the air inlet and outlet free of obstructions to minimize the risk of fire and malfunction.
- Use a power supply with more than 10A current and do not share the same socket with other appliances.
- **WARNING:** Do not insert fingers or any foreign objects into the appliance during operation to avoid electric shock.
- It is advisable to turn off the appliance's power before removing the power plug from the power supply.
- Do not pull the power plug with wet hands to avoid the risk of electric shock.
- Always remove power plug from the power supply when not in use, before water filling, cleaning or maintenance.
- Ensure appliance is placed on stable surface during operation to avoid toppling over.
- Do not operate the appliance under direct sunlight or near wet areas such as baths, shower or pool.
- Ensure water level is less than "Max." but more than "Min." when operating the cooling (humidifying) function.
- Do not tilt or move the appliance after filling water into the water tank to avoid accidental spillage.
- Never immerse the appliance in water or other liquids.
- In the event of a malfunction, power off the appliance immediately and contact your authorized service center. Do not attempt to repair or replace any parts yourself.

CARE & CLEANING

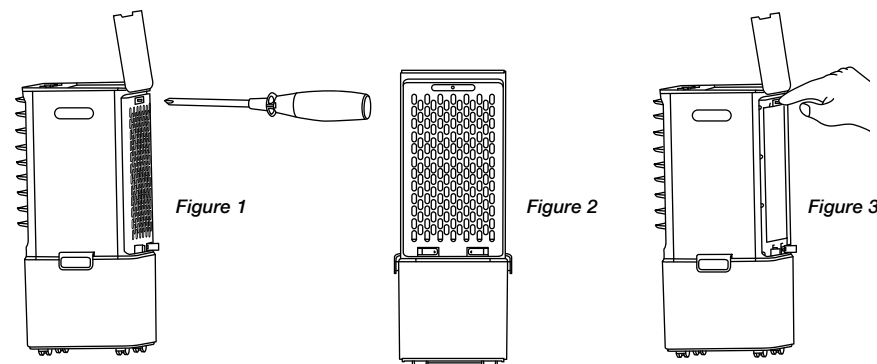

REMOVING THE AIR FILTER AND WATER CURTAIN:

- Use a screwdriver to detach the air inlet fixing screw.
- Slide the filter upwards from the body, remove the buckle and detach the air inlet filter and water curtain.

CLEANING THE AIR FILTER:

- Disconnect power plug from the power supply and pull the air filter holder by hand.
- Clean the air filter using a mild cleanser and soft brush under running water.
- Assemble air filter into its original position.

CLEANING THE WATER CURTAIN:

- Disconnect power plug from the power supply and detach the air filter.
- Remove the water curtain and clean under running water with mild cleanser and soft brush.

- Assemble water curtain into its original position.

Important: Water curtain must be installed correctly to avoid leakage.

CLEANING THE WATER TANK:

- Disconnect power plug from the power supply and detach the water tank.
- Wipe away any limescale in the water tank by using a clean towel and mild cleanser.
- Thoroughly rinse water tank under running water.
- Assemble water curtain into its original position.

CLEANING THE HOUSING:

- Use a mild cleanser and clean, soft cloth to wipe the housing.
- Do not use abrasive detergents or hard brushes to avoid damaging the finishing.
- Important: always disconnect power plug from the power supply before proceeding to clean the air cooler.
- Do not immerse any part of the control panel in water.