

# SMART LIVING

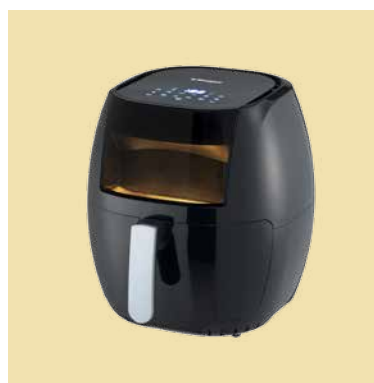

# ELECTRIC OVEN



## ELECTRIC OVEN MEO-GLAMO 150RCSS

- Power: 2800W
- Capacity: 150L
- 8 function selector: OFF, Fermentation, Upper heating, Lower heating, Upper + Lower heating, Upper + Lower heating with Convection, Upper + Lower heating with Rotisserie and Upper + Lower heating with Convection + Rotisserie.
- With defrost function (at top temperature control knob)
- 70°C to 250°C adjustable temperature selector for various cooking functions
- 2pcs "M" shape Stainless steel heating elements
- Independent temperature control. (Top & bottom temperature can be adjusted separately.)
- 120 minutes switch off timer with ring.
- With inner oven lamp
- Accessories: 3pcs enamel baking tray, rotisserie set, rotisserie Basket, wire rack, crumb tray and tray handle

**RM1399(WM) RM1459(EM)**  
RRP: RM1899(WM) RM1959(EM)

## ELECTRIC OVEN MEO-GLAMO 120RC

- Power: 2800W
- Capacity: 120L
- 8 function selector: OFF, Fermentation, Upper heating, Lower heating, Upper + Lower heating, Upper + Lower heating with Convection, Upper + Lower heating with Rotisserie and Upper + Lower heating with Convection + Rotisserie.
- With defrost function (at top temperature control knob)
- 70°C to 250°C adjustable temperature selector for various cooking functions
- 2pcs "M" shape Stainless steel heating elements
- Independent temperature control. (Top & bottom temperature can be adjusted separately.)
- 120 minutes switch off timer with ring.
- With inner oven lamp
- Accessories: Rotisserie set, wire rack, 2pcs enamel baking tray, crumb tray and tray handle.

**RM1139(WM) RM1179(EM)**  
RRP: RM1569(WM) RM1609(EM)



## ELECTRIC OVEN MEO-GLAMO 100RC

- Power: 2800W
- Capacity: 100L
- 8 function selector: OFF, Fermentation, Upper heating, Lower heating, Upper + Lower heating, Upper + Lower heating with Convection, Upper + Lower heating with Rotisserie and Upper + Lower heating with Convection + Rotisserie.
- With defrost function (at top temperature control knob)
- 70°C to 250°C adjustable temperature selector for various cooking functions
- 2pcs "M" shape Stainless steel heating elements
- Independent temperature control. (Top & bottom temperature can be adjusted separately.)
- 120 minutes switch off timer with ring.
- With inner oven lamp
- Accessories: Rotisserie set, wire rack, 2pcs enamel baking tray, crumb tray and tray handle.

**RM899(WM) RM939(EM)**  
RRP: RM1389(WM) RM1429(EM)



## ELECTRIC OVEN MEO-GLAMO 45RC

- Power: 1800W
- Capacity: 45L
- 6 function selectors: OFF, both upper & lower heating with convection, upper heating with convection, both upper & lower heating, upper heating with rotisserie and both upper & lower heating with convection rotisserie.
- 100°C – 250°C adjustable temperature selector for various cooking functions
- Stainless steel heating elements
- With Inner lamp
- 60 minutes timer with bell ring
- Accessories: 2 pcs enamel baking tray, rotisserie set, wire rack, crumb tray and tray handle.

**RM439(WM) RM459(EM)**  
RRP: RM639(WM) RM659(EM)



## ELECTRIC OVEN MEO-GLAMO 23B

- Power: 1380W
- Capacity: 21L
- 4 function selector: OFF, both upper & lower heating, upper heating and lower heating
- 60min Timer With Bell Ring
- Accessories: 2pc Baking tray, wire rack & tray handle
- 100°C-250°C Adjustable Temperature Selector for Various Cooking Functions
- Stainless Steel Heating Element

**RM199(WM) RM209(EM)**  
RRP: RM269(WM) RM279(EM)



# ELECTRIC OVEN

## ELECTRIC OVEN MEO-602RC

- Power: 2200W
- Capacity: 60 Liter
- 6 Function selector
- With rotisserie & convection function
- Perfect for grilling, baking and toasting
- 100°C – 250°C adjustable temperature selector for various cooking functions
- Stainless Steel heating elements
- 60 minutes switch off timer with bell
- With inner lamp
- Accessories: Rotisserie set, 2pcs baking tray, wire rack, ray handle & crumb tray

**RM529(WM) RM559(EM)**  
RRP: RM929(WM) RM959(EM)



## ELECTRIC OVEN MEO-HC26C

- Power: 1500W
- Capacity: 26 Liter
- 6 function selector: OFF, upper heating, lower heating, both upper & lower heating, upper heating with convection and both upper & lower heating with convection
- 100°C-250°C Adjustable Temperature Selector for Various Cooking Functions
- 60min Timer With Bell Ring
- Stainless Steel Heating Element
- With Indicator Light
- Accessories: 1pc Bake Tray, 1pc Wire Rack & Tray Handle

**RM219(WM) RM229(EM)**  
RRP: RM339(WM) RM349(EM)

# FOOD BLENDER



## POWER BLENDER MPB-MAXIMUS 15

- Power rating: 1400W
- Capacity: 2.0L Tritan Jar
- High Speed Blender with 3 Pre-programmed Setting
- With maximum RMP: 32000

**RM579(WM) RM589(EM)**  
RRP: RM779(WM) RM789(EM)



3 Mode Speeds  
(Ice Crushing, Smoothie Blending & Soup Blending)



6 Stainless Steel Blades



Tamper for Even Mixing



2000ml Tritan Blending Jar



## FOOD BLENDER MBL-401WG

- Power rating: 400W
- Capacity: 1.5L
- 2 speeds with pulse function
- With Dry mill grinder
- With safety switch
- With Circuit Breaker Protection

**RM99(WM) RM103(EM)**  
RRP: RM145(WM) RM149(EM)



# STAND MIXER & HAND MIXER



Egg Whisking



Dough Kneading



Batter Mixing



Splash Guard with Convenient Ingredient Inlet



## STAND MIXER MSM-MIXTE 12

- Power rating: 1200W powerful motor
- 5.5L Stainless Steel Bowl
- Stepless speed and pulse function
- Non-slipping rubber feet
- Accessories: Whisk, Beater and Hook

**RM619(WM) RM629(EM)**  
RRP: RM1019(WM) RM1029(EM)



Dough Kneading



Batter Mixing



Egg Beating



Splashguard with Convenient Ingredients Inlet



## STAND MIXER MSM-SB1500

- Power rating: 1500W powerful motor, low noise
- 6.7L brushed stainless steel bowl
- Variable 8 stepless speed and pulse function

**RM1449(WM) RM1459(EM)**  
RRP: RM2029(WM) RM2039(EM)



## STAND MIXER MSM-NC400HM

- Power rating: 400W
- Capacity: 3.5L mixer bowl
- 5 speeds with turbo function

**RM219(WM) RM225(EM)**  
RRP: RM309(WM) RM315(EM)



## STAND MIXER MSM-NC300HM

- Power rating: 300W
- Capacity: 3.4L mixer bowl
- 5 speeds with turbo function
- With automatic rotated bowl

**RM155(WM) RM161(EM)**  
RCP: RM219(WM) RM225(EM)



## HAND MIXER MHM-MIXX 300

- Power rating: 300W
- 6 speeds with Turbo function
- With individual eject button
- Accessories: 2pcs stainless steel beater, 2pcs dough hook and 1pc of whisk
- With accessories storage box

**RM99(WM) RM100(EM)**  
RRP: RM119(WM) RM120(EM)



# RICE COOKER



## COMMERCIAL RICE COOKER MCR-VAST 10

- Power rating: 2800W
- Capacity: 10L
- Large control panel with 1 button easy operation
- Stainless steel large handle lid with holder for hung on the side of the pot
- Removable non-stick inner pot
- With keep warm functions
- With overheat cut-off protection
- Max rice volume: 7.5kgs & min rice volume 2kgs; Max. up to 50 persons

**RM449(WM) RM469(EM)**  
RRP: RM699(WM) RM719(EM)



Convenient Lid Holder



Accessories



## COMMERCIAL RICE COOKER MCR-VAST 7

- Power rating: 2500W
- Capacity: 6.6L
- Large control panel with 1 button easy operation
- Stainless steel large handle lid with holder for hung on the side of the pot
- Removable inner pot with non-stick coating
- With keep warm functions
- With overheat cut-off protection
- Max rice volume: 5kgs & min rice volume 1.6kgs; Max. up to 35 persons

**RM389(WM) RM399(EM)**  
RRP: RM559(WM) RM569(EM)



## RICE COOKER MRC-TC28

- Power rating: 1000W
- Capacity: 2.8L
- Micro switch control
- With steam tray

**RM149(WM) RM155(EM)**  
RRP: RM209(WM) RM215(EM)



## JAR RICE COOKER MRC-2318J

- Power rating: 700W
- Capacity: 1.8L
- Non-stick coated inner pot
- With detachable steam vent
- With steam tray

**RM139(WM) RM145(EM)**  
RRP: RM189(WM) RM195(EM)



## JAR RICE COOKER MRC-2310J

- Power rating: 400W
- Capacity: 1.0L
- Non-stick coated inner pot
- With detachable steam vent
- With steam tray

**RM115(WM) RM116(EM)**  
RRP: RM159(WM) RM160(EM)



## RICE COOKER MRC-TC18

- Power rating: 700W
- Capacity: 1.8L
- Micro switch control
- With steam tray

**RM109(WM) RM115(EM)**  
RRP: RM159(WM) RM165(EM)



## RICE COOKER MRC-TC10

- Power rating: 400W
- Capacity: 1.0L
- Micro switch control
- With steam tray

**RM89(WM) RM90(EM)**  
RRP: RM129(WM) RM130(EM)



## RICE COOKER MRC-TD618NS

- Power rating: 700W
- Capacity: 1.8L
- Stainless steel lid
- Non-stick coated inner pot
- Aluminium steaming basket

**RM119(WM) RM125(EM)**  
RRP: RM169(WM) RM175(EM)



## RICE COOKER MRC-TD610NS

- Power rating: 400W
- Capacity: 1.0L
- Stainless steel lid
- Non-stick coated inner pot
- Aluminium steaming basket

**RM99(WM) RM100(EM)**  
RRP: RM139(WM) RM140(EM)

# FOOD STEAMER

## FOOD STEAMER MFS-MC12L

- Power: 1000W
- Capacity: 12L
- Stainless steel housing
- Convenient refill
- Rice steaming container (1.5L x 1)
- Removable tray for larger steaming compartment
- Stackable for easy storage
- Visible water level
- Overheating protection
- 3 levels structure to cook different foods
- 60 minutes timer
- Cord storage, anti-slip feet

**RM209(WM) RM219(EM)**  
RRP: RM299(WM) RM309(EM)



Stackable for easy Storage Removable Tray for Larger Steaming Compartment 3 levels structure to cook different foods Convenient refill 1.5L Rice steaming container

# MULTI COOKER

## MULTI COOKER MMC-3500

- Power rating: 1000W
- Capacity: 5.0L
- Auto cut-off to prevent overheating
- Ideal for Steamboat, Stir Frying and Deep Frying
- Removable non-stick coated inner pot
- Tempered glass lid

**RM169(WM) RM175(EM)**  
RRP: RM229(WM) RM235(EM)



Easy Stir Fry \*Non-Stick Grill Pan Ideal for Deep Frying \*Stainless Steel Steam Tray for Easy Steaming Ideal for Steamboat with auto cut-off to prevent overheating

## FOOD STEAMER MFS-29 NUTRISTEAM (WH) MFS-29 NUTRISTEAM (BK)

- Power: 1600W
- Capacity: 28L
- Come with double heaters
- Rice steaming container and water refill cup
- Stackable steam tray for easy storage
- Exterior water refill funnel with visible water level indicator
- Anti-dry thermostat protection
- 2 levels structure for convenient cooking
- 60 minutes timer with bell

**RM339(WM) RM349(EM)**  
RRP: RM579(WM) RM589(EM)



Stackable for easy Storage Removable Tray for Larger Steaming Compartment Individual Steaming Compartment Convenient Refill Accessories

## MULTI COOKER MMC-3400A\*

- Power rating: 1300W
- Capacity: 4.0L
- Auto cut-off to prevent overheating
- \*SUS 304\* Stainless steel inner pot
- With grill pan & steam tray

**RM219(WM) RM225(EM)**  
RRP: RM319(WM) RM325(EM)



## MULTI COOKER MMC-3300A

- Power rating: 1000W
- Capacity: 3.0L
- Auto cut-off to prevent overheating
- \*SUS 304\* Stainless steel inner pot
- With grill pan & steam tray

**RM149(WM) RM155(EM)**  
RRP: RM199(WM) RM205(EM)



# AIR FRYER OVEN & AIR FRYER

## AIR FRYER OVEN MAO-VORTEX PRO 22

- Power: 1500W
- Capacity: 22L
- 6 Functions: Air Fry, Broil, Bake, Toast, Convection Grill, Convection Roast.
- 65°C to 230°C Adjustable Temperature Selector for Various Cooking functions.
- 60min Timer With Bell Ring
- Equipped with 6pcs Stainless Steel heating elements and Large turbo convection fan (SAVE UP TO 50% cooking time.)
- Auto shut off safety protection. (When door is open during cooking it will stop operation)
- Oil-free cooking
- Inner oven lamp
- Accessories: Baking Tray, Wire Rack and Air Fry Basket

**RM499(WM) RM509(EM)**  
RRP: RM899(WM) RM909(EM)



BAKE AIR FRY TOAST BROIL GRILL ROAST



## AIR-FRYER MAF-C707

- Power: 1800W
- Capacity: 7.7L
- Temperature control 80°C-200°C
- With timer up to 30 minutes
- Ideal for Roasting, Grilling and Frying without oil
- With non-stick coating pot
- Extra large capacity for various cooking needs
- With rapid air circulation system

**RM369(WM) RM379(EM)**  
RRP: RM679(WM) RM689(EM)



Frying without Oil Ideal for Roasting Ideal For Grilling



## AIR-FRYER MAF-EROS 8

- Power: 1800W
- Capacity: 8.0L
- Temperature control 80°C-200°C
- With timer up to 60 minutes
- Presets control with digital display
- With non-stick coating pot
- Transparent window for easy visual cooking
- With rapid air circulation system
- With sensor touch panel
- Overheat protection

**RM559(WM) RM570(EM)**  
RRP: RM779(WM) RM790(EM)



Frying without Oil Ideal for Roasting Ideal For Grilling



## AIR-FRYER MAF-C607

- Power: 1300W
- Capacity: 2.8L
- Temperature control 80° - 200°C
- With timer up to 60 minutes
- Removable pot with non-stick coating
- With rapid air circulation system
- Overheat protection and handle button cover

**RM339(WM) RM345(EM)**  
RCP: RM449(WM) RM455(EM)



## AIR-FRYER MAF-OPTIMAL 8

- Power: 1200W
- Capacity: 8.0L
- Removable inner pot with non-stick coating
- With rapid air circulation system
- Temperature control 80°C to 210°C
- With timer up to 99 minutes

**RM559(WM) RM570(EM)**  
RRP: RM779(WM) RM790(EM)



Ideal for Roasting Frying without Oil 3D Rotation Cooking LED Display Panel Ideal For Grilling Ideal for Baking Accessories Removable Inner Pot Design

# GAS STOVE

## DOUBLE GAS STOVE

### MGS-8866G

- 130mm x 130mm Black brass burner head
- Glass top for elegant look & easy cleaning
- High efficiency burner head for powerful flame
- Duplicast Iron Trivets
- Stainless Steel Body
- Piezo ignition

**RM329(WM) RM335(EM)**  
RRP: RM439(WM) RM445(EM)



## DOUBLE GAS STOVE

### MGS-8312G

- 120mm x 120mm Black brass burner head
- Glass top for elegant look & easy cleaning
- High efficiency burner head for powerful flame
- Enamel trivet for durability
- Stainless Steel Body
- Piezo ignition

**RM289(WM) RM295(EM)**  
RRP: RM399(WM) RM405(EM)



## DOUBLE GAS STOVE

### MGS-7313S

- 130mm x 130mm stainless steel burner head
- Stainless steel top
- Double pipe
- Double 8 jets burner
- Piezo ignition

**RM169(WM) RM175(EM)**  
RRP: RM229(WM) RM235(EM)



## DOUBLE GAS STOVE

### MGS-7212S

- 120mm x 120mm stainless steel burner head
- Stainless steel top
- Double pipe
- Enamel trivet for durability
- Piezo ignition

**RM149(WM) RM155(EM)**  
RRP: RM199(WM) RM205(EM)



## DOUBLE GAS STOVE

### MGS-9313CD

- 130mm x 130mm Copper Brass Burner Head
- 100% Stainless Steel Body
- Duplicast Iron Trivets for Durability
- Elegant Design & Easy Cleaning
- Double Pipe
- Piezo ignition

**RM289(WM) RM295(EM)**  
RRP: RM399(WM) RM405(EM)



## DOUBLE GAS STOVE

### MGS-5515

- 130mm x 150mm Iron burner head
- 100% Stainless steel body
- Elegant design
- High efficiency burner head for powerful flame
- Piezo ignition

**RM289(WM) RM295(EM)**  
RRP: RM389(WM) RM395(EM)

## DOUBLE GAS STOVE

### MGS-SC9516CD

- 135mm x 135mm Copper Burner Head
- 100% Stainless Steel Body
- Elegant Design
- High Efficiency Burner Head for Powerful Flame
- Duplicast Iron Trivets
- Double Pipe
- Piezo ignition

**RM299(WM) RM305(EM)**  
RRP: RM429(WM) RM435(EM)



# JUG KETTLE & ELECTRIC KETTLE

## DOUBLE WALL JUG KETTLE

### MJK-DW8218

- Rated wattage: 1850W
- Capacity: 1.8L
- SUS304 Stainless Steel Seamless Inner Pot For Easy Cleaning
- Colour Steel Cool Touch Exterior
- Automatic Shut-off and Boil-dry Protection
- ON/OFF Switch
- 360° Rotating Base

**RM159(WM) RM160(EM)**  
RRP: RM229(WM) RM230(EM)



Seamless SUS304 Stainless Steel Inner Pot



ON/OFF Switch with Indicator Light



## JUG KETTLE

### MJK-927

- Rated wattage: 1850-2200W
- Capacity: 1.7L
- Removable Filter For Easy Cleaning
- Stainless Steel Heating Element
- Automatic Shut-off and Boil-dry Protection
- ON/OFF Switch with Light Indicator
- With Large Water Gauge for Easy Viewing

**RM39(WM) RM40(EM)**  
RRP: RM69(WM) RM70(EM)



## JUG KETTLE

### MJK-917

- Rated wattage: 1850-2200W
- Capacity: 1.7L
- Removable Filter For Easy Cleaning
- Stainless Steel Heating Element
- ON/OFF Switch with Light Indicator

**RM39(WM) RM40(EM)**  
RRP: RM69(WM) RM70(EM)



## ELECTRIC KETTLE

### MEK-4802SSCL

- Power rating: 1850W – 2200W
- Capacity: 4.8 Liter
- Foldable Handle
- SUS304 Stainless Steel Seamless Inner Pot
- Concealed Heating Element
- Cordless 360° Rotational Base with Safety Boil Dry Protection

**RM179(WM) RM180(EM)**  
RRP: RM239(WM) RM240(EM)



## JUG KETTLE

### MJK-8017LS

- Power rating: 1850W – 2200W
- Capacity: 1.7 Liter
- Swivel base cordless
- SUS304 Stainless Steel Seamless Inner Pot
- Concealed Heating Element
- Removable Filter For Easy Cleaning

**RM139(WM) RM140(EM)**  
RRP: RM219(WM) RM220(EM)



## JUG KETTLE

### MJK-1017L

- Power rating: 1850W – 2200W
- Capacity: 1.7 Liter
- Swivel base cordless
- Concealed Heating Element

**RM89(WM) RM90(EM)**  
RRP: RM129(WM) RM130(EM)



## JUG KETTLE

### MJK-1010L

- Power rating: 1000W – 1200W
- Capacity: 1.0 Liter
- Swivel base cordless
- Concealed Heating Element

**RM79(WM) RM80(EM)**  
RRP: RM109(WM) RM110(EM)

# CHILLER SHOWCASE



## CHILLER SHOWCASE

### MCS-298

- Rated wattage: 240W
- Capacity: 250L
- Frost Free
- Double tempered Glass Door
- With Key Lock
- Inner dimension(mm): 450W x 360D x 1320H
- Product dimension(mm): 545W x 580D x 1725H
- Temperature: 0°C to 10°C
- Self-evaporation water tray
- Each shelf is able to hold up to 20kgs

**RM2199(WM) RM2319(EM)**  
RRP: RM3569(WM) RM3689(EM)

## CHILLER SHOWCASE

### MCS-338

- Rated wattage: 250W
- Capacity: 288L
- Frost Free
- Inner dimension(mm): 489W x 481D x 1176H
- Product dimension(mm): 578W x 605D x 1824H
- Temperature: 0°C to 10°C
- Each shelf is able to hold up to 36kgs

**RM2799(WM) RM2939(EM)**  
RRP: RM4299(WM) RM4439(EM)



## CHILLER SHOWCASE

### MCS-198

- Rated wattage: 230W
- Capacity: 170L
- Frost Free
- Double tempered Glass Door
- With Key Lock
- Inner dimension(mm): 450W x 360D x 960H
- Product dimension(mm): 545W x 580D x 1342H
- Temperature: 0°C to 10°C
- Self-evaporation water tray
- Each shelf is able to hold up to 20kgs

**RM1699(WM) RM1789(EM)**  
RRP: RM2789(WM) RM2879(EM)



## CHILLER SHOWCASE

### MCS-488

- Rated wattage: 330W
- Capacity: 430L
- Frost Free
- Inner dimension(mm): 523W x 510D x 1565H
- Product dimension(mm): 606W x 665D x 2000H
- Temperature: 0°C to 10°C
- Each shelf is able to hold up to 36kgs

**RM3399(WM) RM3579(EM)**  
RRP: RM5099(WM) RM5279(EM)



# THERMO POT



## THERMO POT

### MTP-TC160L

- Power rating: 750W
- Capacity: 6.0L
- SUS304 Stainless steel inner pot
- 360° Swivel base
- Two-way Dispenser (Button/Cup)
- With auto reboil & keep warm function

**RM175(WM) RM181(EM)**  
RCP: RM269(WM) RM275(EM)



## THERMO POT

### MTP-350TS

- Power rating: 750-892W
- Capacity: 5L
- 'SUS 304' stainless steel interior pot
- Screwless design lid
- Stainless steel steam venting hole
- Unique base designed inner pot

**RM195(WM) RM201(EM)**  
RCP: RM289(WM) RM295(EM)



## THERMO POT

### MTP-266TSS

- Power rating: 750-892W
- Capacity: 6.0L
- SUS304 Stainless steel inner pot
- With safety lock function
- 5 Temperature control: 90°C, 80°C, 60°C, 40°C and Auto Cool
- Stainless steel steam vent
- Screwless design lid
- Unique base designed inner pot

**RM215(WM) RM221(EM)**  
RRP: RM329(WM) RM335(EM)

# FOOD DEHYDRATOR

## FOOD DEHYDRATOR MFD-A9

- Power rating: 420W – 500W
- Adjustable trays' height for different size of fruits
- Safety overheating protection
- Adjustable temperature for different foods
- Built-in ventilator for freshness & nutrition
- Dishwasher-safe trays & cover
- 5-interchangeable trays
- Ideal for DIY healthy & Natural snacks

**RM229(WM) RM239(EM)**  
RRP: RM309(WM) RM319(EM)



Excellent for dried vegetables



Perfect for dried fruits



Superb for dried flowers



Great for dried meats



# INDUCTION & CERAMIC COOKER

## INDUCTION COOKER MIC-2520

- Power rating: 2000W
- 8 cooking functions selection: Hot pot, Fry, Stir fry, BBQ, Soup, Rice, Milk and Water.
- LED Screen Display
- Over-heat Protection System

**RM169(WM) RM175(EM)**  
RRP: RM319(WM) RM325(EM)



## CERAMIC COOKER MCC-2002

- Power rating: 2000W
- With stainless steel grill plate

**RM249(WM) RM250(EM)**  
RRP: RM379(WM) RM380(EM)



Ideal for Stainless Steel Grill Plate or Pot



Ideal for Glassware



Ideal for Clay Pots



# MINI BAR & WATER DISPENSER

## MINI BAR MMB-NB62LSL

- Capacity: 50L
- CFC Free
- Adjustable thermostat
- Product Dimension(mm): 475L x 450D x 487H

**RM529(WM) RM549(EM)**  
RRP: RM859(WM) RM879(EM)



## WATER DISPENSER MWD-BA80L

- Power rating: 680W
- Capacity: 8.0L
- Stainless steel inner pot
- Separate boiler design to avoid mixing tap & boiled water
- Boil-dry protection

**RM319(WM) RM329(EM)**  
RRP: RM429(WM) RM439(EM)

# CHEST FREEZER

## CHEST FREEZER MCF-7307L

- Product Dimension(mm): 2030L x 725D x 910H
- Capacity: 700L
- CFC Free
- 2 Doors
- Durable Epoxy Inner
- Fridge or Freezer Adjustable thermostat
- Fridge Temperature: 2°C to 10°C
- Freezer Temperature: -10°C to -20°C

**RM2959(WM) RM3269(EM)**  
RRP: RM5999(WM) RM6309(EM)

## CHEST FREEZER MCF-6307L

- Product Dimension(mm): 1800L x 760D x 827H
- Capacity: 600L
- CFC Free
- 2 Doors
- Durable Epoxy Inner
- Fridge or Freezer Adjustable thermostat
- Fridge Temperature: 5°C to -3°C
- Freezer Temperature: -8°C to -24°C

**RM2309(WM) RM2549(EM)**  
RRP: RM5029(WM) RM5269(EM)

## CHEST FREEZER MCF-5507L

- Product Dimension(mm): 1600L x 765D x 826H
- Capacity: 520L
- CFC Free
- 2 Doors
- Durable Epoxy Inner
- Fridge or Freezer Adjustable thermostat
- Fridge Temperature: 5°C to -3°C
- Freezer Temperature: -8°C to -24°C

**RM2259(WM) RM2479(EM)**  
RRP: RM4399(WM) RM4619(EM)

## CHEST FREEZER MCF-4507L

- Product Dimension(mm): 1440L x 680D x 826H
- Capacity: 423L
- CFC Free
- Durable Epoxy Inner
- Fridge or Freezer Adjustable thermostat
- Fridge Temperature: 5°C to -3°C
- Freezer Temperature: -8°C to -24°C

**RM1789(WM) RM1959(EM)**  
RRP: RM3609(WM) RM3779(EM)

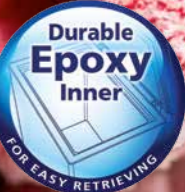

## CHEST FREEZER MCF-3507L

- Product Dimension(mm): 1100L x 680D x 826H
- Capacity: 303L
- CFC Free
- Durable Epoxy Inner
- Fridge or Freezer Adjustable thermostat
- Fridge Temperature: 5°C to -3°C
- Freezer Temperature: -8°C to -24°C

**RM1349(WM) RM1479(EM)**  
RRP: RM2929(WM) RM3059(EM)

## CHEST FREEZER MCF-3007L

- Product Dimension(mm): 950L x 680D x 826H
- Capacity: 253L
- CFC Free
- Durable Epoxy Inner
- Fridge or Freezer Adjustable thermostat
- Fridge Temperature: 5°C to -3°C
- Freezer Temperature: -8°C to -24°C

**RM1349(WM) RM1469(EM)**  
RRP: RM2829(WM) RM2949(EM)

## CHEST FREEZER MCF-1178L

- Product Dimension(mm): 580L x 520D x 830H
- Capacity: 116L
- CFC Free
- Durable Epoxy Inner
- Fridge or Freezer Adjustable thermostat
- Fridge Temperature: 5°C to -3°C
- Freezer Temperature: -8°C to -24°C

**RM839(WM) RM899(EM)**  
RRP: RM1669(WM) RM1729(EM)

## CHEST FREEZER MCF-0958L

- Product Dimension(mm): 530L x 440D x 830H
- Capacity: 80L
- CFC Free
- Durable Epoxy Inner
- Fridge or Freezer Adjustable thermostat
- Fridge Temperature: 5°C to -3°C
- Freezer Temperature: -1°C to -20°C

**RM759(WM) RM799(EM)**  
RRP: RM1459(WM) RM1499(EM)

## CHEST FREEZER MCF-0658L

- Product Dimension(mm): 532L x 455D x 588H
- Capacity: 60L
- CFC Free
- Durable Epoxy Inner
- Fridge or Freezer Adjustable thermostat
- Fridge Temperature: 0°C to 10°C
- Freezer Temperature: -1°C to -20°C

**RM719(WM) RM749(EM)**  
RRP: RM1279(WM) RM1309(EM)



## CHEST FREEZER MCF-EVEREST 10

- Product Dimension(mm): 590L x 545D x 845H
- Capacity: 105L
- CFC Free
- Durable Epoxy Inner
- Coated Wire Basket
- Fridge or Freezer Adjustable thermostat
- Fridge Temperature: 2°C to 8°C
- Freezer Temperature: -10°C to -24°C

**RM909(WM) RM969(EM)**  
RRP: RM1669(WM) RM1729(EM)



## CHEST FREEZER MCF-EVEREST 15

- Product Dimension(mm): 705L x 596D x 840H
- Capacity: 150L
- CFC Free
- Durable Epoxy Inner
- Coated Wire Basket
- Fridge or Freezer Adjustable thermostat
- Fridge Temperature: 2°C to 8°C
- Freezer Temperature: -10°C to -24°C

**RM1129(WM) RM1199(EM)**  
RRP: RM2239(WM) RM2309(EM)

## CHEST FREEZER MCF-EVEREST 20

- Product Dimension(mm): 906L x 600D x 836H
- Capacity: 205L
- CFC Free
- Durable Epoxy Inner
- Coated Wire Basket
- Fridge or Freezer Adjustable thermostat
- Fridge Temperature: 2°C to 8°C
- Freezer Temperature: -10°C to -24°C

**RM1249(WM) RM1339(EM)**  
RRP: RM2629(WM) RM2719(EM)

# GLASS DOOR FREEZER



**GLASS DOOR CHEST FREEZER  
MCF-G456L**

- Product Dimension(mm): 1434L x 651D x 800H
- Capacity: 456L
  - CFC Free
  - Epoxy Inner
  - With Key Lock
  - High Energy Efficiency Compressor
  - Fridge or Freezer Adjustable Thermostat
  - With 2 Baskets
  - Fridge Temperature: 0°C to 10°C
  - Freezer Temperature: -1°C to -18°C

**RM2519(WM) RM2689(EM)**  
RRP: RM4029(WM) RM4199(EM)

**GLASS DOOR CHEST FREEZER  
MCF-G336L**

- Product Dimension(mm): 1034L x 651D x 800H
- Capacity: 336L
  - CFC Free
  - Epoxy Inner
  - With Key Lock
  - High Energy Efficiency Compressor
  - Fridge or Freezer Adjustable Thermostat
  - With 2 Baskets
  - Fridge Temperature: 0°C to 10°C
  - Freezer Temperature: -1°C to -18°C

**RM2189(WM) RM2309(EM)**  
RRP: RM3459(WM) RM3579(EM)



# UPRIGHT FREEZER



**UPRIGHT FREEZER  
MUF-DC168**

- Rated wattage: 130W
- Capacity: 163L
- CFC Free / Direct Cool
- Easy to clean
- Adjustable thermostat
- Mechanical temperature control
- High energy efficiency compressor
- Freezer temperature: -14°C~-24°C
- With 6 freezer compartment drawers
- Compressor: 5 Years warranty

**RM1499(WM) RM1599(EM)**  
RRP: RM2659(WM) RM2759(EM)



**UPRIGHT FREEZER  
MUF-1280L**

- Rated wattage: 210W
- Capacity: 285L
- CFC Free / Frost Free
- Deep and Quick Freezing
- High energy efficiency compressor
- Easy to clean
- Adjustable thermostat
- With 7 freezer compartments
- With Key lock
- Freezer Temperature: 0°C ~ -18°C
- Compressor: 5 Years Warranty

**RM2599(WM) RM2739(EM)**  
RRP: RM4309(WM) RM4449(EM)



**UPRIGHT FREEZER  
MUF-DC88**

- Rated wattage: 130W
- Capacity: 85L
- CFC Free / Direct Cool
- Easy to clean
- Adjustable thermostat
- Mechanical temperature control
- High energy efficiency compressor
- Freezer temperature: -14°C~-24°C
- With 4 freezer compartment drawers
- Compressor: 5 Years warranty

**RM1199(WM) RM1249(EM)**  
RRP: RM1719(WM) RM1769(EM)



# CUPCAKE MAKER & SANDWICH MAKER



**CUPCAKE MAKER  
MDM-B382**

- Power rating: 1200W
- Fixed cupcake plate (top & bottom)
- Non-stick coated plate for easy cleaning
- Automatic temperature control
- Horizontal & Vertical for compact storage and space saving
- With power and ready indicator light
- Anti-slip feet design
- Cool touch handle

**RM99(WM) RM100(EM)**  
RRP: RM139(WM) RM140(EM)



Non-stick Coated Plate



**SANDWICH MAKER  
MSM-SC150NS**

- Power rating: 750W
- 2-Slice sandwich toasting plate
- Non-stick coated plate for easy cleaning
- Automatic temperature control
- High temperature for a perfectly toasted
- Horizontal & Vertical storage for space-saving
- Anti-slip feet design
- With power and ready indicator light
- Cool touch handle

**RM89(WM) RM90(EM)**  
RRP: RM109(WM) RM110(EM)



Non-stick Coated Plate



**SANDWICH MAKER  
MSM-SC140NS**

- Power rating: 700W
- 2-Slice sandwich toasting plate
- Non-stick coated plate for easy cleaning
- Automatic temperature control
- Horizontal & Vertical storage for space-saving
- Anti-slip feet design
- With power and ready indicator light
- With buckle
- Cord storage

**RM69(WM) RM70(EM)**  
RRP: RM99(WM) RM100(EM)



Non-stick Coated Plate

# JUICE EXTRACTOR & TOASTER



**JUICE EXTRACTOR  
MJE-SC160W**

- Power rating: 600W
- 65mm diameter of feeding tube for whole apple
- 1.5L pulp container & 550ml juice cup
- Stainless steel housing
- Two speed control section

**RM199(WM) RM200(EM)**  
RRP: RM249(WM) RM250(EM)



**JUICE EXTRACTOR  
MJE-AA05W**

- Power rating: 250W
- Large feeding tube
- High juice extracting rate
- Stainless steel filter

**RM109(WM) RM110(EM)**  
RRP: RM139(WM) RM140(EM)



**TOASTER  
MTS-22A**

- Power rating: 750W
- Auto bread centralizing feature
- Wider slot for thicker breads
- With dust cover
- With defrost, reheat, cancel functions & 7 levels of browning control.
- With crumb tray

**RM75(WM) RM76(EM)**  
RRP: RM99(WM) RM100(EM)



# PAN GRILL



**PAN GRILL  
MPG-DA898NS**

- Power rating: 1500-1800W
- Dual temperature control
- Oil free cooking for healthier meals

**RM269(WM) RM275(EM)**  
RRP: RM379(WM) RM385(EM)



**PAN GRILL  
MPG-2898**

- Power rating: 1300W
- Detachable non-stick heating plate
- Oil free cooking for healthier meals

**RM199(WM) RM205(EM)**  
RRP: RM269(WM) RM275(EM)

# PORTABLE AIR COND



## PORTABLE AIR-COND MAC-121 SIERRA

- Cooling capacity: 12000btu/hr (3500W)
- Suitable for room size up to 25-30m<sup>2</sup>
- Auto Up/Down Swing Louvers
- Automatic Evaporative System
- 3-in-1 Function of Cooling, Dehumidifying and Fan
- With LOW/MID/HIGH Fan Speeds
- 24 hour ON/OFF Timer
- With Remote Control

**RM1699(WM) RM1729(EM)**  
RRP: RM3029(WM) RM3059(EM)



## PORTABLE AIR-COND MAC-091 Feather Lite

- Cooling capacity: 9000btu/hr (2.61kw)
- Suitable for room size up to 14m<sup>2</sup>
- Washable filters
- Self-Evaporative system & drain outlet design
- 4 Modes – Cool, Fan, Dehumidifying & Sleep
- High & Low Fan Speeds
- 24 Hour ON/OFF Timer

**RM1199(WM) RM1219(EM)**  
RRP: RM2209(WM) RM2229(EM)



## PORTABLE AIR-COND MAC-093 Lite

- Cooling capacity: 9000btu/hr (2.61kw)
- Suitable for room size up to 14-20m<sup>2</sup>
- Washable filters
- Auto left & right swing louvers
- Automatic Evaporative system
- 3 in 1 function of Cooling/Dehumidifying/Fan
- High & Low Fan Speeds
- 24 Hour ON/OFF Timer
- With Remote Control

**RM1199(WM) RM1219(EM)**  
RRP: RM2209(WM) RM2229(EM)

# AIR COOLER



Honeycomb Filter



Large Water Tank



2 Cooler Packs



Touch Control LED Display



**New**

## TOWER AIR COOLER MAC-COOL T1

- Power: 85W
- Water tank capacity: 6L
- Durable Honeycomb Filter for Max Cooling with Dust Proof Cover
- With Cool Function
- 3 Wind Mode (Normal / Natural / Sleep)
- LED Display with Touch Control
- 3 Speed Selection (L/M/H)
- With Left/Right Auto Swing Louver
- 2 Cooler Packs
- Timer Setting Function up to 12 Hours
- With Low Water Level Sense Function
- With Remote Control
- With Caster for Easy Moving

**RM669(WM) RM699(EM)**  
RRP: RM989(WM) RM1019(EM)



## AIR COOLER MAC-AMPLEFLOW 18

- Power: 600W
- Large water tank capacity: 120L
- Air flow: 16,000m<sup>3</sup>/hr
- Suitable for room size up to 90m<sup>2</sup>
- 3-Sided Durable honeycomb filter for Max Cooling with dust proof cover

**RM2009(WM) RM2159(EM)**  
RRP: RM2889(WM) RM3039(EM)



## AIR COOLER MAC-COOL10A

- Power: 220W
- Water tank capacity: 60L
- Air flow: 2800m<sup>3</sup>/hr
- Suitable for room size up to 80m<sup>2</sup>

**RM1099(WM) RM1179(EM)**  
RRP: RM1669(WM) RM1749(EM)

# CIRCULATION FAN



## CIRCULATION FAN MFQ-SC61M

- Power: 60W
- Fan size: Ø265mm
- Fan blades size: Ø228mm
- Mechanical control
- Easy detachable front net cover for cleaning
- 4 setting speeds
- Left and right auto-oscillation angle up to 65°
- Up and down auto-oscillation angle up to 85°

**RM289(WM) RM295(EM)**  
RRP: RM339(WM) RM345(EM)



## CIRCULATION FAN MFQ-D3RC

- Power: 105W
- Fan Blades: Ø8"
- Three Independent fan with 3 speed control.
- Adjustable tilt position.
- Auto Oscillation for left and right.
- Manual Oscillation for up and down.
- Timer setting up to 7 hours
- With remote control
- Easy dismantle for cleaning

**RM439(WM) RM459(EM)**  
RRP: RM619(WM) RM639(EM)



## CIRCULATION FAN MFQ-SB35W (PK) BREEZER MFQ-SB35W (BL) BREEZER

- Power: 35W
- Fan Blades: Ø8"
- 3 Speeds Hi / Mid. / Low
- Manual Oscillation up and down
- Adjustable tilt position.
- Easy dismantle for cleaning

**RM95(WM) RM96(EM)**  
RRP: RM139(WM) RM140(EM)

## CARE & CLEANING

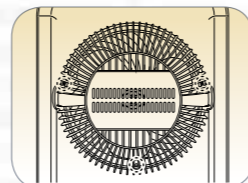

Remove the power plug from the power supply before disassembling the fan for cleaning. Remove the three screws from the back cover.

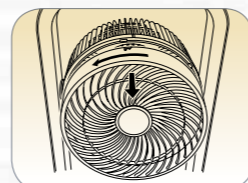

Twist the front cover to the left to detach it.

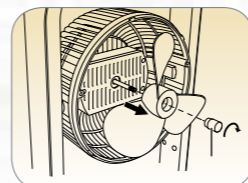

Twist the fan blade screw to the right and detach the fan blade. Proceed to clean the fan blade.



## AIR COOLER MAC-COOL7

- Power: 90W
- Large water tank capacity: 35L
- Air flow: 3000m<sup>3</sup>/hr
- Suitable for room size up to 20-30m<sup>2</sup>
- 3-Sided Durable honeycomb filter for Max Cooling with dust proof cover
- LED Display With touch Control
- Timer Setting Function Up to 12 Hours
- 2 Cooler Packs

**RM739(WM) RM769(EM)**  
RRP: RM1079(WM) RM1109(EM)



## AIR COOLER MAC-COOL3

- Power: 100W
- Water tank capacity: 10L
- Air flow: 1600m<sup>3</sup>/hr
- Suitable for room size up to 25m<sup>2</sup>
- With Ionizer
- 2 Cooler Packs

**RM629(WM) RM649(EM)**  
RRP: RM929(WM) RM949(EM)



## AIR COOLER MAC-CX12

- Power: 65W
- Large water tank capacity: 12L
- Air flow: 1150m<sup>3</sup>/hr
- Suitable for room size up to 20m<sup>2</sup>
- Durable Honeycomb Filter with Dust Proof Cover
- 4 Cooler Packs

**RM339(WM) RM349(EM)**  
RRP: RM499(WM) RM509(EM)





# TABLE & WALL FAN



**TABLE FAN**  
**MTF-16T1**

- Power rating: 55W
- Powerful air flow with 16" AS fan blade
- Thermal safety fuse
- High Quality & Durable Motor
- Smooth Oscillation
- 3 Speed Mode

**RM105(WM) RM111(EM)**  
RRP: RM179(WM) RM185(EM)



**TABLE FAN**  
**MTF-12T1**

- Power rating: 45W
- Powerful air flow with 12" AS fan blade
- Thermal safety fuse
- High Quality & Durable Motor
- Smooth Oscillation
- 3 Speed Mode

**RM95(WM) RM101(EM)**  
RRP: RM149(WM) RM155(EM)



**WALL FAN**  
**MWF-NC168MS**

- Power rating: 45W
- Thermal safety fuse
- High Quality & Durable Motor
- Smooth Oscillation
- 3 Speed Mode

**RM179(WM) RM189(EM)**  
RRP: RM239(WM) RM249(EM)



# CEILING FAN



**CEILING FAN**  
**MFC-EURUS 360 BK**

- Power: 80W
- Blade Size: 60 inch
- Durable 100% copper wire motor
- Built-in Safty Thermal Fuse
- Built-in Safty Wire with Locks for Extra Protection
- Corrosion Resistant Fan Blade
- 5 Speeds Control Regulator

**RM179(WM) RM183(EM)**  
RRP: RM205(WM) RM209(EM)



# SEMI AUTO WASHING MACHINE



**SEMI AUTO WASHING MACHINE**  
**MWM-1312SA**

- Washing Capacity: 12.0Kg
- Spinning Capacity: 6.5Kg
- Washing power: 420W
- Spinning power: 180W
- Anti-rat Base Design
- With Lint Filter

**RM699(WM) RM799(EM)**  
RRP: RM1239(WM) RM1339(EM)



**SEMI AUTO WASHING MACHINE**  
**MWM-1370SA**

- Washing Capacity: 7.0Kg
- Spinning Capacity: 5.0Kg
- Washing power: 350W
- Spinning power: 160W
- Anti-rat Base Design
- With Lint Filter

**RM469(WM) RM519(EM)**  
RRP: RM879(WM) RM929(EM)

**SEMI AUTO WASHING MACHINE**  
**MWM-1310SA**

- Washing Capacity: 10.0Kg
- Spinning Capacity: 6.5Kg
- Washing power: 380W
- Spinning power: 180W
- Anti-rat Base Design
- With Lint Filter

**RM609(WM) RM689(EM)**  
RRP: RM1069(WM) RM1149(EM)



# FULL AUTO WASHING MACHINE



**FULLY AUTO WASHING MACHINE**  
**MWM-11 SAPPHERE**

- Washing Capacity: 11.0Kg
- Spinning Capacity: 11.0Kg
- Hot Air Dry Capacity: 3.0Kg
- Washing power: 410W
- Spinning power: 330W
- Drying power: 500W
- Stainless Steel Drum
- With Hot Air Dry function
- Magic Cleaning Filter
- Tempered Glass Transparent Lid
- With delay wash function
- Child Lock
- Fuzzy Control function
- Anti-Rat Base Design
- Powerful & Durable Motor for Efficient Washing
- With 8 program selection

**RM1790(WM) RM1871(EM)**  
RRP: RM2479(WM) RM2560(EM)



**FULLY AUTO WASHING MACHINE**  
**MWM-9 TOPAZ**

- Washing Capacity: 9.0Kg
- Spinning Capacity: 9.0Kg
- Washing power: 410W
- Spinning power: 330W
- Stainless Steel Drum
- Magic Cleaning Filter
- Transparent Lid
- With Memory Back Up Function
- Fuzzy Control Function
- With Detergent Drawer Compartment
- Anti-Rat Base Design
- Powerful & Durable Motor for Efficient Washing
- With 8 program selection

**RM1290(WM) RM1371(EM)**  
RRP: RM1809(WM) RM1890(EM)

**FULLY AUTO WASHING MACHINE**  
**MWM-13 AQUAMARINE**

- Washing Capacity: 13.0Kg
- Spinning Capacity: 13.0Kg
- Washing power: 410W
- Spinning power: 330W
- Stainless Steel Drum
- Magic Cleaning Filter
- Tempered Glass Transparent Lid
- With delay wash function
- Child Lock
- With Detergent drawer Compartment
- Fuzzy Control function
- Anti-Rat Base Design
- Powerful & Durable Motor for Efficient Washing
- With 9 program selection

**RM1790(WM) RM1871(EM)**  
RRP: RM2479(WM) RM2560(EM)



**FULLY AUTO WASHING MACHINE**  
**MWM-7 ZIRCON**

- Washing Capacity: 7.0Kg
- Spinning Capacity: 7.0Kg
- Washing power: 325W
- Spinning power: 250W
- Stainless Steel Drum
- Magic Cleaning Filter
- Foldable transparent lid
- Anti-Rat Base Design
- With Memory Back Up Function
- Powerful & Durable Motor for Efficient Washing
- With 8 program selection

**RM929(WM) RM990(EM)**  
RRP: RM1329(WM) RM1390(EM)



# GARMENT STEAMER & STEAM GENERATOR



- Anti-Scale
- Max. Steam Rate 100g/min
- 5 BAR
- Lock & Carry



Powerful Steam



Lock & Carry



With Calc Clean Function



Large Removable Water Tank for Easy Refilling



Non-stick Ceramic Soleplate



Stainless Steel Steam Panel with Powerful Steam



Rotatable & Collapsible Hanger

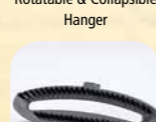

Fabric Brush

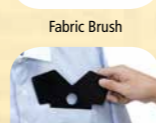

Little Helper – for Easy Ironing



Accessories

## GARMENT STEAMER

### MSI-GB206

- Power: 1350-1650W
- Stainless Steel Steam Panel
- Powerful Steam
- Translucent 2.0L water tank
- Steam rate 32g/min

RM249(WM) RM259(EM)  
RRP: RM349(WM) RM359(EM)



## STEAM GENERATOR

### MSG-27MAXIcare

- Power: 2000-2400W
- 5 bar Steam pressure
- 1.5L Removable water tank
- Steam rate max 100g/min, ECO steam 60g/min
- With cord winder
- Adjustable steam rate and temperature
- Anti-slip iron rest
- No water alarm
- Water tank refill indicator

RM529(WM) RM535(EM)  
RRP: RM799(WM) RM805(EM)



# VENTILATION FAN

## VENTILATION FAN

### MVF-CA12XS

- Power rating: 30W
- Ceiling Mounted Type
- For Shop, Office Room, Living Room & Kitchen
- Elegant Design
- Energy Efficient
- Fan size: 120mm

RM119(WM) RM120(EM)  
RRP: RM169(WM) RM170(EM)



## VENTILATION FAN

### MVF-CB12XW

- Power rating: 30W
- Ceiling Mounted Type
- For Shop, Office Room, Living Room & Kitchen
- Elegant Design
- Energy Efficient
- Fan size: 120mm

RM109(WM) RM110(EM)  
RRP: RM159(WM) RM160(EM)



## VENTILATION FAN

### MVF-WA80

- Power rating: 30W
- Wall Mounted Type
- For Shop, Office Room, Living Room & Kitchen
- Energy Efficient
- Powerful Motor
- Fan size: 200mm

RM89(WM) RM90(EM)  
RRP: RM119(WM) RM120(EM)



## VENTILATION FAN

### MVF-WA100

- Power rating: 35W
- Wall Mounted Type
- For Shop, Office Room, Living Room & Kitchen
- Energy Efficient
- Powerful Motor
- Fan size: 250mm

RM99(WM) RM100(EM)  
RRP: RM139(WM) RM140(EM)

## VENTILATION FAN

### MVF-WA120

- Power rating: 45W
- Wall Mounted Type
- For Shop, Office Room, Living Room & Kitchen
- Elegant Design
- Powerful Motor
- Fan size: 300mm

RM109(WM) RM115(EM)  
RRP: RM159(WM) RM165(EM)

# VACUUM CLEANER



Detachable & Washable Filter



Motorized dust mite brush.



Power Brush with 180° Swivels sideways and 90° up and down



Crevice Tool Clean Hard To Reach Places



Ellipse Brush Easily Remove Dirt



Detachable and Rechargeable Lithium Battery



Accessories

Convenient and hygienic dust bucket emptying

Convenient and hygienic dust bucket emptying

Convenient and hygienic dust bucket emptying

Convenient and hygienic dust bucket emptying

Convenient and hygienic dust bucket emptying

Convenient and hygienic dust bucket emptying

Convenient and hygienic dust bucket emptying

Convenient and hygienic dust bucket emptying

Convenient and hygienic dust bucket emptying

Convenient and hygienic dust bucket emptying

Convenient and hygienic dust bucket emptying

Convenient and hygienic dust bucket emptying

Convenient and hygienic dust bucket emptying

Convenient and hygienic dust bucket emptying

Convenient and hygienic dust bucket emptying

Convenient and hygienic dust bucket emptying

Convenient and hygienic dust bucket emptying

Convenient and hygienic dust bucket emptying

Convenient and hygienic dust bucket emptying

Convenient and hygienic dust bucket emptying

## CORDLESS 3 in 1 STICK / HANDHELD VACUUM CLEANER

### MVC-CHS180DB

- Power rating: 180W
- Dust capacity: 0.8L
- Convertible stick / handheld vacuum cleaner
- ≥12,000 PA
- Detachable and rechargeable 2500 mAh Lithium-Ion Battery.
- Full size LED Multi-tasker Power Brush with 180° Swivels sideways for convenient handling in corners and around obstacles.
- Operating time: 38 minutes (long lasting mode), 18 minutes (power suction mode)
- Bagless dust container with cyclone stainless steel mesh and washable HEPA filter
- Convenient and hygienic dust bucket emptying.
- Two speed control for effective and thorough cleaning on various occasions

RM599(WM) RM605(EM)  
RRP: RM779(WM) RM785(EM)



## CORDLESS 3 in 1 STICK / HANDHELD VACUUM CLEANER

### MVC-CHS120

- Power rating: 120W
- Dust capacity: 1.2L
- With Motorized Dust Mite Brush
- Convertible stick / handheld vacuum cleaner
- ≥10,000 PA
- Rechargeable 2500 mAh capacity Lithium-Ion Battery.
- Continuous use up to 20 minutes running time
- Bagless dust container with Cyclone filter
- Rotating brush with 180° Swivels sideways for convenient handling in corners and around obstacles.

RM399(WM) RM405(EM)  
RRP: RM509(WM) RM515(EM)



180° Rotatable Brush Hose



Washable Cyclone Filter



Accessories

Accessories

Accessories

Accessories

Accessories

Accessories

Accessories

Accessories

Accessories

Accessories

Accessories

Accessories

Accessories

Accessories

Accessories

Accessories

Accessories

Accessories

Accessories

## VACUUM CLEANER

### MVC-DEXTEROUS 16PK

### MVC-DEXTEROUS 16BL

- Power rating: 1200-1600W
- 1.8 Litre dust capacity
- Bagless design with Dust Box
- Washable Dust Box – Easy to clean and maintain
- Multiple Filtration System: Pre-Filter, Hepa Filter and Carbon Filter
- Cable re-winder
- With Full Dust Indicator.

RM299(WM) RM309(EM)  
RRP: RM409(WM) RM419(EM)



Bagless Design Dust Box



Bagless Design Dust Box



Bagless Design Dust Box



Dry Vacuum



Wet Vacuum



Blow Function

Blow Function

Blow Function

## 3-in-1 VACUUM CLEANER

### MVC-TA161DW

- Power rating: 1600W
- 23 Litre dust capacity
- 360° swivel head
- 3-in-1 wet, dry & blow cleaning function
- Washable filter with long-lasting material

RM369(WM) RM379(EM)  
RRP: RM499(WM) RM509(EM)



Dry Vacuuming



Wet Vacuuming



Blow Function

Blow Function

Blow Function

## 3-in-1 VACUUM CLEANER

### MVC-TC181SS

- Power rating: 1800W
- 32 Litre dust capacity
- 360° swivel head
- 3-in-1 wet, dry & blow cleaning function
- Washable filter with long-lasting material

RM509(WM) RM519(EM)  
RRP: RM679(WM) RM689(EM)





Exclusive Dealer:

- Offer valid while stocks last
- Prices shown are not valid for redemption project & duty-free sales
- We reserve the right to alter, modify or replace the product price, specifications & models without prior notice
- All items featured in this catalogue may differ from the actual product in terms of colour & design details
- The recommended resale price is the price which the importer recommends that the retailer sell the product. Retailers are able to independently set the retail price.

\*RRP = Recommended resale price

Market Expansion  
Services by  
[www.dksh.com.my](http://www.dksh.com.my)



**DKSH Malaysia Sdn Bhd** 196101000441 (4476-U)  
B-11-01, The Ascent, Paradigm,  
No. 1, Jalan SS7/26A, Kelana Jaya,  
47301 Petaling Jaya, Selangor Darul Ehsan.  
Tel: +603 7882 8888 Fax: +603 7882 5555  
[www.morgan.my](http://www.morgan.my)

Customer Care Hotline: **03-7781 9229**



[facebook.com/morganappliances](https://facebook.com/morganappliances)