

Mórgan®

USER MANUAL

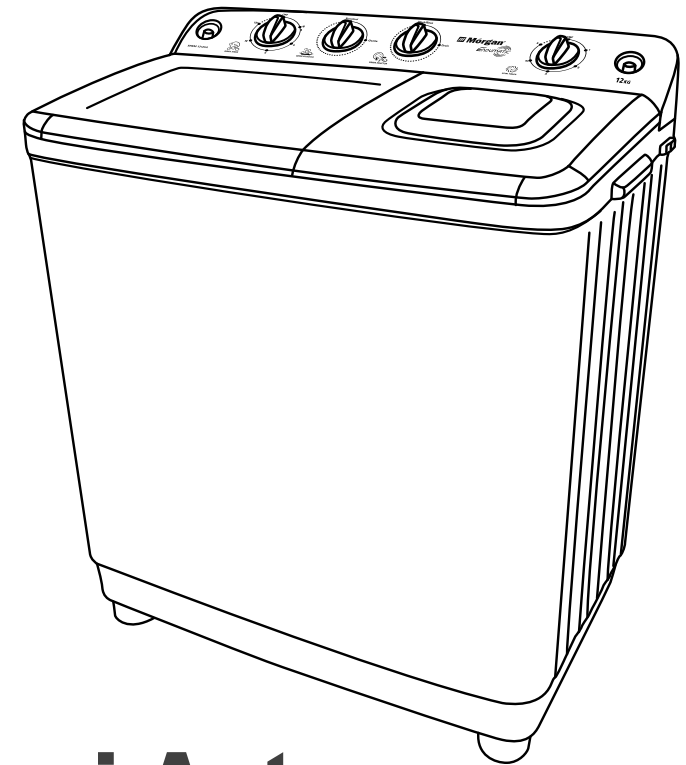

Semi-Auto Washing Machine

MWM-1312SA

Mórgan®



E-mail: electrical.appliance@dksh.com
www.morgan.my

 [facebook.com/morganappliances](https://www.facebook.com/morganappliances)

SAFETY PRECAUTIONS

The product belongs to I class appliance. Be sure to comply with the following to prevent damage to body and property.



Handling the product without observing the instructions that accompany a "Warning" symbol may result in serious injury or death.



Failure to observe the instructions that accompany this "Caution" symbol can result in injuries to person or damage to property.



Indicates "prohibited" actions that must not be performed

- Do not wash clothing with waterproof materials such as raincoat, down jacket or car cover. If in doubt, always refer to the clothing label to ensure it is machine-wash friendly.
- Do not wash clothes that have been immersed in volatile substances such as gas.



- Do not install the machine in the bathroom where it is damp and may pose an electrical/fire hazard.
- Do not install the machine where it is difficult to drain water.
- Do not put wet clothing on the machine especially on the control panel.

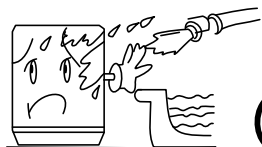

- Do not attempt to repair/modify the machine yourself.
- Do not use water hotter than 50°C as plastic parts may be deformed or damaged, and this may result in electric shock or fire.
- Do not place heavy objects on the washing machine.
- Keep the appliance away from the direct sunlight and other heat sources.
- Ensure a distance of at least 5cm between the machine and the wall.



- This appliance is not intended for use by persons (including children with reduced physical, sensory or mental capabilities, or lack of experience and knowledge, unless they have been given supervision or instruction concerning use of the appliance by a person responsible for their safety.
- Do not allow children to climb or play on the machine.
- Do not insert your hand into the machine while it is operating. It is dangerous even if it is operating at a slow speed.
- Do not allow children to play with packaging materials that came along with the machine.
- Exercise caution when opening the top lid as the angle between it and the horizontal plane is over 60° when open.

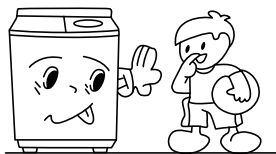

SAFETY PRECAUTIONS

- The washing machine should not be placed on a carpet as it requires air to circulate freely below it. Do not place the machine on a high platform to prevent it from falling.

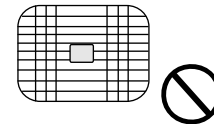

- Do not pull or excessively bend/twist/stretch the power cord. Do not hook the power cord over a metal object or place a heavy object on the power cord to avoid an electric shock or fire hazard.
- If the power cable or power plug is damaged or the socket becomes loose, have them repaired or replaced by an authorised service personnel to prevent an electrical hazard.

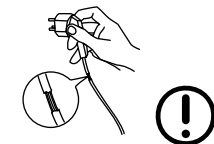

- Always unplug the appliance and turn off the water when moving or cleaning the washing machine, or when not in use.
- When the wash program is completed, turn off the water and unplug the power cable from the power outlet.
- Do not attach or detach the power plug with wet hands.

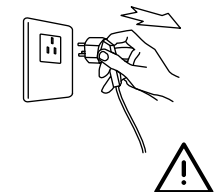

- Insert the power plug into the power socket with a 220-240V single-phase three-stage A/C power.
- NOTE: The power plug must be a single special socket that meets national compulsory certification of qualified products.

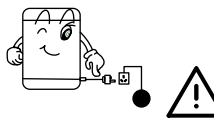

- This appliance must be earthed and kept away from underground water pipe and cable.



WATER INLET HOSE INSTALLATION

It is important to install only new water inlet hose sets supplied by the manufacturer. Do not reuse used water hose sets.

NOTE:

- Install only water inlet hose sets according to the specified model.
- Insert the water inlet hose into the water inlet mouth of the control panel (refer to illustration: "control panel").

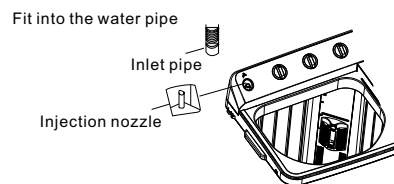

WATER SELECTOR

- Select water level according to the laundry weight – high / middle / low

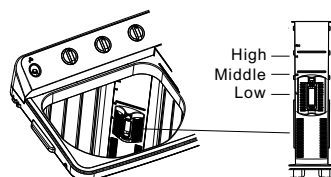

LINT FILTER B INSTALLATION

- Insert the bottom of the Lint Filter B into the crevice correctly.
- Press the top of the filter to secure it.

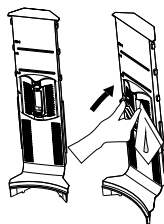

PREPARATION BEFORE WASHING SORTING

- Care Label: Sort the laundry into cottons, mixed fibres, synthetics, silks, wools, and rayon.
- Before washing, empty small objects from all pockets such as coins, keys etc., as these could damage the drainage pump.
- Knot the long band, fasten the buttons and close the zippers.
- Turn and reverse the clothes with buttons to prevent noise during washing.
- Do not overload the machine. Load the laundry loosely.

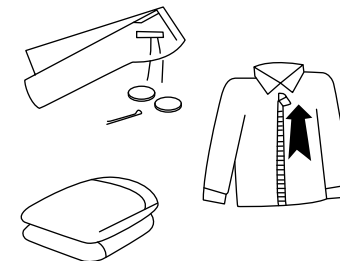

ADDITIONAL NOTES

- Make sure laundry is washable.
- Colour: Separate whites from colours
- Immerse non-absorbable laundries by hand.
- Before washing, pre-treat the sleeves, collars, dress hems, and pockets by brushing with detergent.
- In some cases, it may help to soak the stain before washing with a special pre-soak product or biological detergent.
- Do not mix clothes immersed with chemicals into the machine directly.
- Wash small items such as handkerchiefs, ribbons, and socks using a laundry net or a pillow case.

USING DETERGENT

DETERGENT

The type of detergent depends on the type of fabric (cotton, synthetic, delicate items, wool), colour, wash temperature, and degree of soiling. Always use "low suds" laundry detergent, which is designed for automatic washing machines.

1. Dissolve detergent in the machine directly (not suitable for pre-set program).
2. Add detergent and run for 30 seconds to dissolve it completely.
3. Place laundry into the wash tub and select suitable water level.

HOW TO DISSOLVE DETERGENT IMMEDIATELY

1. Prepare warm water in a container.
2. Pour detergent into container while stirring to fully dissolve it.
3. Refer to the detergent application instructions for appropriate amounts.
4. It is recommended to use "low suds" detergent for best results.

USING BLEACH

1. Fill water to the desired level, dilute the bleach in a container, and pour it slowly into the washing tub.
2. Do not use bleach for coloured laundry
3. Do not pour bleach directly onto laundry.
4. Refer to the manual for the usage and quantity of the bleach.
5. Always dissolve powdered bleach before use.

1. BEFORE WASHING

Connect water inlet hose **1**

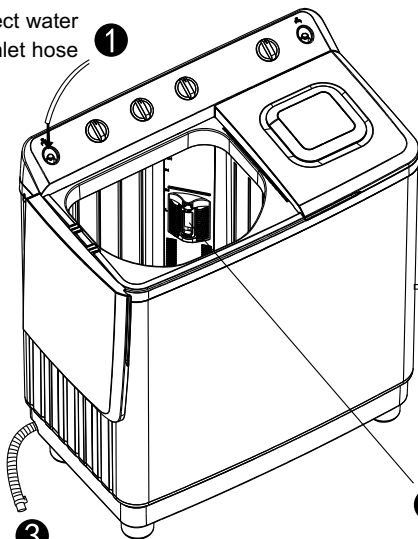

2 Connect to power supply

Ensure chip filter is installed **4**

3 Lay down the drainage hose

Rotate the charge-over switch firmly

2. WASHING ORDER

If the time set is within 2 minutes, the timer should be set for more than 6 minutes first before adjusting it back to 2 minutes.

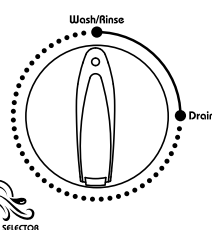
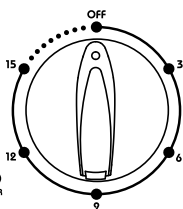

DRAINAGE SELECTION SWITCH

Rotate the drainage selection switch firmly from wash/rinse/switch

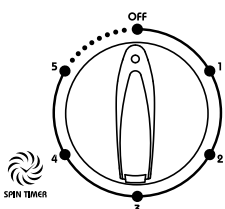

If the required time is set for 1 minute, it is suggested to set the timer for 2 minutes before adjusting it back to 1 minutes to extend the life of the timer.

3. WASHING

- Fill water to the desired level.
- Add washing powder and then run for 30 seconds to dissolve it completely.
- Place laundry and add water to the ideal water level.
- Select water speed according to the laundry.
- Select the washing time accordingly.
- After washing, select the "drain" function.

4. FIRST SPIN PROCESS

1. Place laundry into the spin tub loosely and evenly.
2. Spin
 - Press the gland
 - Close the spin cover
 - Spin for 1-2 minutes
3. Spraying spin
 - Open the spin cover
 - Place the inlet hose into the water inlet mouth and turn on water tap to spray on the laundry to remove excess suds.
 - Close the spin cover and spin for 1-2 minutes

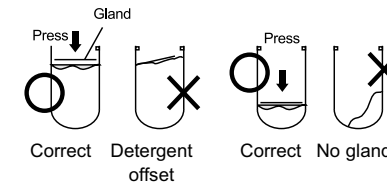

5. RINSE PROCESS

1. Place laundry into the spin tub loosely and evenly and select the ideal washing speed selection.
2. Stored rinse (repeated spin 2-3 times & rinse):
 - Fill water to the desired level.
 - Adjust wash timer to 2-3 minutes for rinsing. Select "gentle wash" when done.

6. SECOND SPIN PROCESS

1. Place laundry into the spin tub loosely and evenly
2. Place the gland correctly and close the spin cover
3. Select the desired spin time according to the laundry. If there is noise during spinning, pause the operation and adjust laundry evenly.

NOTES:

- During the spinning, water will be drained 1 minute during the process. The process will be paused if there is excess water inside the spin tub.
- The spinning process will pause if the spin cover is opened. Close the spin cover to continue the process.

Periodic care and maintenance keep the washing machine clean to prevent deteriorated performance and to preserve its life cycle.

Note:

- Turn the tap off after washing and discharge the drainage hose.
- Before proceeding with cleaning, detach the power cable from the power supply.
- Hang the power cable and drainage hose up.

LINT FILTER CLEANING

- The use of the lint filter is a must during washing and should be cleaned after every use.
- Ensure that the lint filter is inserted correctly to prevent it from falling off.

CLEANING STEPS

1. Detach the lint filter (see illustration 1)
2. Disassemble the lint filter and wash it (see illustration 2)
3. Attach the lint filter into its original position (see illustration 3)

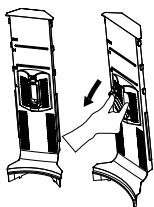

illustration 1

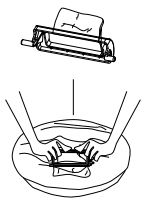

illustration 2

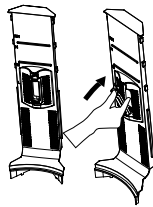
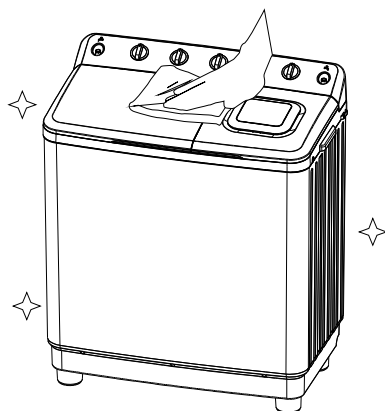

illustration 3

- Use neutral detergent when the machine is dirty.
- Do not use cleanser, volatile chemical materials to clean the machine, which will damage plastic parts and the exterior.
- Do not spray water directly at the machine.
- Detach the water inlet hose when cleaning.
- Do not store water in the tub for long periods of time.
- Drain water completely.
- Unplug it from the power supply after using and hang the power cable in the correct position.
- Clean the exterior cabinet of the appliance with a clean, soft cloth.



If you encounter a problem with the washing machine, first check the table below and check the possible causes.

PROBLEM	POSSIBLE CAUSES
Washing machine not working	<ul style="list-style-type: none"> • Machine not connected to power supply. • Power cable not inserted correctly. • Pulsator malfunction <i>(Please contact our after-sales service centre)</i>
Clothes spin away from the spinning tub	Please contact our after-sales service centre to avoid further drainage problems.
Machine unable to drain	Drainage hose bent or blocked.
Noisy during wash	Hard objects inside the washing tub.
Excessive noise & vibration	<ul style="list-style-type: none"> • Machine not balanced. • Laundry overloaded. • Laundry not spread evenly.
Water inside drainage hose & machine	This is normal as part of our factory test & quality check procedure.
Water droplets on the tub surface	This is normal when ambient temperature is higher than normal water temperature
Water drains out immediately	<ul style="list-style-type: none"> • Make sure drainage hose is not obstructed. • Water level may have exceeded the overflow level.