

 **Mórgan®**

USER MANUAL

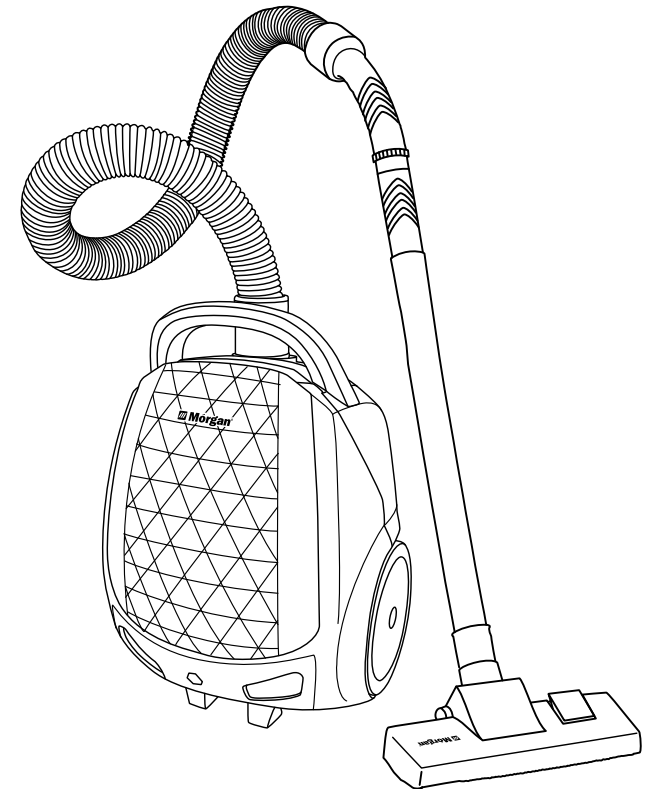

Vacuum Cleaner

MVC-DEXTEROUS 16

 **Mórgan®**

Market Expansion
Services by
www.dksh.com.my



DKSH

E-mail: electrical.appliance@dksh.com
www.morgan.my

 [facebook.com/morganappliances](https://www.facebook.com/morganappliances)

C O N T E N T S

- 3 Important Safeguards
- 4 Parts Identification
- 4 Specifications
- 5 Before Using For The First Time
- 5 Operating Instructions
- 6 Storage
- 6 Care & Cleaning
- 7 Dust Box Assembly Instructions
- 7 Troubleshooting Tips

IMPORTANT SAFEGUARDS

READ ALL INSTRUCTIONS BEFORE USING THE APPLIANCE.

When using electrical appliances, basic precautions should always be followed, including the following:

WARNING! TO REDUCE THE RISK OF FIRE, ELECTRIC SHOCK, OR INJURY:

1. Use only original accessories supplied.
2. Ensure that the voltage of the appliance corresponds to the voltage indicated on the power supply rating label at the bottom of the appliance.
3. Never operate the appliance unless it is fully assembled.
4. Do not overload outlets or extension cords as doing so can result in the risk of fire or electric shock.
5. Do not operate the appliance if the power supply cord or plug has been damaged in any manner.
6. If the power cord is damaged, it must be replaced by an original recommended power cord available from the manufacturer or its service agent.
7. This vacuum cleaner is intended for indoor and household use only; not for outdoor, commercial and industrial use.
8. Do not immerse the power cord, power plug or appliance in water or any other liquids and do not splash water onto it to avoid the risk of fire, electrical shock or personal injury.
9. To protect against risk of electric shock, do not insert any foreign objects such as pins and wires into any ventilation openings.
10. Never pull the appliance by the power cord. Instead, grasp the power plug and pull to disconnect.
11. Do not place the appliance on or near to hot gas/electric burner, or a heated oven. Do not allow power cord to hang over the edge of table or counter or touch any hot surfaces.
12. Detach the power plug from the power supply if appliance is not to be used for a long time.
13. DO NOT vacuum flammable substances and sharp objects that could obstruct the hose.
14. DO NOT vacuum water, inflammable or corrosive liquids.
15. DO NOT use the appliance without the dust box & dust bag installed.
16. DO NOT allow children to use an electrical appliance without adult supervision.
17. DO NOT store or use the appliance near high temperature areas.
18. Always operate appliance on level surfaces.
19. **IMPORTANT:** Always disconnect the appliance from the power supply when not in use, before cleaning the filters or connecting/disconnecting the accessories.
20. This appliance can be used by children aged from 8 years and above and persons with reduced physical, sensory or mental capabilities or lack of experience and knowledge if they have been given supervision or instruction concerning use of the appliance in a safe way and understand the hazards involved.
21. Store the machine indoors after every use with the power cord wrapped safely to prevent tripping accidents.
22. Turn off all controls before unplugging the appliance from the power supply.

PARTS IDENTIFICATION

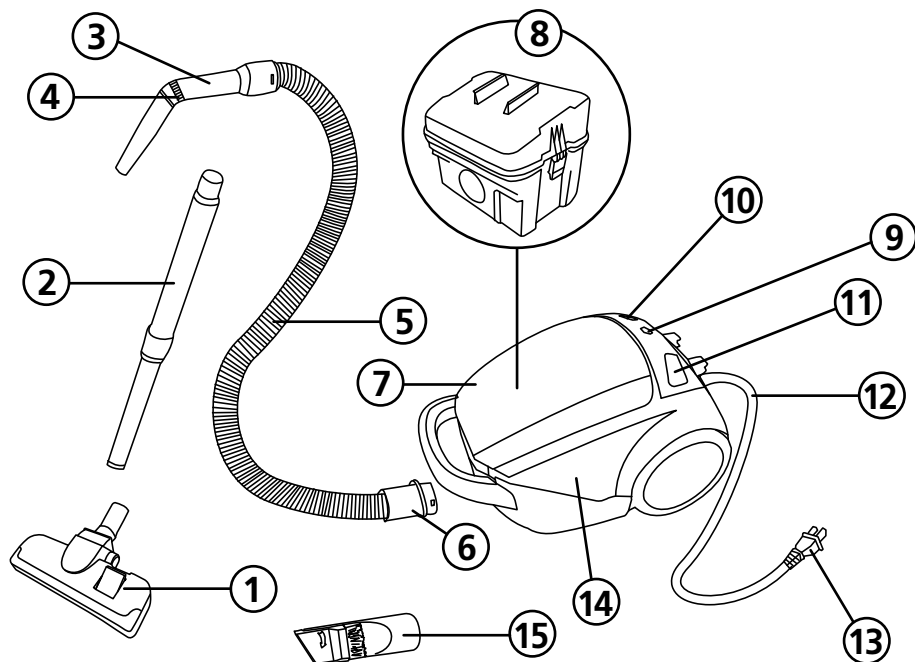

- | | |
|----------------------------|-------------------------|
| 1. Floor Brush | 9. Dust Indicator |
| 2. Extension Tube | 10. Switch Button |
| 3. Hose Handle | 11. Cable Rewind Button |
| 4. Airflow Adjustable Ring | 12. Power Cord/Cable |
| 5. Flexible Hose | 13. Power Plug |
| 6. Hose Connector | 14. Body |
| 7. Body Cover | 15. 2-in-1 Nozzle |
| 8. Dust Box | |

SPECIFICATIONS

MODEL	MVC-DEXTEROUS 16
RATED VOLTAGE / FREQUENCY	220-240V~ 50/60Hz
RATED POWER	1200-1600W
MAX. SUCTION	19-21Kpa
DUST BOX CAPACITY	1.8L

BEFORE USING FOR THE FIRST TIME

- Read all instructions carefully before using and keep them for future reference.
- Ensure that the voltage of the appliance corresponds to the voltage indicated on the power supply rating label at the bottom of the appliance.
- Before using, remove any protective films or stickers from the product.
- Ensure the power button is at the OFF position.
- Ensure dust box/ dust bag in place.
- To ensure optimal performance of the appliance, remove dust from dust box regularly.

OPERATING INSTRUCTIONS

1. Insert dust box in the appliance. Never operate without the dust box in place.

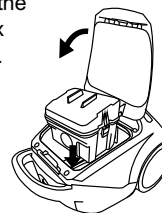

2. Connect the vacuum hose to the suction inlet and twist it anti-clockwise.

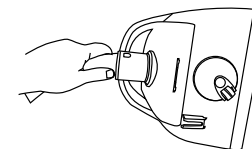

3. Connect the extension tube/telescopic tube to the other side of the hose handle.

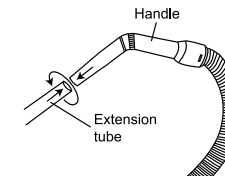

4. Select and connect the desired accessory.

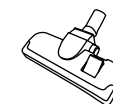
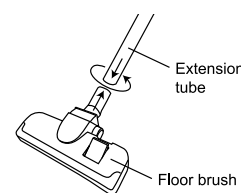

Floor brush
For carpet and wooden floor, etc.



Crevice nozzle
For corners, cracks, etc.



Bristle brush
For sofa, bookshelf, curtain and furniture, etc.

5. Pull the power cord out the appliance and connect the power plug to the power supply.

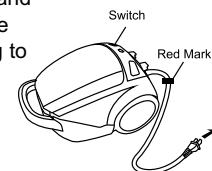

6. Turn power ON.

NOTE: The red line on the power cord indicates the end of cable length. Do not further pull cable further to avoid damaging the connection

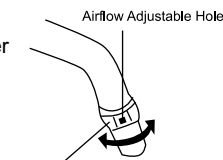

7. Airflow is adjustable by turning the Airflow Adjustable Ring.

Airflow Adjustable Ring

STORAGE

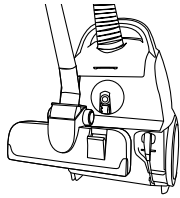

Attach power plug on the plug holder and insert nozzle into the holder at the bottom of the appliance (As per picture show)

DUST BOX CLEANING INDICATOR

- It is recommended to always clean the dust box/dust bag after use to maintain the vacuum cleaner's suction performance.
- Clean the dust box immediately If suction performance is reduced or the dust indicator window turns red.

CARE & CLEANING

- Always detach power plug from the power supply before carrying out cleaning work.
- Do not leave the vacuum cleaner unattended when plugged in.
- Do not use abrasive sponge, scouring pads or stiff brush to clean the appliance, dust box and filter.
- Use a damp cloth to wipe exterior surfaces. Do not immerse the main body in water or other liquids.
- Do not expose the motor or other electrical components to water.
- Always store the vacuum cleaner in a low humidity environment.

CLEANING INSTRUCTIONS

1. Open the body cover and detach the dust box by pulling it upwards.

Remove Dust Box from Vacuum

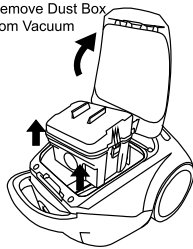

2. Hold the dust box over a dustbin and empty it.

Dust Box can use water clean

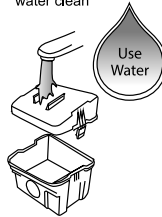

3. The dust box and nozzles can be washed in water. Allow to dry before reassembling.

4 Items Filter using hand gently tapping (clean)

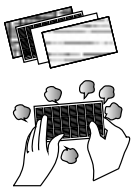

4. Reassemble the dust box and filter into their respective positions and fasten the dust box lock.

NOTE: Do not use alcohol, gasoline or other abrasive cleansers for cleaning.

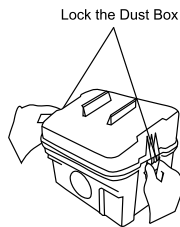

DUST BOX ASSEMBLY INSTRUCTIONS

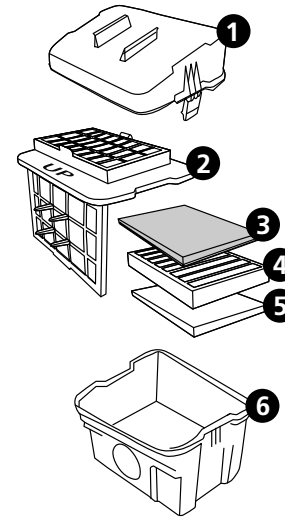

1. Dust Box cover (washable)
2. Filter Holder (washable)
3. Active Carbon filter (washable)
– Black Colour
4. HEPA Filter (washable)
5. Pre-Filter (washable)
6. Dust box casing (washable)

NOTE: Reassemble the dust box and filter into their respective positions & lock securely.

NOTE: Ensure Dust Box is completely dry before reassembling.

TROUBLESHOOTING TIPS

1. The vacuum cleaner is equipped with overheat protection device.
2. In the event of overheating, the appliance will automatically shut down.
3. Detach power plug from power supply and switch off power.
4. Clean the dust box, filter and inspect hose/ accessory for blockage/obstructions.
5. Pause the appliance for an hour before using.
6. For weak suction power or inability to pick up dust - switch off power and inspect hose and/or accessory for blockage/obstruction and clean the dust box and filter.
7. If the problem persists, return appliance to your authorized service centre for examination and repairs.

WARRANTY

No responsibility will be accepted for damage resulting from improper or negligent use or non-compliance with the instructions.