

 **Mórgan®**

USER MANUAL

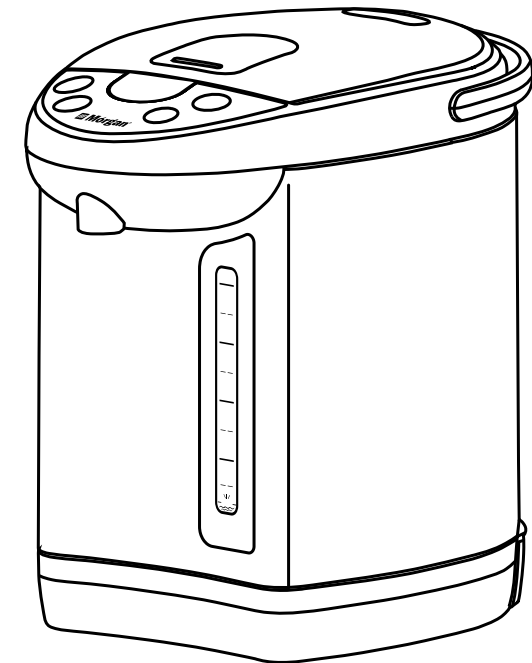

Thermo Pot

MTP-266TSS

 **Mórgan®**

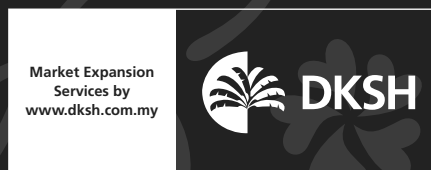

E-mail: electrical.appliance@dksh.com
www.morgan.my

 [facebook.com/morganappliances](https://www.facebook.com/morganappliances)

Thank you for purchasing a quality MORGAN appliance. We trust that you will have a pleasant experience with your new product. To guarantee safety and best efficiency, please read this manual carefully and keep a copy for future reference.

C O N T E N T S

- 3** PARTS IDENTIFICATION
- 4** IMPORTANT SAFEGUARDS
- 4** SERVICE & IMPORTANT NOTICE
- 4** BEFORE USING THE THERMO POT
- 5** USING THE THERMO POT
- 5** SPECIFICATIONS
- 6** OPERATING INSTRUCTIONS
- 6** SAFETY PRECAUTIONS
- 7** CARE & CLEANING

PARTS IDENTIFICATION

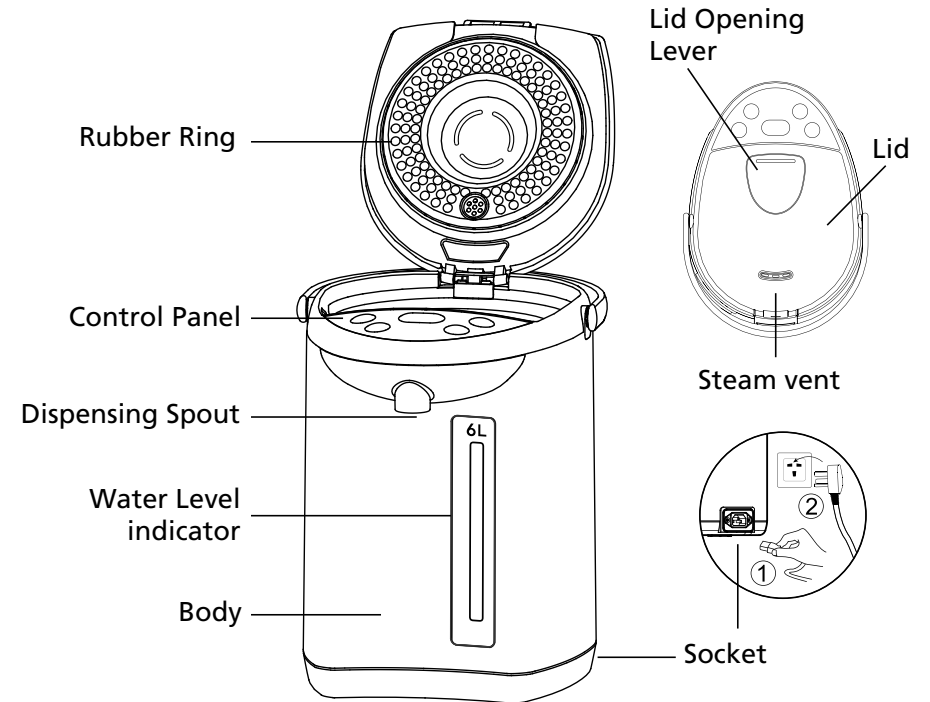

CONTROL PANEL

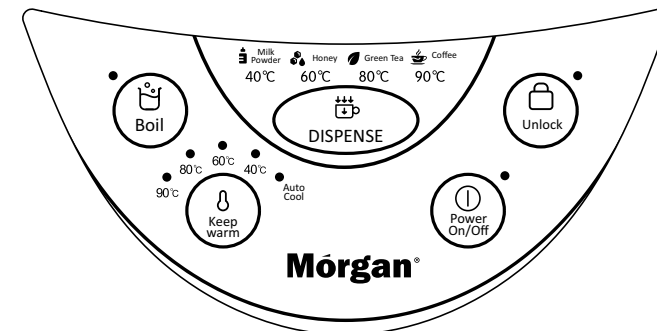

IMPORTANT SAFEGUARDS

TO PREVENT ELECTRICAL SHOCK OR FIRE:

1. DO NOT disassemble/modify the parts, or repair the appliance by yourself.
2. DO NOT use when the power plug cord is damaged or when the power plug does not fit the socket securely.
3. DO NOT bend, or yank on the power cord forcibly to prevent damaging it.
4. DO NOT allow any obstacles such as dust to stick onto the body plug and the power plug.
5. DO NOT plug into a power socket where several other appliances are plugged in. The Ampere must not exceed the socket's limit.
6. DO NOT place the appliance on any non-heat-resistant surface.
7. DO NOT immerse the appliance in water, or splash water over the appliance.
8. DO NOT overfill the inner pot.
9. DO NOT pour in icy cold water as it causes condensation.
10. DO NOT pull on power cord to disconnect. Instead, grip plug and remove from power supply.
11. DO NOT leave the power plug connected to the power supply when not in use.

USING THE THERMO POT

1. Pull the lid opening lever up to open the lid and fill water into the water tank.
2. Always fill water above the minimum water level mark and below the maximum water level mark (refer to the water level mark inside the water tank.)
3. Connect the power plug to the power supply, thermo pot will enter standby mode, press BOIL button to select water type and start boiling water automatically (in 5 secs.).
4. During boiling, the selected temperature light will blink. When the boiling completes and water temperature reach the selected temperature, the light will turn steady and "beep" sounds, then keep water warm automatically.
5. Press UNLOCK button before pressing DISPENSE button to dispense hot water.
6. Press BOIL button to reboil water to 100°C that is being kept warm.
7. Standby Mode: When thermo pot connect the power supply, it'll enter the standby mode, the light beside ON/OFF will blink. Press the BOIL or WARM button, thermo pot will start boiling or warming water. Press ON/OFF button will turn off thermo pot. DISPENSE could work anytime once connect the power supply, even turn off.

***** TEMPERATURE LIGHT BLINKS MEANS THE WATER TEMP. INSIDE IS HIGHER/LOWER THE SELECTED TEMPERATURE.**

SERVICE & IMPORTANT NOTICE

- If the power cord is damaged, it must be replaced by an original recommended power cord available from the manufacturer or its service agent.
- **WARNING:** This appliance is not intended for use by persons (including children) with reduced physical, sensory or mental capabilities, or lack of experience knowledge, unless they have been given supervision or instruction concerning use of the appliance by a person responsible for their safety.

SPECIFICATIONS

MODEL	MTP-266TSS
RATED VOLTAGE / FREQUENCY	220-240V~ 50/60Hz
RATED WATTAGE	750-892W
CAPACITY	6.0L

BEFORE USING THE THERMO POT

- Before using the appliance, ensure that the power supply voltage corresponds to the voltage indicated on the rating plate at the bottom of the appliance.
- Wash and rinse water tank with clean, running water.
- Fill water up to full mark.
- Boil once and discard the water by pressing on the dispense button.

NOTE: The appliance may give out a plasticky odour when using it for the first few times. This is normal and the odour will disappear with repeated use.

OPERATING INSTRUCTIONS

BOILING DURATION:

Approx. 35 min. (Amount of water: Maximum, Water/Room temp.: 20°C. Time differs according to climate and regions)

OVERHEATING PROTECTION:

1. When the water boils dry, the thermo pot will automatically cut off the power to prevent accidents.
2. The auto CUT-OFF function will also operate when:
 - The power is switched on, but no water is inside the water tank.
 - Water level is below the MIN water level mark.

OPENING / REMOVING THE LID:

1. To open the lid - Press the depression in the lid opening lever and lift the lid.
2. To remove the lid - open the lid to the approximate 45° position. Pull the lid towards.

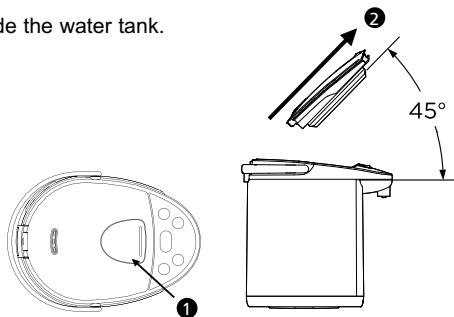

SAFETY PRECAUTIONS

TO PREVENT BURNS AND INJURY:

1. DO NOT place on unstable surfaces.
2. DO NOT cover the appliance with a cloth, etc., as hot water may seep out by itself, causing the lid to be deformed.
3. DO NOT fill and boil anything except water.
4. DO NOT fill water above the Maximum Water supply level as hot water may seep out by itself.
5. DO NOT open the lid, dispense hot water, move the appliance during or just after boiling.
6. DO NOT touch the Steam Vent while boiling.
7. DO NOT carry the appliance by the lid.
8. DO NOT wind the power cord around the appliance.
9. DO NOT slam the lid, or close it negligently. Hot water may seep out by itself.
10. DO NOT tilt the appliance, nor let it fall over.
11. Just after boiled or reboil, the pump may be full with steam. Press the DISPENSE button a few times if it is difficult to dispense hot water just after boiling.
12. A noise created by exiting steam may be heard when dispensing. This is normal. After the steam has completely exited, the hot water will be easier to dispense.
13. To avoid noise when pressing the DISPENSE button, open the lid for a few seconds or wait for a few minutes for the steam to exit automatically.

SAFETY PRECAUTIONS

CAUTION

1. DO NOT place near open flames.
2. DO NOT use the appliance without sufficient space around it, as exiting steam may damage the wall etc.
3. DO NOT leave the water for long durations inside the Inner Pot.

ECO / SLEEP FEATURE

1. If no operation in 48hrs, the unit will shut off automatically. This is a safety feature for people who leave home for a couple of days but forget to turn off the Thermo pot.
2. When the unit enters this ECO mode. Press the On/Off button to start it over.

CARE & CLEANING

1. Detach the power plug from the power supply before cleaning.
2. Discard any remaining hot water and allow the appliance to cool down completely before cleaning.
3. Wipe with clean damp cloth. Do not immerse the thermo pot into water or any other liquids.
4. Do not clean with abrasive detergent, gasoline or turpentine to avoid damaging the outer body's finishing.
5. Wipe the inner pot using a clean damp cloth or soft sponge.
6. Do not use any brush with hard bristles or with abrasive detergent.
7. Remove dirt/grime on the outer body using a soft, damp cloth.
8. After using for prolonged durations, water impurities will accumulate inside the inner pot and clog the water outlet.
9. To clean water impurities inside the inner pot, fill citric acid (70gm) with water into the inner pot and boil for 30 minutes once every month if the water used is not purified.
10. Discard water after boiling and gently wipe all water remnants with soft wet sponge once the appliance has cooled down.
11. Boil water again and discard completely to clean the inner pot. Repeat if necessary.
12. Prior to storage, ensure that the unit is completely dry. Store it into a plastic bag and seal it to prevent insects from getting in.