

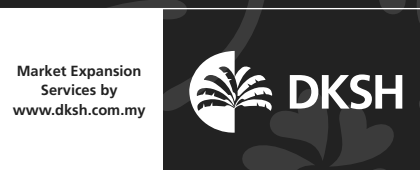

 **Mórgan®**

 **Mórgan®**



E-mail: electrical.appliance@dksh.com
www.morgan.my

 [facebook.com/morganappliances](https://www.facebook.com/morganappliances)

USER MANUAL

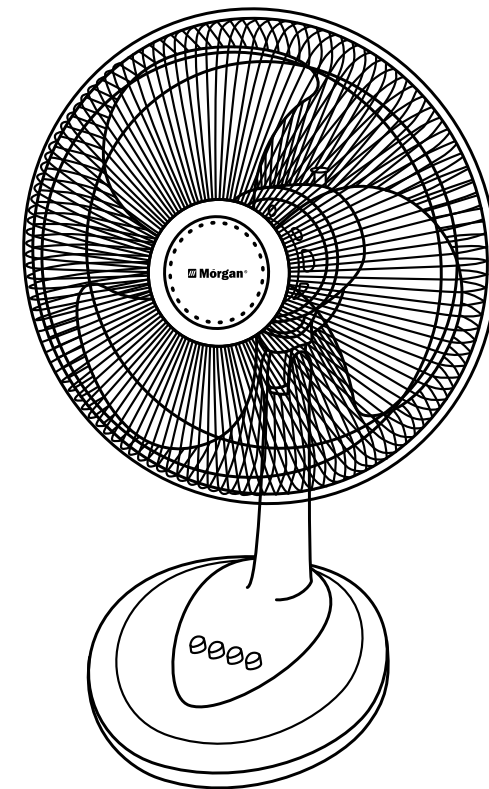

Table Fan

MTF-12T1
MTF-16T1

C O N T E N T S

- 3** Parts Identification
- 3** Specifications
- 4** Safety Precautions
- 5** Assembly Instructions
- 5** Operation Instructions
- 6** Trouble Shooting

PARTS IDENTIFICATION

1. Front Grille
2. Spinner
3. Blade
4. Plastic Nut
5. Rear Grille
6. Housing
7. Control Switch
8. Base

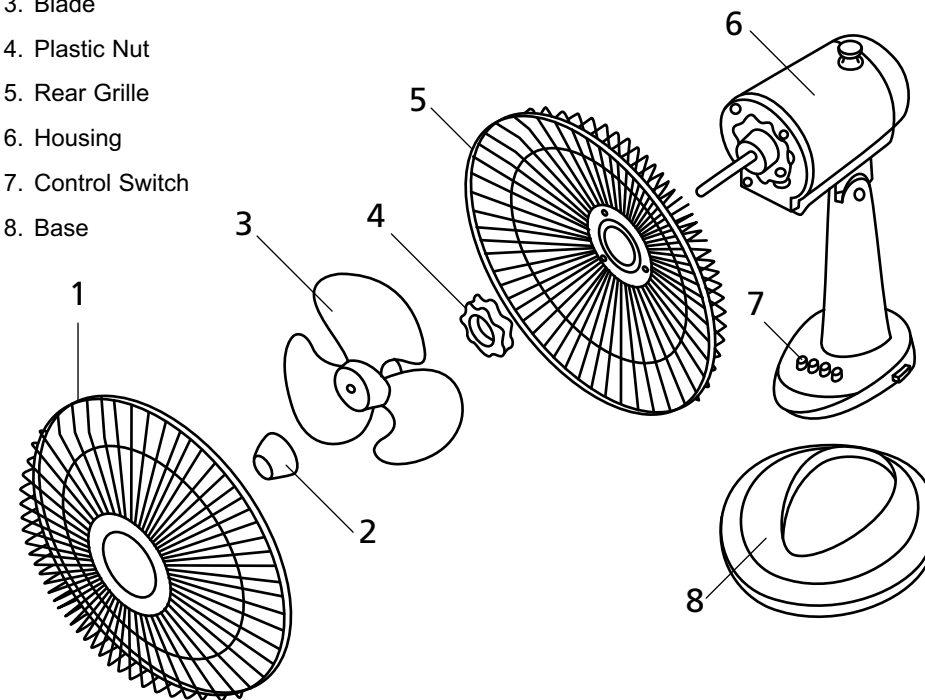

SPECIFICATIONS

MODEL	MFC-12T1	MTF-16T1
RATED VOLTAGE / FREQUENCY	220-240V~ 50Hz	
RATED WATTAGE	45W	55W
SIZE	300MM	400MM

SAFETY PRECAUTIONS

Congratulations on your purchase of another quality Morgan product. We seek to excel by designing products with innovation, quality and safety of our customers in mind.

- Do not use outdoors. Your appliance is intended solely for household use only.
- Do not operate the appliance if power cord or power plug has been damaged, It must be replaced by the manufacturer or its service agent or a similarly qualified person in order to avoid any hazards.
- Never leave the appliance within reach of children without supervision. The use of this appliance by young children or the physically challenged must always be supervised.
- Unplug the fan before cleaning, transportation and after you have finished operating the fan.
- Never immerse the appliance, the power cable or the power plug in water or in any other liquids. Never spray liquids onto fan.
- Deformation or operational failure may take place when the appliance is used on unstable surfaces or close to places with heating sources.
- Avoid contact with moving parts.
- Do not operate in the presence of explosives or flammable fumes.

NOTE

- Always ensure fan is properly fitted before use.
- The use of attachments not recommended by the manufacturer may be hazardous.
- Always use on a dry, flat surface.
- If appliance malfunctions or has been damaged in any manner, do not attempt to repair this appliance yourself but return it to the agent for examination, repair or adjustment.

ASSEMBLY INSTRUCTIONS

ASSEMBLY OF FAN PEDESTAL ONTO BASE

1. Insert the fan pedestal into the base and press the pedestal firmly into position.
2. On the underside of the base, tighten pedestal and base firmly together.

ASSEMBLY OF BLADES AND GRILLES

1. Unscrew the spinner clockwise and the nut counter-clockwise then remove the plastic sleeve around the motor shaft.
2. Place the rear grille in proper position with the handle facing upwards.
3. Screw on the plastic nut tightly to the attached fan grille.
4. Discard sleeve on shaft.
5. Slide the blade onto the shaft until it contacts the retaining pin.
6. Screw the spinner onto the motor shaft in a counter-clockwise direction.
7. Loosen the screw on the plastic ring with a screw driver. Mount the front grille (logo place in the proper direction) with the rear grille and fasten the plastic ring.

OPERATING INSTRUCTIONS

1. Fan speed is controlled by pressing the control switch.
2. To oscillate, push down the knob on the motor housing.
3. To stop oscillation, pull up the knob.
4. To adjust vertical angle, tilt fan head upwards or downwards as desired.

TROUBLE SHOOTING

PROBLEM	SOLUTION
No oscillation	Check if oscillation knob is depressed
Not functioning	Check power plug, ensure that power is switched on and Speed selector is turned to either one of the three speeds.
Noisy	Ensure that the fan blade is properly inserted into shaft pins. Ensure that plastic nut for rear grille is tightened. Ensure fan blade knob is securely tightened. Ensure fan grille ring is securely tightened.