

 **Mórgan®**

USER MANUAL

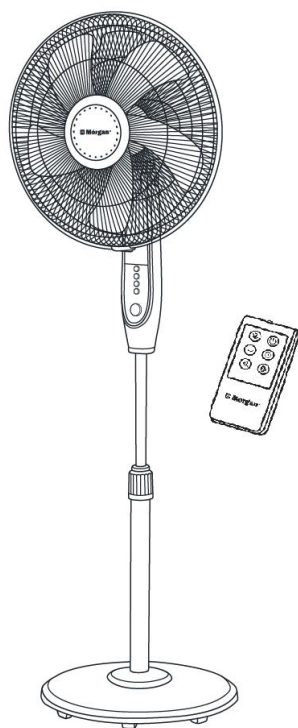

Stand Fan

MSF-16P3R

C O N T E N T S

2

Parts Identification

2

Specifications

3

Safety Precautions

4 - 8

Operating Instructions

5

Care & Maintenance

PARTS IDENTIFICATION

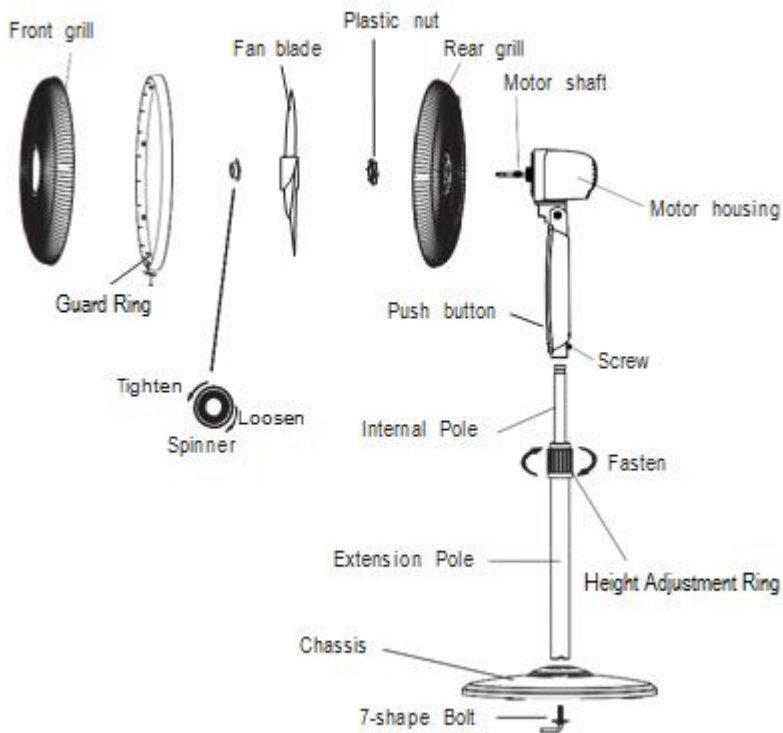

SPECIFICATIONS

Rated Voltage / Frequency	220-240V~ 50Hz
Rated Wattage	55W
Size	16"(400mm)

SAFETY PRECAUTIONS

1. Thank you for purchasing a quality Morgan appliance. Please keep this instruction manual close at hand for future reference.
2. Always unplug the appliance from the power supply outlet before cleaning or when not in use.
3. Do not allow children to operate this appliance and always keep it away from children's reach to prevent scalds, electric shocks or other injuries.
4. Always attach the power cord to the appliance **BEFORE** you plug it into the power supply. To disconnect the appliance, switch off first before removing the power plug from the power supply.
5. Close supervision is necessary when operating the appliance near children. Ensure the power cord does not hang over the work surface.
6. Do not operate the appliance with a damaged power cord set or plug. Any repairs should always be undertaken by an experienced technician or by an authorized service centre.
7. Always place the appliance on a flat sturdy surface. When moving the appliance, always be aware not to touch hot surfaces, or avoid possible spillage of hot liquids it may contain.
8. Do not immerse the appliance, or electrical parts into water or any other liquids.
9. Use of accessories or equipment not supplied by the manufacturer may cause damage or malfunctioning of your appliance or result in injuries.
10. **Note: This appliance is recommended for household use only.** Do not use the appliance apart from its intended use or while standing on a damp area.
11. Do not place the appliance on or near a hot gas or electric burner, or near easily flammable material.
12. This appliance should not be used by the physically challenged, slow in response or mentally challenged people (including children) unless close supervision is provided during operation.

Assembly of chassis & Column Unit

1. Unscrew the 7-shape Bolt from the Extension Pole. (Fig.1)
2. Insert the extension pole into the chassis and tighten the 7-shape Bolt (Fig.2)
3. From the extension pole loosen the height adjustment ring and adjust the internal pole to the desired height. (Note: If you can't find the internal pole, it must inside the extension pole. You can pull it out from the extension pole.) (Fig.3)
4. To attach the head unit to the internal pole, loosen the thumb screw on the bottom of the head unit. Place the head unit on the internal pole and tighten the thumb screw in alignment with the groove on the internal pole. (Fig.4)

CAUTION: Height adjustment ring must be fully fastened before the assembly of the motor section to the internal pole.

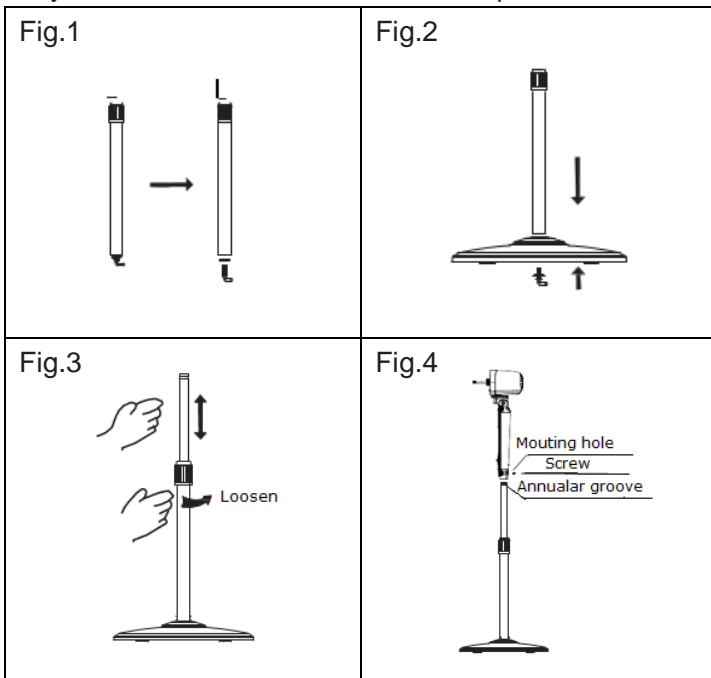

Grill & Fan Blade Assembly

1. Unscrew the spinner clockwise (or take the spinner out from the bag) and the plastic nut counter clockwise to remove both of them. Fix the rear grill to the motor then tighten the plastic nut again. (Fig.5)
2. Insert the blade into shaft, and make sure the rotor shaft pin is fitted into groove of the blade. Turn the spinner counter clockwise to tighten the blade. (Fig.6)
3. Fix the front grill and the rear grill with guard ring and then use the fasten clip to tighten the fan grill. (Fig.7)

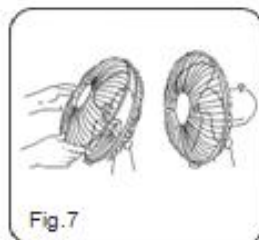
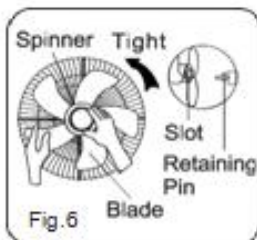
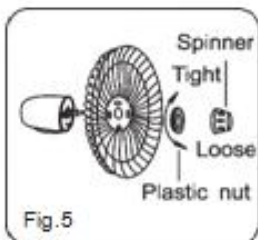

I. Remote Controller (Fig.8)

a. KEY INSTRUCTION

1. ON/OFF KEY

The key is for switching on and off the fan. The fan will be started at breeze step. Press again the key if the needs to switch off.

2. SPEED KEY

When the fan started, press this key repeated, the fan will work with "0-1-2-3-4(Off-Breeze-Low-Medium-High) circulatory.

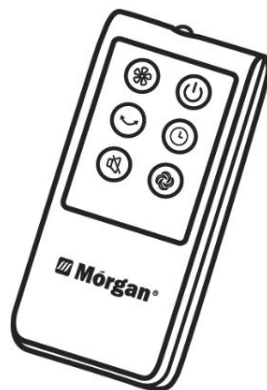

3. **TIMER KEY**

When this key is touched repeatedly or kept in pressed state, the time to be set for air delivery increased step by step of each 0.5 hour and sums to 7.5 hours in 15 steps.

For instance, if the fan operation is required to be set for 5.5 hours, this key must be touched repeatedly so that the pilot lamps for 0.5, 1 and 4 hours lighten together. It means that the set time is $0.5 + 1 + 4 = 5.5$ hours.

The time setting indicated by the pilot lamp will decrease gradually by a unit of 0.5 hour.

Don't press the **TIMER** key when the fan is required to operate continuously. At the moment all pilot lamps don't light.

4. **OSC KEY**

After the fan is started, press this key to oscillate the fan, and stop the oscillation at desired direction by pressing again. By rotating the fan head by hand, you can get wider oscillation angle.

5. **MODE KEY**

Press this key to select mode. The sequence is normal, natural and sleep when this key being touched repeatedly or continuously. The light can indicate mode state.

Normal wind

Press the "mode" key to select the normal wind, then press the "speed" repeatedly to choose 3 speed.

Natural Wind

Press the "mode" key to select the natural wind, then press the "speed" repeatedly to choose 3 speed.

Sleep Wind

Press the "mode" key to select the sleep wind, then press the "speed" repeatedly to choose 3 speed.

6. SILENCE KEY

In the state of non-silence, press silence button, the fan would be in silent state and the silence icon is lightened, while the indicator icons of the other wind types and wind levels would turn off. In silent state, press wind type button, blast volume (+) and(-) buttons, there would be no response, while other buttons could respond normally. Press silence button again to quit and the fan would return to the previous working state. The silence icon turns off and “00” is displayed on the digital screen.

b. BATTERIES

- (1) Slide the battery compartment Cover.
- (2) Insert the batteries, and make sure that the batteries are placed as shown in the Fig.10.
- (3) Slide back the battery cover.

NOTES: Use size “AAA” manganese or alkaline batteries. Do not use rechargeable batteries.

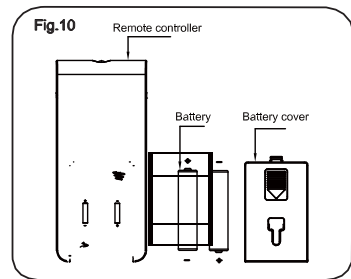

c. BATTERY WARNING AS BELOW

1. “Do not dispose of batteries in fire, batteries may explode or leak.”
2. -Do not mix old and new batteries.
3. -Do not mix alkaline, standard (carbon-zinc) or rechargeable (nickel-cadmium) batteries.

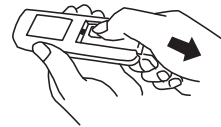
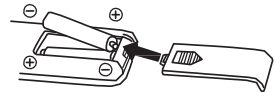

d. REMOTE CONTROLLER OPERATION

Point the remote controller at the receptor on body of the fan and press the desired button. The remote controller will work at distances of up to roughly five meters and the angle of 30 degree included between right and left from the receptor.

The batteries must be removed from the remote controller before it is scrapped and that they are disposed of safely.

e. OVERHEAT PROTECTION OF THE MOTOR

The windings of the motor have a thermal-fuse that burns out and the fan switches off and temperature of the motor is no longer going up so that plastic parts of the fan don't subject to deformation so far so to be burned by the overheat if the motor is overheat for any unexpected reason.

I. Control Panel (Fig.9)

These keys of the control panel may be used as same as of the remote controller.

II. Tilt Adjustment

To adjust the air flow upward or downward, push the grilles lightly to the desired direction.

III. Height Adjustment

The height of the fan can be adjusted by loosening the height adjustment ring carefully raising or lowering the fan and firmly re-tightening the height adjustment ring.

iv. Power off / off memory

Fan shutdown or power off, the power is switched on again starts, will be operating in the state of shutdown or power off (not before the timing function of memory).

CARE & MAINTENANCE

1. Be sure to unplug from the electrical supply source before cleaning.
2. Plastic parts should be cleaned with a soft cloth moisten with mild soap. Thoroughly remove soap film with dry cloth.
3. The fan requires little maintenance. Do not try to fix it by yourself. Refer it to qualified service personnel if service is needed.
4. Before cleaning and assembling, fan must be unplugged.
5. To ensure adequate air circulation to the motor, keep vents at the rear of the motor free of dust. Do not disassemble the fan to remove dust.
6. Please wipe the exterior parts with a soft cloth soaking a mild detergent.
7. Do not use any abrasive detergent or solvents to avoid scratching the surface. Do not use any of the following as a cleaner: gasoline, thinner.
8. Do not allow water or any other liquid into the motor housing or interior parts.

 **Mórgan**[®]

Market Expansion
Services by
www.dksh.com.my



DKSH

E-mail: electrical.appliance@dksh.com