

 **Mórgan®**

# USER MANUAL

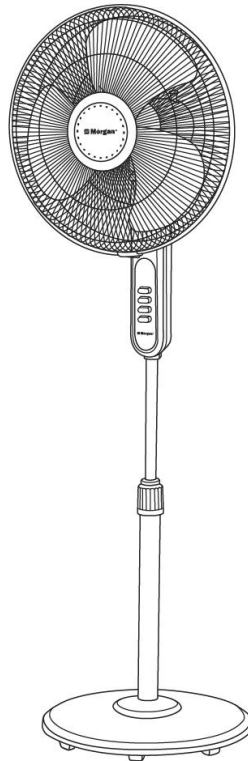

**16" STAND  
Fan**

**MSF-16P2**

# C O N T E N T S

1

Parts Identification

2

Specifications

2 -3

Safety Precautions

3 - 6

Operating Instructions

6

Care and Cleaning

# PARTS IDENTIFICATION

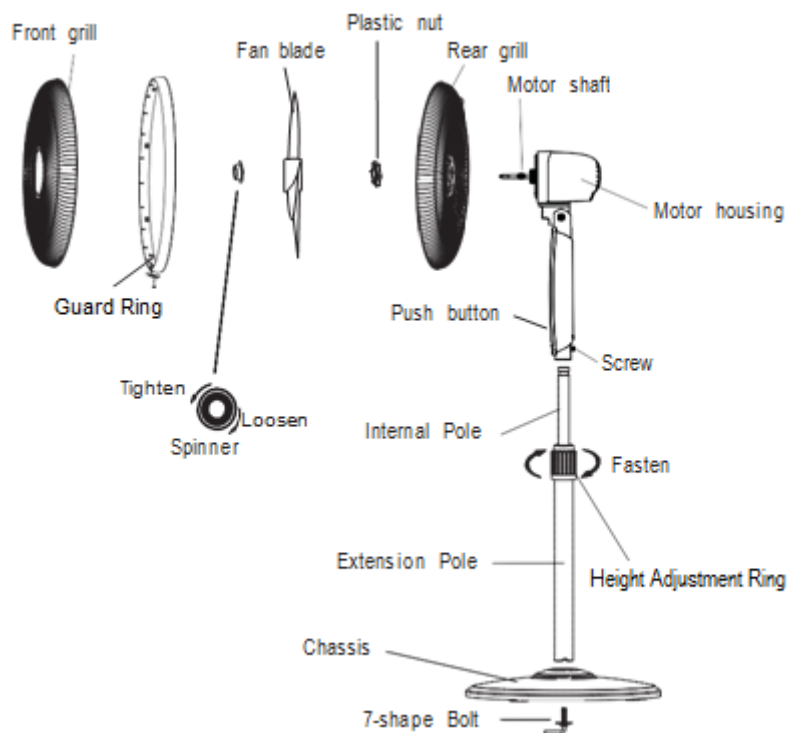

# SPECIFICATIONS

<b>RATED VOLTAGE</b>	<b>220-240V~</b>
<b>RATED POWER</b>	<b>50W</b>
<b>FREQUENCY</b>	<b>50Hz</b>
<b>SIZE</b>	<b>16" (400MM)</b>

# SAFETY PRECAUTIONS

When using the appliance, especially when children are present, basic safety precautions should always be followed including the following:

1. Read all instructions carefully before using the appliance.
2. Check that the voltage range given on the appliance-rating label corresponds with that of your main power supply's voltage.
3. This appliance is suitable for normal household use only and not for commercial use.
4. Use the appliance only on a level working surface.
5. Do not hold the appliance on the slant while it is working.
6. Do not operate the appliance with a damaged cord or plug or after the appliance malfunctions or has been dropped or damaged. Return the appliance for examination, adjustments, or repair.
7. The use of attachments not recommended may cause fire, electrical shock, or risk of injury.
8. Unplug the unit when not in use and whenever you clean or move the unit.
9. To disconnect the appliance, set control to OFF, grip plug and pull from wall outlet. Never yank on cord.
10. This appliance is not intended for use by persons (including children) with reduced physical, sensory or mental capabilities, or lack of experience and knowledge, unless they have been given supervision or instruction concerning use of the appliances by a person responsible for their safety.

# SAFETY PRECAUTIONS

11. Only authorized service personnel should undertake repairs on electrical appliances. Faulty, unqualified repair work may cause accidents or injury to the user.
12. If the supply cord is damaged, have it replaced by the manufacturer or its service agent or a similarly qualified person in order to avoid a hazard.

# OPERATING INSTRUCTIONS

- Installing the fan body and base:
  - Insert the fan body to the extension tube and lock into position with screw as provided. Then, connect and fix it to the stand body.
  - Insert the stand body to the base unit firmly. Reverse the whole unit and secure the stand body by fitting the molded securing knob from the bottom of the base unit.
  - Ensure the stand body is completely interlocked with the base unit.
  - Insert the screw to the stand body and lock it into position by turning it clockwise. Loosen the height adjustment knob to extend the extension tube to the required height and then tighten the securing knob.
- Mount the fan blade onto the motor shaft; fasten the blade knob by turning anti-clockwise firmly.
- Installing the front guard:
  - Open the front guard clip and attach the hook to the rear guard.
  - Push the round edges of front guard to fit it securely into the rear guard.
  - Lock the clip.

# OPERATING INSTRUCTIONS

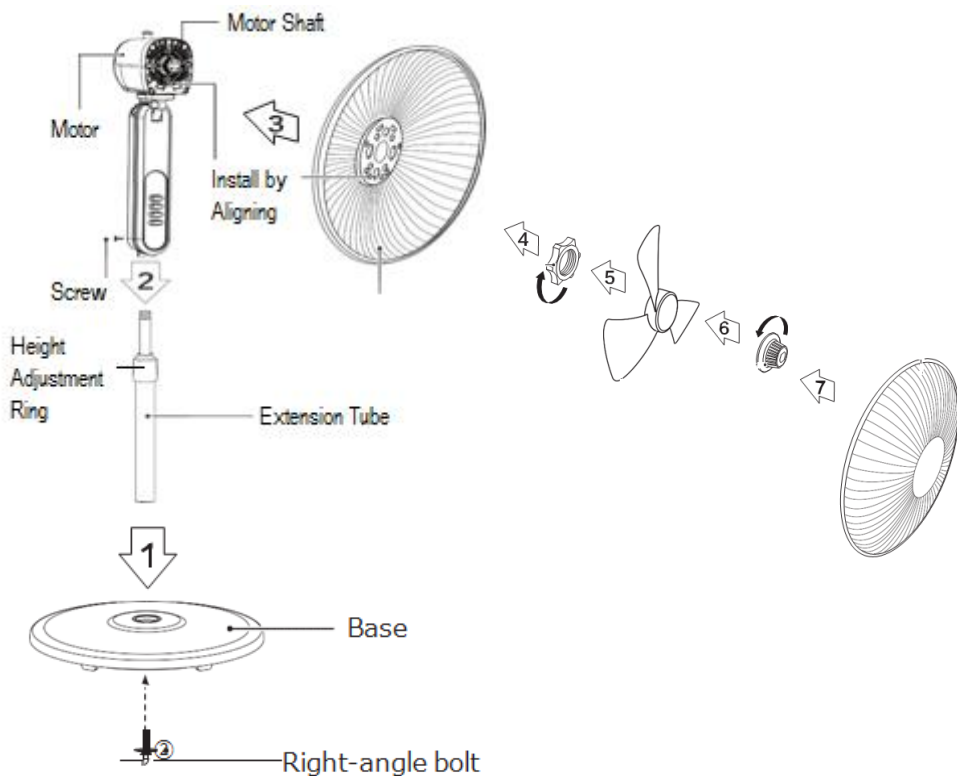

## Base Installation

Align the column with the groove on the base and fix them together using a right-angle bolt.



# OPERATING INSTRUCTIONS

## ■ Instructions for operation of body

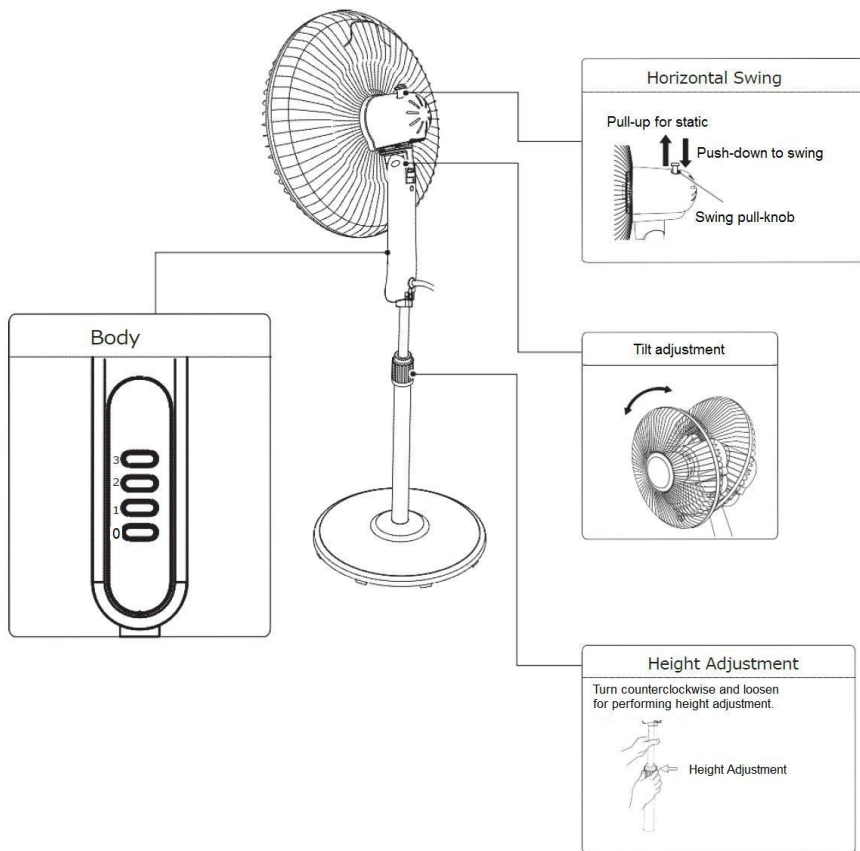

# OPERATING INSTRUCTIONS

- Connect the plug into a power supply socket and switch on the power.
- Switch on the fan by pressing the speed button at any of the “3”, “2” or “1” settings.
- Turn the “3”, “2” or “1” button to adjust the fan speed from High-Medium-Low.
- To stop the fans, turn the speed knob to the “OFF” position.
- To tilt the fan, always ensure that the fan is at ‘OFF’ position and wait until the blade has completely stopped for safety reasons. Hold the stand firmly with one hand and move the guard gently upwards or downwards.
- The oscillation knob is positioned at the top of the rear motor. Press the knob down to make the fan oscillate and pull it up to stop the oscillation.
- To adjust the height of fan, always ensure that the fan is at off position and wait until the blade has completely stopped for safety reason. Hold the stand firmly and loosen the height adjust knob, then push up or pull down the extension tube to adjust the fan height.

# CARE AND CLEANING

- Always unplug the appliance first before cleaning!
- Never immerse the main body in water or other liquids, clean it with a damp cloth.
- Wipe the surfaces of the fan and base with a soft damp cloth.
- Never use any corrosive cleaning solution.
- Do not allow the motor or other electrical components to be exposed to water.
- For proper storage, always place the appliance in a low humidity environment.



 **Mórgan®**

Market Expansion  
Services by  
[www.dksh.com](http://www.dksh.com)



**DKSH**

E-mail: [electrical.appliance@dksh.com](mailto:electrical.appliance@dksh.com)  
[www.morgan.my](http://www.morgan.my)