

 **Mórgan®**

 **Mórgan®**



E-mail: electrical.appliance@dksh.com
www.morgan.my

 facebook.com/morganappliances

USER MANUAL

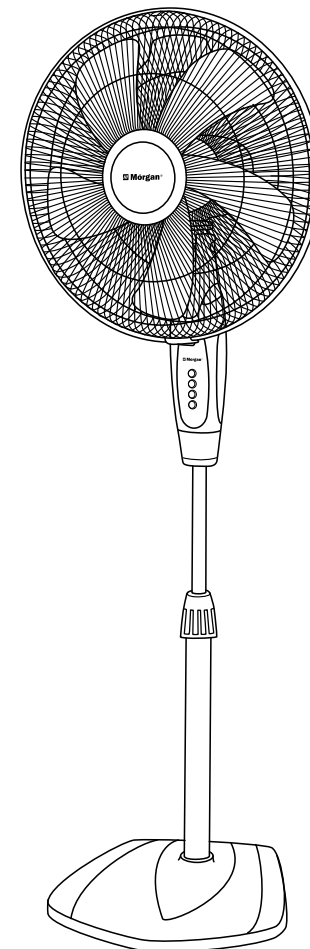

Stand Fan

MSF-16P1
MSF-18P1

C O N T E N T S

3 Parts Identification

3 Specifications

4 Safety Precautions

5 Assembly Instructions

5 Operation Instructions

6 Care & Cleaning

6 Trouble Shooting

PARTS IDENTIFICATION

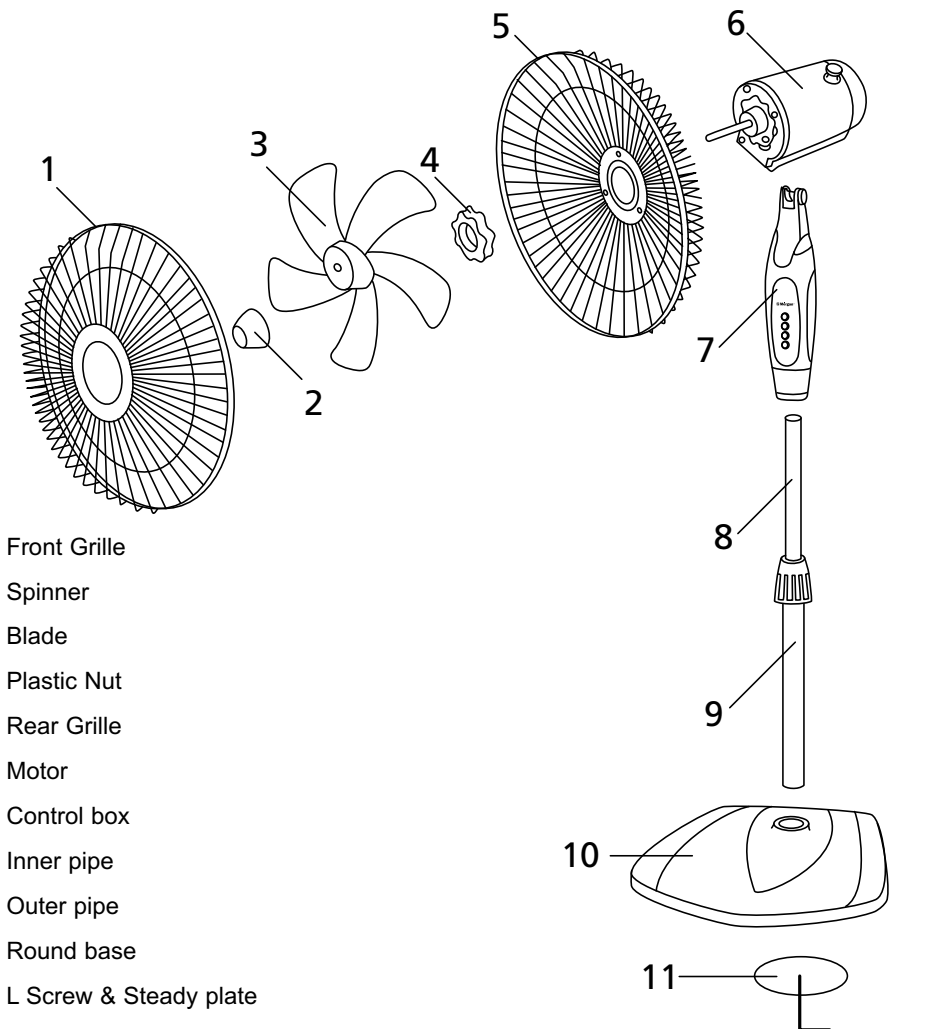

SPECIFICATIONS

MODEL	MSF-16P1	MSF-18P1
RATED VOLTAGE / FREQUENCY	220-240V~ 50/60Hz	
RATED WATTAGE	55W	85W
SIZE	40CM	46CM

SAFETY PRECAUTIONS

Thank you for purchasing another quality Morgan product. We seek to excel by designing products with innovation, quality and safety of our customers in mind:

- Do not use outdoors. Your appliance is solely intended for household use only.
- Do not operate the appliance if power cord or power plug is damaged. It must be replaced by the manufacturer or its service agent or a similarly qualified person in order to avoid any hazards.
- Never leave the appliance within reach of children without supervision. The use of this appliance by young children or the physically challenged must always be supervised.
- Unplug the fan before cleaning, transportation and after you have finished operating the fan.
- Never immerse the appliance, the power cable or the power plug in water or in any other liquids. Never spray liquids onto fan.
- Deformation or operational failure may occur when the appliance is used on unstable surfaces or close to places with heating sources.
- Avoid contact with moving parts.
- Do not operate in the presence of explosives or flammable fumes.

NOTE

- Always ensure fan is properly fitted before use.
- The use of attachments not recommended by the manufacturer may be hazardous.
- Always use on a dry, flat surface.
- If appliance malfunctions or has been damaged in any manner, do not attempt to repair this appliance yourself but return it to the agent for examination, repair or adjustment.

ASSEMBLY INSTRUCTIONS

ASSEMBLY OF BASE & PIPE

1. Insert the outer tube to the base and place the steady plate under the base using the locking screws provided to tighten them as shown.
2. Unscrew the height adjustment knob and pull up the inner tube to adjust the height. Ensure that the knob is fully tightened before proceeding.
3. Position the fan body as shown. Loosen the tightening screw on the fan body and insert the fan body onto the compensation tube. Re-tighten the screw.

ASSEMBLY OF BLADES AND GRILLES

1. Unscrew the spinner clockwise and the plastic nut counter-clockwise. Then remove the plastic sleeve around the motor shaft.
2. Set the rear grille in proper position with the handle facing upwards.
3. Screw on the plastic nut tightly to attach the fan grille.
4. Discard sleeve on shaft.
5. Slide the blade onto the shaft until it contacts the retaining pin.
6. Screw the spinner onto the motor shaft in a counter-clockwise direction.
7. Loosen the screw on the plastic ring with a screw driver. Mount the front grille (logo place in the proper direction) with the rear grille and fasten the plastic ring.

OPERATING INSTRUCTIONS

1. Ensure switch is in the "OFF" position before plugging in the power plug.
2. Adjust fan speed by using the speed selector.
3. To change the angle of the fan, gently tilt the fan head upwards or downwards.
(CAUTION: Ensure that the fan is not in operation).

CARE & CLEANING

1. Unplug fan and remove the front guard.
2. Wipe blades using a soft, damp cloth. Allow to dry. If necessary, use a soft brush to remove dust from tie guards.
3. Reassemble fan completely before use. The motor bearings are permanently sealed and do not require additional lubrication.

TROUBLE SHOOTING

PROBLEM	SOLUTION
No oscillation	Check if oscillation knob is depressed
Not functioning	Check power plug, ensure that power is switched on and Speed selector is turned to either one of the three speeds.
Noisy	Ensure that the fan blade is properly inserted into shaft pins. Ensure that plastic nut for rear grille is tightened. Ensure fan blade knob is securely tightened. Ensure fan grille ring is securely tightened.