



Market Expansion  
Services by  
[www.dksh.com.my](http://www.dksh.com.my)



**DKSH**

E-mail: [electrical.appliance@dksh.com](mailto:electrical.appliance@dksh.com)  
[www.morgan.my](http://www.morgan.my)

[facebook.com/morganappliances](https://facebook.com/morganappliances)

## USER MANUAL

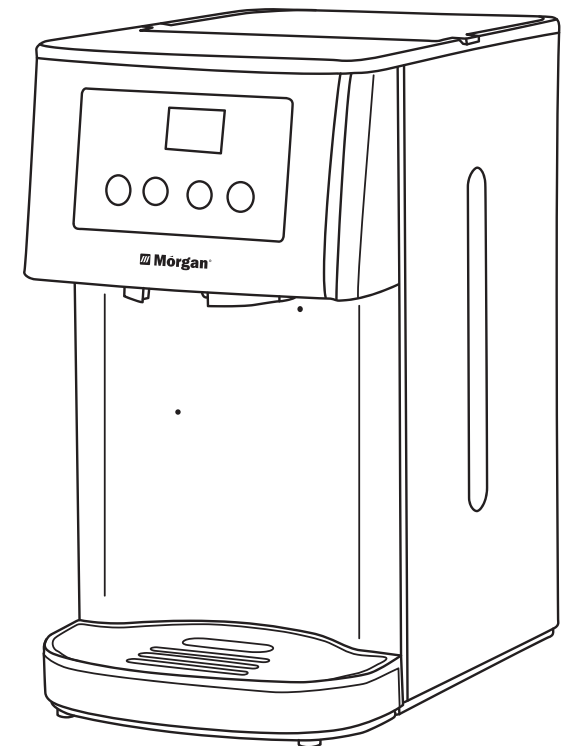

# Instant Boiler

**MIB-6618SS**

## OPERATING INSTRUCTIONS

Open the drainage stopper after cleaning the appliance in order to remove any water residuals.

**NOTE:** Tighten the drainage stopper after opening it.

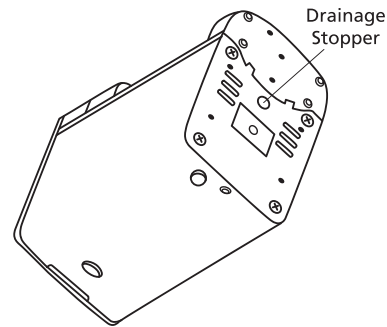

### 3. DISPOSING WATER FROM THE DISPENSER DRIP TRAY

To dispose water when the dispenser drip tray is full, use one hand to firmly grasp and stabilize the appliance by one hand and another hand to lift up the dispenser drip tray slightly to remove it. Proceed to empty water inside the dispenser drip tray insert it into its proper place.

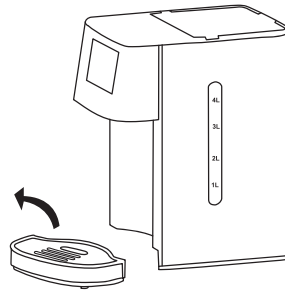

Thank you for purchasing a quality MORGAN Instant Boil Water Dispenser. We trust that you will have a pleasant experience with your new product. To guarantee safety and best efficiency, please read this manual carefully and keep a copy for future reference.

## PARTS IDENTIFICATION

1. Top Cover
2. Control Panel
3. Lamp
4. Water Spout
5. Main Body
6. Dispenser Drip Tray
7. Lid
8. Tank
9. Water Level Indicator
10. Base

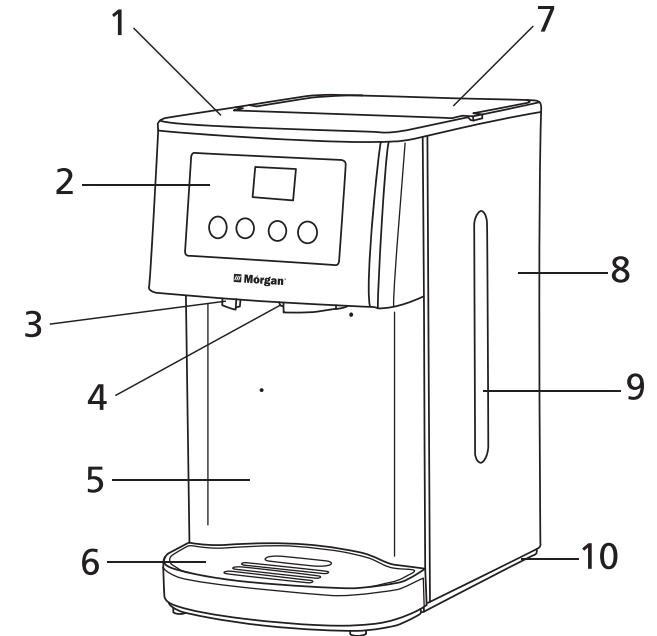

## SPECIFICATIONS

|                           |                   |
|---------------------------|-------------------|
| RATED VOLTAGE / FREQUENCY | 220-240V~ 50/60Hz |
| RATED WATTAGE             | 2200-2600 W       |
| CAPACITY                  | 4.0 L             |

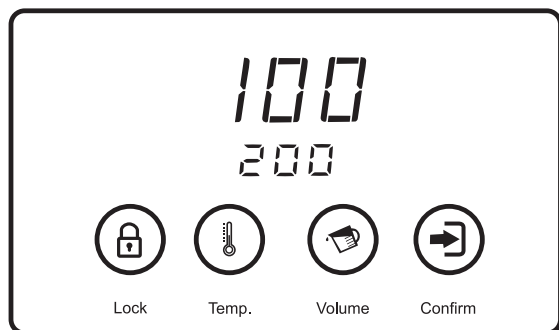

## CONTROL PANEL

**LOCK button:** press and hold for 3 seconds to unlock. The system will automatically lock down if there is no further activity within 10 seconds. To unlock the control panel, press and hold the lock button again.

**TEMP button:** Set the desired temperature according to 45°C, 55°C, 65 °C, 75 °C, 85°C, 100°C, and 000 (normal temperature water)

**VOL. button:** Set the water volume according to 100ml, 200ml, 300ml, and 000(flow water continuously)

**Comfirm button:** Start and stop function settings

## FIRST TIME USE

Clean the water tank thoroughly before use. Always unplug the power plug from the power supply and allow the appliance to cool down completely before carrying out cleaning and maintenance. Wipe the surface of the appliance with a damp cloth and polish with a soft dry cloth.

## 1. FILLING WATER

Open the lid, fill the water tank with the desired amount of water, and then close the lid.

**NOTE:** the water level must not exceed the "MAX" level nor should it be below the "MIN" level.

**NOTE:** It is recommended to discard any remaining water inside the water tank.

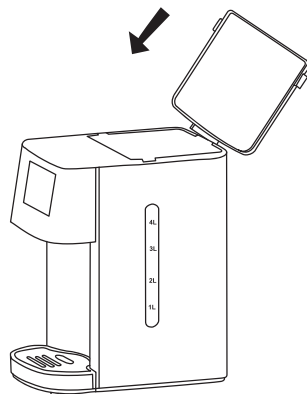

## 2. FILL WATER

- Ensure that the power plug is connected to the power supply, and fill in the water with desired amount.
- Place a cup on the dispenser drip tray, aligning with the spout.
- Press and hold the LOCK button for about 3-5 seconds. The TEMP and VOLUME setting indicator will illuminate.
- Press the TEMP button to choose your desired temperature and press the VOL. button to set the desired water volume.
- Press the COMFIRM button to operate the appliance, and in about 5-10 seconds, the desired water will flow out continuously from water spout.
- Press the COMFIRM button again to stop operating the appliance (If you want to stop the water).
- Repeat the above procedure to dispense water once more.

**NOTE:** When using for the first time, select 000 temp. and 000 vol., and keep water running for 3 seconds.

## IMPORTANT!

1. Exercise extreme caution! Boiled water and steam is extremely hot!
2. If the appliance stops operation when an alarm sounds and the control panel displays an E7 symbol, it shows that there is insufficient water inside the water tank. Replenish water into the water tank immediately.
3. The appliance is able to memorize the last used operation without disconnecting power.
4. As the appliance has a memory function when connected to the power supply, operate the appliance for about 60 seconds to obtain desired temperature water, otherwise its memory will be erased upon unplugging.
5. As ambient temperature changes every day, the water volume will vary within -15% to +15%
6. This appliance features a manual thermostat cut-off to protect it in the event of overheating or a malfunction. You can reset the thermostat by using a reset key easily.

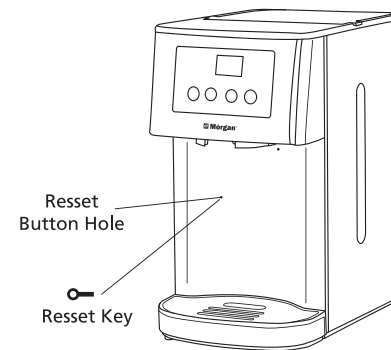

# C O N T E N T S

- 3** Parts Identification
- 3** Specifications
- 4** Operating Instructions
- 7** Cleaning and Maintenance

## CLEANING AND MAINTENANCE

1. Always switch off and unplug your appliance from the power supply and allow it to completely cool before cleaning and maintenance.
2. Do not immerse the appliance into water or any other liquids to avoid damaging it.
3. To maintain optimal performance, it is recommended to descale the appliance periodically. Use only toxic free descaler such as citric acid. Add citric acid into water proportionately. Boil and reboil water three (3) times to completely remove the limescale. Discard any remaining water during descaling.
4. Do not use any chemical, metal, wood or abrasive cleansing agents to clean the appliance housing. Always use a damp cloth.
5. Always handle the appliance with care. Avoid placing it near the edge of the table and counter tops to protect against deforming or damaging the appliance in case it accidentally topples over.

### STORAGE

If the appliance is not going to be used for a long duration, clean and unplug it from the power supply and place it back into its original packing box to prevent humidification or damage to the electrical components.



**Environment friendly disposal**