

 **Mórgan[®]**

 **Mórgan[®]**

Market Expansion
Services by
www.dksh.com



DKSH

E-mail: electrical.appliance@dksh.com
www.morgan.my

 [facebook.com/morganappliances](https://www.facebook.com/morganappliances)

USER MANUAL

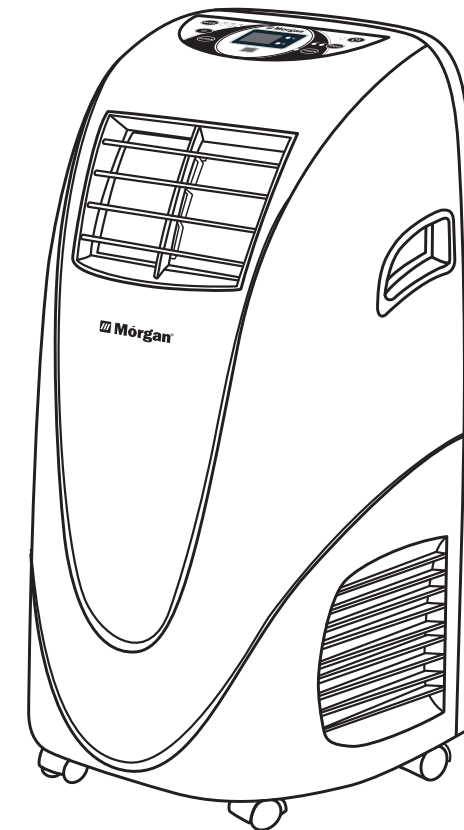

Portable Air Conditioner

MAC-96PA



C O N T E N T S

4 SAFETY

5 INSTALLATION

6 PARTS IDENTIFICATION

7 CONTROL PANEL

8 OPERATING INSTRUCTIONS

9 WATER DRAINAGE

9 MAINTENANCE

10 TROUBLESHOOTING



SAFETY

READ THESE INSTRUCTIONS CAREFULLY BEFORE USING THIS APPLIANCE.

- This appliance is strictly for domestic and indoor use only and should be operated in the way indicated in these instructions. Never use for any other purposes.
- Do not use the appliance outdoors and always place it in a dry environment.
- Inspect the power cord from time to time. Never use the power cord, power plug or the appliance when they indicate any sign of damage. The power cord length of this appliance has been selected to reduce the risk of possible injuries.
- Do not use this appliance with an extension cord unless it has been thoroughly checked and tested by a qualified electrician or electrical supplier.
- Keep the appliance away from heat sources and direct sunlight.
- Always switch off the appliance before unplugging it.
- Unplug the appliance before cleaning or changing any parts of the appliance or when it is not in use.
- Clean the appliance according to the instruction manual.
- Ensure that the voltage rating on the power ratings plate corresponds to your main voltage. Any error in connecting the appliance invalidates the warranty.
- Do not allow young children or physically challenged persons to operate this appliance.
- Never leave the appliance unsupervised when in use. Switch off the appliance if you have to go away for even a short time.
- Never yank the power cord to unplug especially when you have to move the appliance.
- Never immerse the appliance in water or any other liquids for any reason.
- Keep the appliance away from water or oil splashes.
- Follow the instructions carefully for cleaning.
- Do not insert sharp metallic objects or fingers in the air swinging fins of the appliance.
- Never repair the appliance yourself. All unauthorized modifications or repairs made by an unqualified person can be dangerous. The changing of the power cord must also be performed by a qualified electrician.
- Never use accessories that are not supplied or not recommended by the manufacturer.. This can be hazardous and could damage the appliance.

SPECIAL RECOMMENDATIONS

- Install the portable air conditioner on a flat surface with good ventilation and without obstacles. Leave a 50cm minimum space between the unit and the wall.
- Ensure that the power plug is always accessible after its installation.
- Always place the appliance in a vertical position in order to maintain the compressor in good working condition.
- Do not use the appliance near any gas sources or other inflammable liquids.
- Do not block the air outlet and inlet ventilation.
- Do not use any liquid solvents or sprays (insecticides, painting) or any other inflammable products near the appliance as the outer plastic body may be deformed and the unit may also sustain electrical damage.

POWER SOURCES

- The power plug has to be well installed and should not be damaged in any manner.
- Do not plug in the appliance with a power adaptor.
- Plug into the wall socket before switching on the appliance then press on the ON/OFF button.

THE MANUFACTURER WILL NOT ASSUME ANY RESPONSIBILITY IN CASE OF NON-ADHERENCE TO THESE INSTRUCTIONS. KEEP AND STORE THIS USER MANUAL CAREFULLY.

INSTALLATION

SELECTION OF INSTALLATION LOCATION

1. Place the unit on a flat surface and dry place.
2. Leave at least 50cm space all around the unit.



INSTALLATION

1. Install the exhaust pipe into the adapter, and then install the other side of the exhaust pipe into the air outlet vent of the unit. (anti-clockwise)
2. Install the adapter into the window slider kit, and then half open the window to meet the width of the window slider kit. The length of the window slider kit is adjustable.

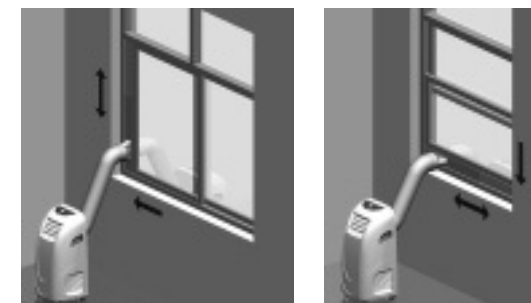

INCORRECT MOUNTING

1. The bend of the exhaust pipe is very important. Incorrect mounting can prevent the machine from working correctly.
2. Take care to prevent any sharp bows or bends of the exhaust pipe.
3. The exhaust air must flow freely.

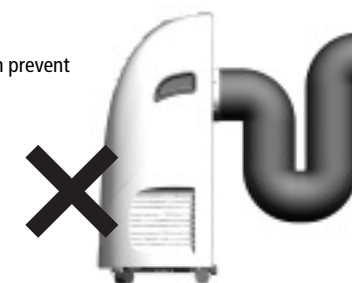

WARNING

1. The length of the exhaust pipe is specially designed according to the specification of this appliance. Do not replace or extend it with a non-recommended hose as this could cause serious malfunction.

ATTENTION: Maximum developed length of the exhaust pipe is 1500mm. Use the shortest possible length. When mounting, it is advisable to keep the exhaust pipe in a horizontal position.

PARTS IDENTIFICATION

FRONT

1. Control panel
2. Display
3. Buttons
4. Remote control receiver
5. Air outlet vent
6. Louver
7. Castor
8. Remote Control
9. Handle

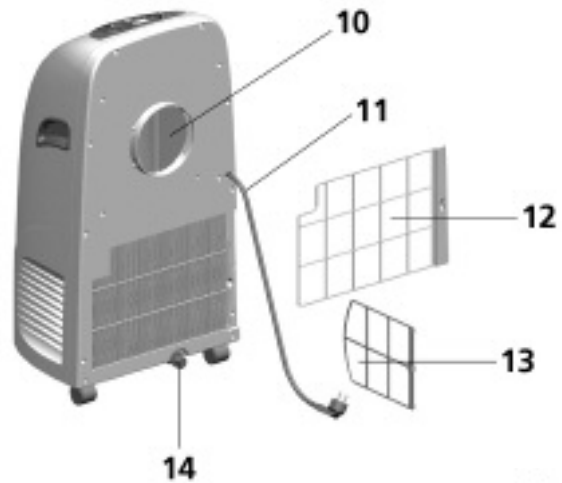
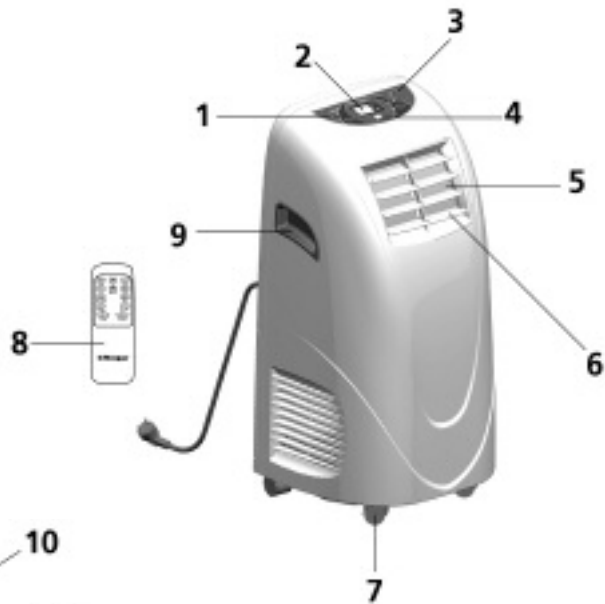

BACK

10. Exhaust air outlet vent
11. Power cord
12. Primary filter
13. Secondary filter
14. Drainage outlet

Inspect all the accessories included in the package and refer to the installation instructions for their proper usage.

ACCESSORIES

15. Exhaust pipe
16. Adapter
17. Window slider kit A
18. Window slider kit B

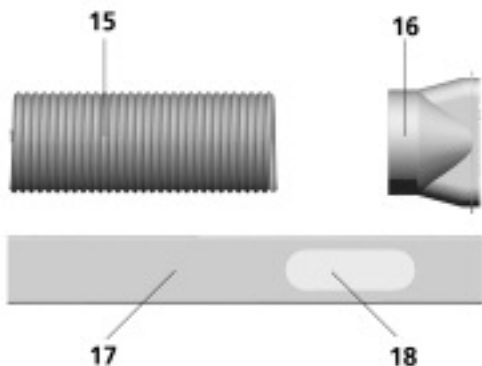

6

CONTROL PANEL

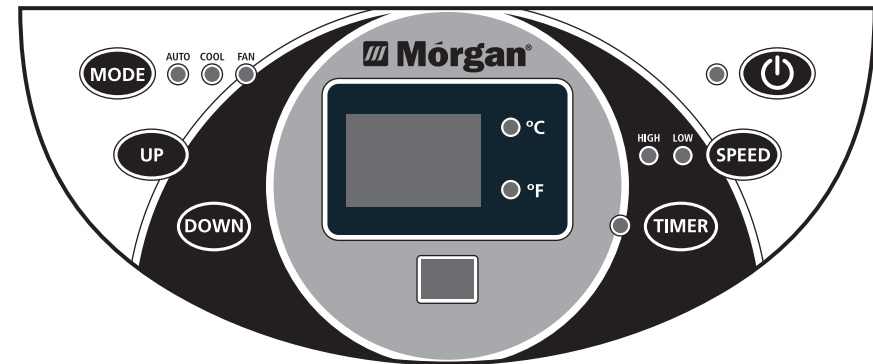

1. **POWER BUTTON:** press this button to turn on/off the unit.
2. **MODE BUTTON:** press this button to select Cooling, Automatic Adjusting Mode or Fan Mode
3. **SPEED BUTTON:** press this button to select between high or low fan speeds.
4. **TIMER BUTTON:** Press this button during standby to set automatic standby time on. Conversely, press the same button during operation to set automatic time off.
5. **UP BUTTON:** press this button to set the temperature higher when cooling; press this button to adjust time longer when timing; to exchange Fahrenheit and Celsius when press both UP and Down button
6. **DOWN BUTTON:** press this button to set the temperature lower or higher when cooling; press this button to adjust time shorter or longer when timing; to exchange Fahrenheit and Celsius when press both UP and Down button.

REMOTE CONTROL

1. Power
2. Celsius and Fahrenheit exchange button
3. Fan button
4. Cool mode Button
5. Auto mode button
6. Down button
7. Up button
8. High fan speed button
9. Low fan speed button
10. Max cool button
11. Sleep mode
12. Timer button

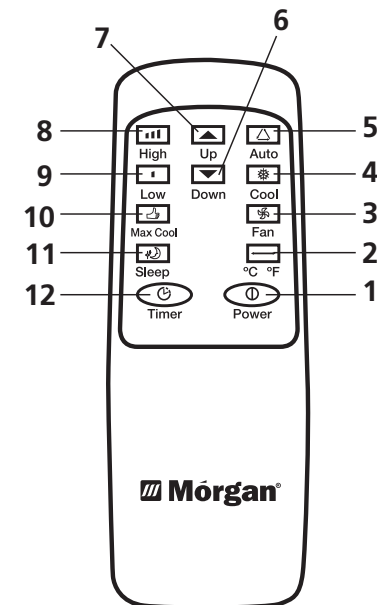

7

OPERATING INSTRUCTIONS

COOLING MODE

This is the default Cool mode when operating the appliance. Press 'Mode' button to select Cool modes, the Cool mode indicator will flash.

- Press UP or DOWN button to set room temperature between 17°C to 30°C.
- Press FAN SPEED button (or High/Low button) to select high, low fan speed.

FAN MODE

- Press Fan button to select Fan modes, the Fan mode indicator will flash.
- Select the fan speed by pressing SPEED button or pressing High / Low button directly.
- The temperature cannot be set.

AUTOMATIC MODE

- Press Mode button to select the automatic mode. Automatic mode indicator will flash. After choosing the automatic mode, the operation will depend on room temperature. When room temperature is higher than 25°C, it will automatically adjust into cool mode. If temperature is below 25°C, it will be fan mode. You can select the fan speed mode and timer mode when it is under automatic adjusting mode.

SLEEP MODE (Available on remote control only)

- Press this button to activate or cancel sleep mode function in cooling mode. The unit will operate at low fan speed as default with reduced noise level. The setting temperature will increase 1 degree per 2 hours during operation, and it will not change after increasing 2 degrees.

MAX COOL MODE (Available on remote control only)

- Press this button to activate the Max Cool mode. The unit runs cool but is not restricted by the temperature under the Max Cool mode. The unit is forced to operate in high fan speed under the Max Cool mode and the fan speed cannot be altered.

TIMER MODE

- When the appliance is switched off, press Timer button to set timer-on.
- Press Up or Down button to adjust time from 0 to 24 hours. The Timer on indicator will flash.
- When the appliance is in operation, press Timer button to set timer-off.
- Press Up or Down button to adjust time from 0 to 24 hours. The Timer off indicator will flash.

WATER DRAINAGE

This appliance has a self-evaporative system. The condensing water will be recycled to cool the condenser. This not only improves cooling efficiency, but also saves energy.

- If the water inside is full, the display panel will display "FL", and the compressor will stop operating.
- Turn the machine off and move the appliance to a place where water can be drained. Unplug the water discharge outlet. After drainage, you can power it on and the appliance will operate as before.

MAINTENANCE

Note: Turn off the unit and unplug it from the power supply before commencing any maintenance or repair to avoid risk of electric shock.

CLEANING

- Unplug the unit before commencing any cleaning/maintenance work.
- Clean the exterior housing with a soft moist cloth. Do not use chemical solvents (such as benzene, alcohol, gasoline) to avoid damaging or deforming the exterior body.
- Do not sprinkle water on the unit.

AIR FILTER

- Clean the air filter once every 2 weeks. If the air filter is clogged with dust, the operational efficiency of the appliance will be affected.
- Open the air filter cover upwards, and proceed to remove the air filter.
- Wash the air filter by immersing it gently into warm (about 40°C) water using a neutral detergent. Rinse and allow to dry thoroughly in a shaded place.

END OF SEASON

- Please drain the water.
- Keep the appliance running in Fan mode for two hours until the interior of the unit is completely dry.
- Turn off the appliance and unplug from the power supply.
- Clean the air filter and after dry it thoroughly, reinstall it.
- Remove the exhaust pipes and keep them carefully.
- Wrap the unit with the plastic bag and store in a cool, dry place.

TROUBLESHOOTING

Before contacting professional service, check it first yourself referring to the followings:

PROBLEM	CAUSE	SOLUTION
The air conditioner does not function.	No power supply.	Connect to power supply and switch on.
	"FL" flashes on the display screen	Drain water.
	Timer-off is in operation.	Turn on the unit three minutes later.
The air conditioner restarts frequently	Unit is placed under sunlight.	Close curtains.
	Windows or doors open, too many people or a heat source is in the room.	Close doors and windows, remove the heat source.
	Dirty/Clogged filter.	Clean or replace the filter(s).
	Air inlet or air outlet blocked.	Remove the blockage.
The unit is too noisy	Unit stands uneven.	Place on an even, solid surface (less vibration).
Compressor not operating	Compressor shuts down to protect from power surge	Wait for 3 minute and restart again after the temperature descends.

CAUTION

- **Switch off the unit and unplug it immediately if anything abnormal happens. Then contact a qualified electrician.**
- **The manufacturer reserves the right to alter/modify data without advance notice for product improvement.**