

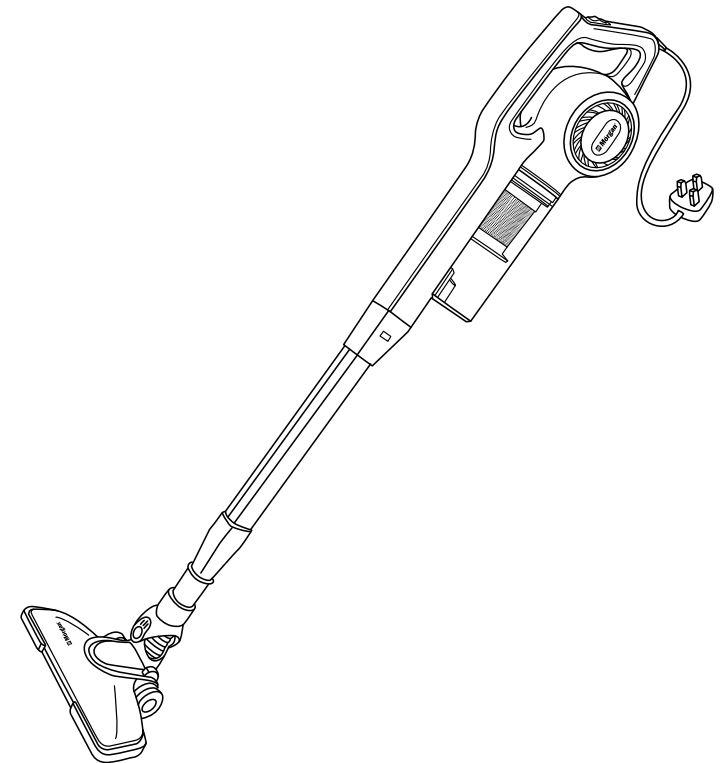

USER MANUAL



2 in 1 Stick/ Handheld Vacuum Cleaner

MVC-P60



Market Expansion
Services by
www.dksh.com.my



E-mail: electrical.appliance@dksh.com
www.morgan.my

facebook.com/morganappliances

C O N T E N T S

3 Important Safeguards

4 Parts Identification

4 Specifications

5 Operating Instructions

7 Troubleshooting

7 Care & Cleaning

Thank you for purchasing a quality MORGAN appliance. We trust that you will have a pleasant experience with your new product. To guarantee safety and best efficiency, please read this manual carefully and keep a copy for future reference.

IMPORTANT SAFEGUARDS

Please read this instruction manual carefully and keep it in a safe place for future reference.

- Remove all packing materials from this product before use.
- Ensure the voltage indicated on the product rating label corresponds to the local power supply voltage before operating the appliance.
- Always inspect the appliance before operating for the first time.
- Never operate the appliance with a damaged power cord / plug or after a malfunction or if it has been dropped or damaged in any manner.
- Do not vacuum the following to avoid damaging the appliance or prevent a fire hazard.
 - Burning or smoking substances such as hot charcoal, burning cigarette and more.
 - Flammable and explosive products such as gasoline and alcohol.
 - Sharp fragments such as glass, construction materials, nails and so forth.
 - Water, chemicals and corrosive liquids.
- Disconnect the power cord from the power supply when cleaning, repairing or when appliance is not in use. Remember do not immerse the main vacuum cleaner in water, avoid approaching to heating equipment or exposure to the sun to avoid fire.
- This appliance may be used by children aged 8 years and above and persons whose physical, perceptive or mental skills are impaired or who are inexperienced or not knowledgeable about the appliance as long as they are supervised or informed and made aware of the safe use of the appliance and the encountered dangers.
- Children should not be allowed to play with the appliance.
- Cleaning and user maintenance should not be performed by children unless they are supervised by an adult.
- Do not operate the appliance if it has malfunctioned or is damaged in any manner. Contact an authorized service for inspection and repairs.
- Avoid operating the appliance continuously as this may cause the suction inlet to be obstructed. This will generate excessive heat which can damage the motor.
- If the power cord / plug malfunctions or is damaged, use only original parts or parts recommended by the manufacturer.
- When using the appliance, do not cover power cord with throw rugs, runners, or similar coverings. Do not route power cord under furniture or appliances. Exercise caution so the power cord will not be tripped over.
- Always unplug appliance when not in use.

PARTS IDENTIFICATION

1. Main Body
2. On/Off Button
3. Power cord
4. Hepa Filter
5. Stainless Steel Mesh Filter
6. Dust Cup
7. Dust Cup Release Button
8. Connection Tube Button
9. Connection Tube Assembly
10. Swivel Head
11. Rotating Floor Brush
12. Ellipse Brush
13. Crevice Nozzle
14. Connector

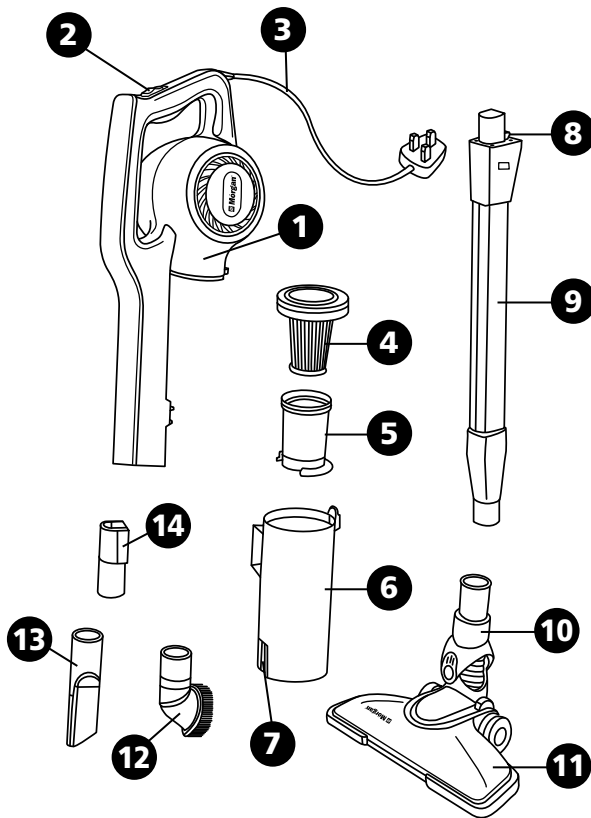

SPECIFICATIONS

MODEL	MVC-P60
RATED VOLTAGE / FREQUENCY	220-240V~ 50/60Hz
RATED POWER	600W
MAX. SUCTION	≥18.0Kpa
DUST BOX CAPACITY	0.9L

OPERATING INSTRUCTIONS

AS AN UPRIGHT VACUUM CLEANER

1. Before operating (Figure 1), press the dust cup button to open and ensure that the dust cup is installed with filter screen and HEPA.
 2. Reassemble the dust cup (Figure 2) and turn until a click is heard, indicating that the button is locked.
 3. Insert the metal tube into the main body hole and secure it (Figure 3).
 4. Install the desired brush into the metal tube (Figure 4).
 5. Connect the power plug into the power supply (Figure 5).
 6. Push the ON/OFF button switch in the direction of arrow to begin operation.
 7. Push the button switch back (Figure 6) and the vacuum cleaner stops working.
- Store it upright against the wall.

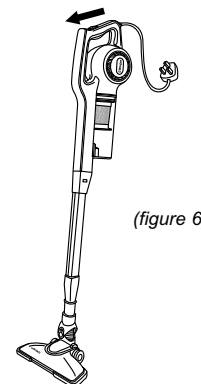
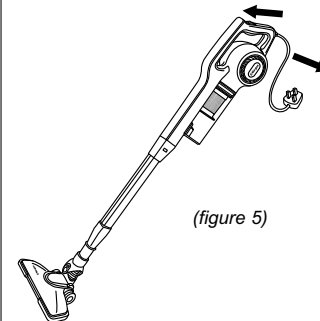
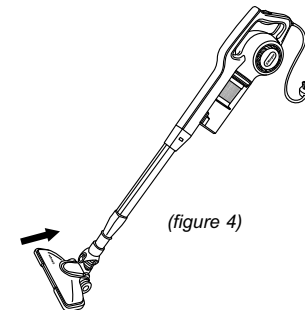
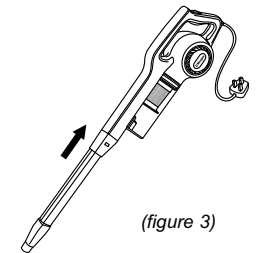
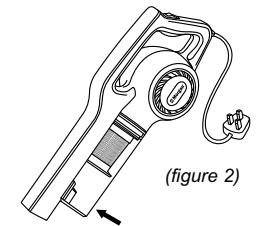
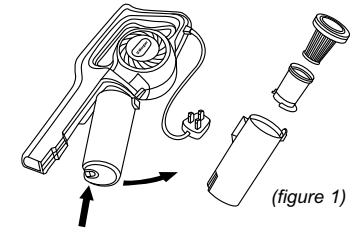

OPERATING INSTRUCTIONS

AS A COMPACT VACUUM CLEANER

1. Press the connection tube button to detach it from the main body. (Figure 1).
2. Install the adapter (Figure 2).
3. Insert the crevice nozzle into the adapter and secure it (Figure 3).
4. Insert the power plug into the power supply and push the button switch in the direction of the arrow to begin operation (Figure 4).
5. Push the button switch back to stop the appliance (Figure 5).
6. Press the dust cup button (Figure 6) to detach the dust cup component.
7. Detach the strainer (Figure 7) from the dust cup and discard contents.
8. Detach the HEPA filter and discard contents (Figure 8).

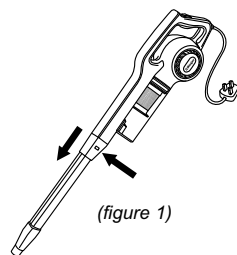

(figure 1)

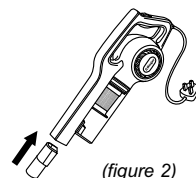

(figure 2)

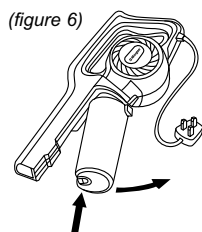

(figure 6)

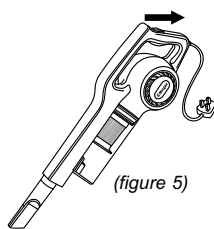

(figure 5)

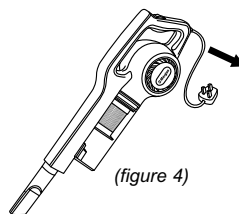

(figure 4)

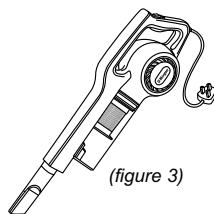

(figure 3)

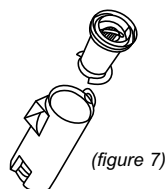

(figure 7)

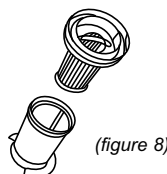

(figure 8)

TROUBLESHOOTING

Please perform these troubleshooting before sending the appliance to the service center.

PROBLEM	POSSIBLE CAUSES	SOLUTIONS
Motor not working	<ul style="list-style-type: none"> • Ensure power plug is connected securely to the power supply. • Ensure there is power. • Ensure power switch is turned on. 	<ul style="list-style-type: none"> • Connect power plug into the power supply again. • Ensure power supply is in good working order. • Power on.
Low suction power	<ul style="list-style-type: none"> • Inspect whether air inlet is obstructed with dirt. • Check if the dust box is full. • Check if the filter is obstructed. 	<ul style="list-style-type: none"> • Remove obstruction. • Empty the dust box. • Clean the filter.

CARE & CLEANING

- The main unit and tube can be washed with a soft cloth with water. The dust box and floor nozzle can be washed with running water.
- Note: Do not use alcohol or gasoline.**
- Filter: Not intended for wash-machine. Remove dirt and dust from the filter if dirty or when suction power is reduced. Wash with water and allow to dry thoroughly.
- Note: Assemble the filter and cyclone separator back into the dust cup after emptying contents.
- Any other servicing should be performed by an authorized service representative.

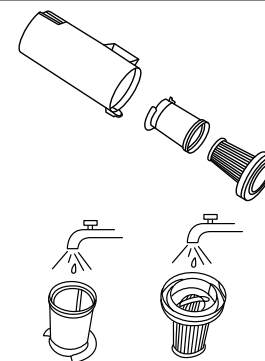

SERVICING OF DOUBLE-INSULATED APPLIANCES

A double-insulated appliance is marked with one or more of the following: The words "DOUBLE INSULATION" or "DOUBLE INSULATED" or the double insulation symbol.

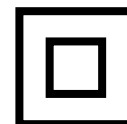

In a double-insulated appliance, two systems of insulation are provided instead of grounding. No grounding means is provided on a double-insulated appliance, nor should a means for grounding be added to the appliance. Servicing a double-insulated appliance required extreme care and knowledge of the system, and should be done only by qualified service personnel. Replacement parts for a double-insulated appliance must be identical to the parts they replace.

POLARIZATION INSTRUCTIONS

To reduce the risk of electric shock, this appliance has a polarized plug (one blade is wider than the other). This plug will fit in a polarized outlet only one way. If the plug does not fit fully in the outlet, reverse the plug. If it still does not fit, contact a qualified electrician to install the proper outlet. Do not modify the power plug in any way.