

 **Mórgan[®]**

USER MANUAL

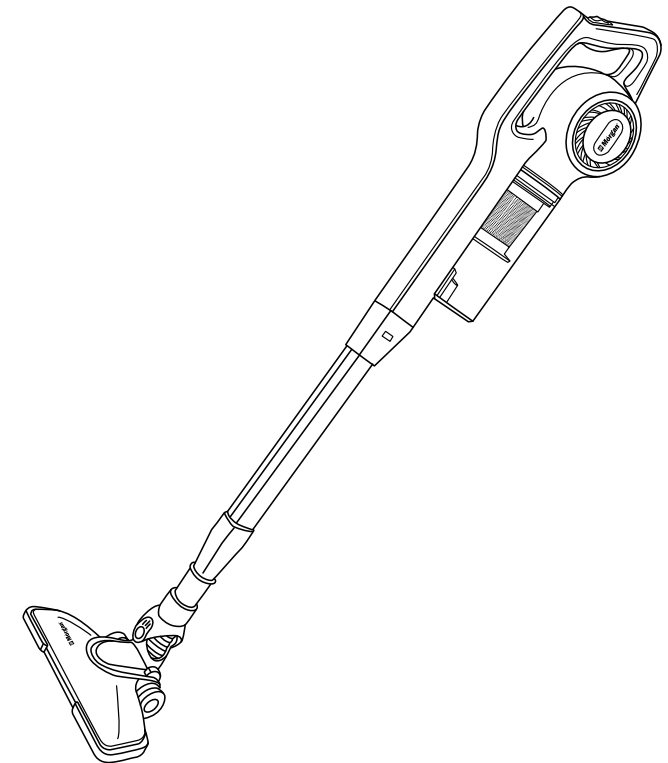

Cordless 2 in 1 Stick/Handheld Vacuum Cleaner

MVC-CP15

 **Mórgan[®]**

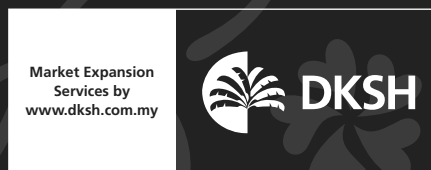

E-mail: electrical.appliance@dksh.com
www.morgan.my

 [facebook.com/morganappliances](https://www.facebook.com/morganappliances)

Thank you for purchasing a quality MORGAN appliance. We trust that you will have a pleasant experience with your new product. To guarantee safety and best efficiency, please read this manual carefully and keep a copy for future reference.

C O N T E N T S

IMPORTANT SAFEGUARDS

3 Important Safeguards

4 Parts Identification

4 Specifications

5 Operating Instructions

7 Troubleshooting

7 Care & Cleaning

Please read this instruction manual carefully and keep it in a safe place for future reference.

- Remove all packing materials from this product before use.
- Ensure the voltage indicated on the adapter corresponds to the local power supply voltage before operating the appliance.
- Always inspect the appliance before operating for the first time.
- Do not operate the appliance or the adapter if it has been damaged in any manner.
- Do not vacuum the following to avoid damaging the appliance or prevent a fire hazard.
 - Burning or smoking substances such as hot charcoal, burning cigarette and more.
 - Flammable and explosive products such as gasoline and alcohol.
 - Sharp fragments such as glass, construction materials, nails and so forth.
 - Water, chemicals and corrosive liquids.
- Disconnect the power cord from the power supply when cleaning, repairing or when appliance is not in use. Remember do not immerse the main vacuum cleaner in water, avoid approaching to heating equipment or exposure to the sun to avoid fire.
- This appliance may be used by children aged 8 years and above and persons whose physical, perceptive or mental skills are impaired or who are inexperienced or not knowledgeable about the appliance as long as they are supervised or informed and made aware of the safe use of the appliance and the encountered dangers.
- Children should not be allowed to play with the appliance.
- Cleaning and user maintenance should not be performed by children unless they are supervised by an adult.
- Do not operate the appliance if it has malfunctioned or is damaged in any manner. Contact an authorized service for inspection and repairs.
- Avoid operating the appliance continuously as this may cause the suction inlet to be obstructed. This will generate excessive heat which can damage the motor.
- If the power adapter malfunctions or is damaged, use only original parts or parts recommended by the manufacturer.
- It is recommended to charge the appliance once every three (3) months if it is not used frequently. Ensure battery is removed from the appliance body before discarding for further recycling.

WARNING:

- Use only a dedicated adapter for charging. Ensure proper ventilation for optimal heat dissipation.
- Do not operate or store in a high temperature environment above 50°C.
- Battery pack is not detachable

PARTS IDENTIFICATION

1. Main Body
2. On/Off Button
3. Charging Adapter
4. Hepa Filter
5. Stainless Steel Mesh Filter
6. Dust Cup
7. Dust Cup Release Button
8. Connection Tube Button
9. Connection Tube Assembly
10. Swivel Head
11. Rotating Floor Brush
12. Ellipse Brush
13. Crevice Nozzle
14. Connector
15. Indicator Light
16. Charging Port
17. Accessories Hanger

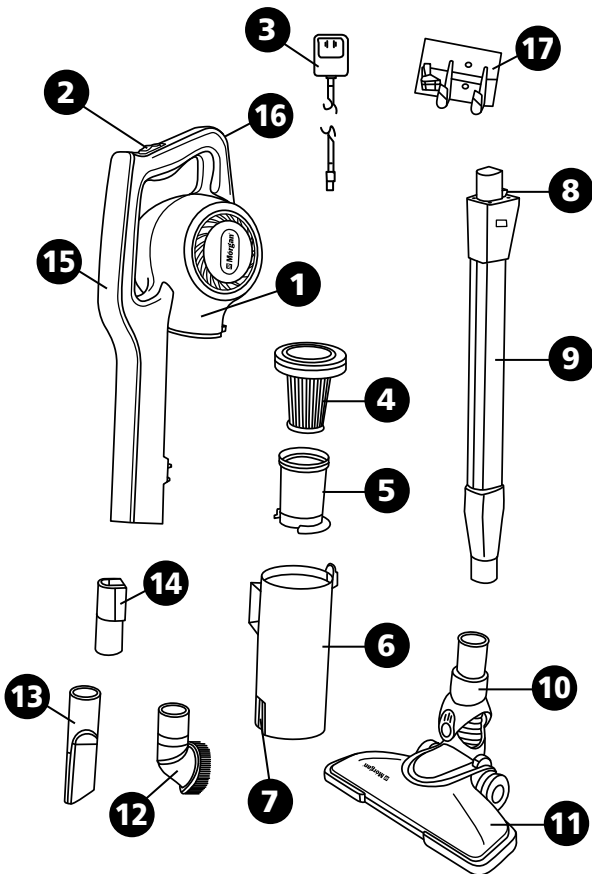

SPECIFICATIONS

MODEL	MVC-CP15
ADAPTER INPUT VOLTAGE	100-240V
INPUT FREQUENCY	50/60HZ
MACHINE OPERATING POWER	120W
HOST OPERATING VOLTAGE	18.5V
MAX. SUCTION	≥11.5Kpa
DUST BOX CAPACITY	0.9L

OPERATING INSTRUCTIONS

AS AN UPRIGHT VACUUM CLEANER

1. Before operating (Figure 1), press the dust cup button to open and ensure that the dust cup is installed with filter screen and HEPA.
2. Reassemble the dust cup (Figure 2) and turn until a click is heard, indicating that the button is locked.
3. Insert the connected button end (Figure 3) into the interlock.
4. Insert the nozzle of the floor brush assembly into the other end of the nozzle and secure it (Figure 4).
5. Push the button switch to the direction of the arrow (Figure 5) to begin operation.
6. Push the button switch back (Figure 6) to stop operation. Store it upright against the wall.
7. Ensure appliance is in OFF position before storing it upright. Connect the power adapter into the power supply and insert into the charging port. (Figure 7)
8. A flashing blue light indicator indicates that the appliance is charging.

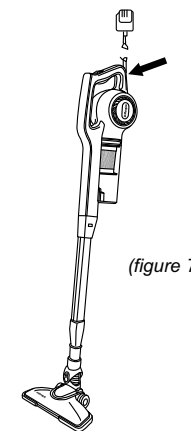
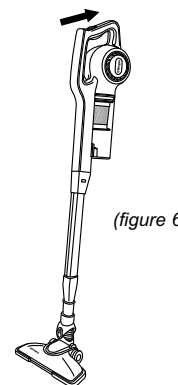
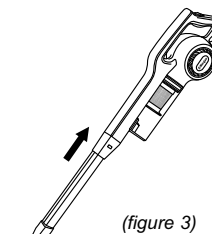
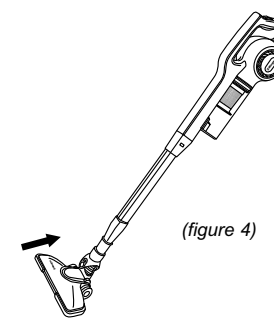
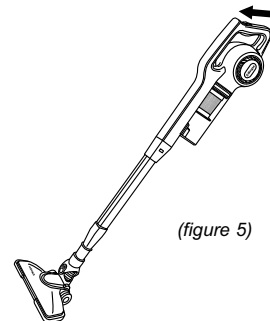
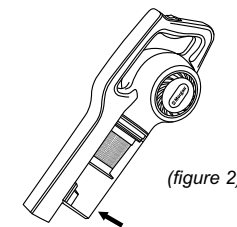
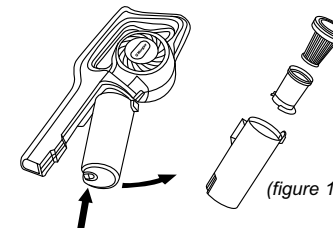

AS A COMPACT VACUUM CLEANER

1. Press the connection tube button (Figure 1) to unplug the connection tube from the main machine.
2. Install the adapter (Figure 2).
3. Insert the flat nozzle suction into the adapter (Figure 3).
4. Push the button switch to the direction of the arrow to operate the appliance (Figure 4).
5. Push the button switch back to stop the appliance (Figure 5).
6. Press the dust cup button (Figure 6) to detach the dust cup component.
7. Detach the strainer (Figure 7) from the dust cup and discard contents.
8. Detach the HEPA filter and discard contents (Figure 8).

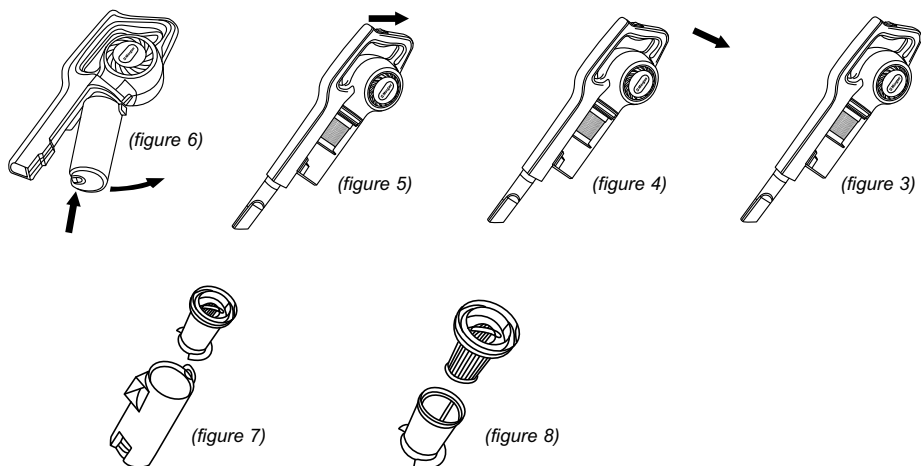
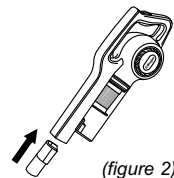
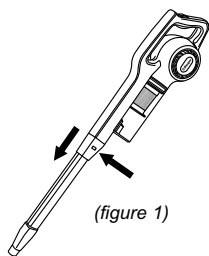

INDICATOR LIGHT NOTIFICATIONS

1. Normal operation: The blue indicator light stays on.
2. Turn off the power: the blue light is off.
3. Low battery: the blue indicator light flashes.
4. Fully charged: The blue indicator light stays on.
5. When charging continuously: the blue indicator light flashes.

Please perform these troubleshooting before sending the appliance to the service center.

PROBLEM	POSSIBLE CAUSES	SOLUTIONS
Low suction power or abnormal noise	<ul style="list-style-type: none"> • Motor is overheating 	<ul style="list-style-type: none"> • Stop operation
Brush or filter block	<ul style="list-style-type: none"> • Check if air inlet is obstructed by dust. • Check if dust box is full. • Check if the filter is blocked. 	<ul style="list-style-type: none"> • Empty the dust box. • Clean the filter.
Appliance not working	<ul style="list-style-type: none"> • Ensure battery still has power 	<ul style="list-style-type: none"> • Charge the battery • Clean the filter & restart the machine

CARE & CLEANING

- The main unit and tube can be washed with a soft cloth with water. The dust box and floor nozzle can be washed with running water.
- Note: Do not use alcohol or gasoline.**
- Filter: Not intended for wash-machine. Remove dirt and dust from the filter if dirty or when suction power is reduced. Wash with water and allow to dry thoroughly.
- Note: Assemble the filter and cyclone separator back into the dust cup after emptying contents.
- Any other servicing should be performed by an authorized service representative.

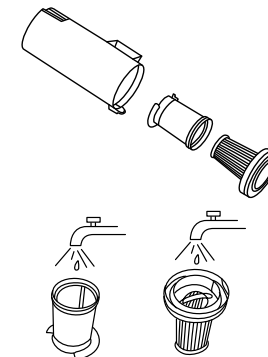

SERVICING OF DOUBLE-INSULATED APPLIANCES

A double-insulated appliance is marked with one or more of the following: The words "DOUBLE INSULATION" or "DOUBLE INSULATED" or the double insulation symbol.



In a double-insulated appliance, two systems of insulation are provided instead of grounding. No grounding means is provided on a double-insulated appliance, nor should a means for grounding be added to the appliance. Servicing a double-insulated appliance required extreme care and knowledge of the system, and should be done only by qualified service personnel. Replacement parts for a double-insulated appliance must be identical to the parts they replace.

POLARIZATION INSTRUCTIONS

To reduce the risk of electric shock, this appliance has a polarized plug (one blade is wider than the other). This plug will fit in a polarized outlet only one way. If the plug does not fit fully in the outlet, reverse the plug. If it still does not fit, contact a qualified electrician to install the proper outlet. Do not modify the power plug in any way.