

Mórgan®

USER MANUAL

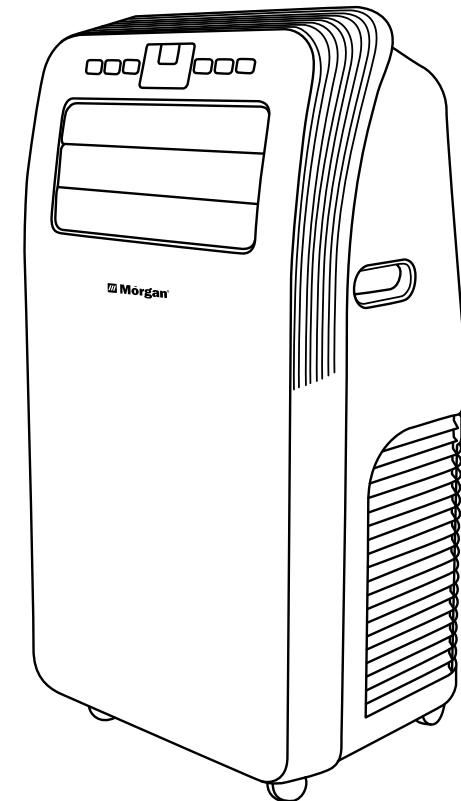

Portable Air Conditioner

MAC-121 SIERRAIRE

Mórgan®

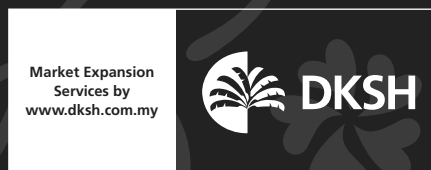

E-mail: electrical.appliance@dksh.com
www.morgan.my

 [facebook.com/morganappliances](https://www.facebook.com/morganappliances)

C O N T E N T S

3	SAFETY PRECAUTIONS
6	SAFETY TIPS
8	SPECIAL REMINDERS
8	SPECIFICATIONS
9	PARTS IDENTIFICATION
10	CONTROL PANEL & REMOTE CONTROL
11	PLACEMENT & INSTALLATION
13	OPERATING INSTRUCTIONS
14	WATER DRAINAGE
14	CARE & CLEANING
15	COMMON ERRORS & DIAGNOSIS
15	TROUBLESHOOTING

Thank you for purchasing a quality MORGAN appliance. We trust that you will have a pleasant experience with your new product. To guarantee safety and best efficiency, please read this manual carefully and keep a copy for future reference.

SAFETY PRECAUTIONS

When using electric appliances, basic safety precautions should always be followed including the following:

- Read all instructions carefully and retain them for future reference.
- Before connecting to the power supply, ensure that the unit is earthed and its voltage corresponds to the voltage indicated on the power supply rating label at the bottom of the appliance.
- Ensure that the appliance's voltage meet the power requirements. Any damage incurred by incorrect power is not included in the warranty.
- Always disconnect appliance from the power supply when not in use, before cleaning or when undertaking maintenance works.
- This machine is for household & indoor use only.
- Do not allow power cord to hang over edge of table or counter or touch hot surfaces.
- Do not operate unit with damaged power cord or power plug or after the unit malfunctions or has been damaged in any manner. In such a situation, it is recommended to return the unit to your nearest Authorized Service Centre for examination, repair, or adjustment.
- It is recommended to use a power extension cable if the power cord is not long enough. However - it is recommended to use a dedicated power socket that is not shared with other electrical appliances.
- Do not bend, twist or place the power cord under stress or under the weight of sharp or heavy objects.
- Never pull or yank the power cord to unplug or when moving the appliance.
- The appliance should be positioned away from heat sources and to avoid direct sunlight.
- Always power off the appliance before unplugging from the power supply.
- Always refer to this manual when carrying out cleaning & maintenance.
- Do not allow children to play with the appliance.
- This appliance is not intended for use by persons (including children) with reduced physical, sensory or mental capabilities, or lack of experience and knowledge, unless they have been given supervision or instruction concerning use of the appliance by a person responsible for their safety.
- NEVER insert fingers or any objects into the air vents while appliance is operating.
- To protect against electric shock, do not immerse power cord, power plug, or any parts of the unit in water or other liquids.
- Do not spray or wash the unit or place it in moist or damp places with close contact with water as doing so may affect the unit's electrical insulation properties.

SAFETY PRECAUTIONS

- Do not attempt modify or repair the appliance yourself. Doing so may damage the appliance and in turn, void the warranty.
- **WARNING:** The use of accessory attachments not recommended by the appliance manufacturer may cause hazard or injury.
- It is recommended to use ambient temperature for the appliance's cooling function in the following temperature range: 16°C-27°C.
- Never allow children to perform cleaning or other user-maintenance operations without direct adult supervision.

SPECIAL WARNINGS

- It is recommended to place the A/C on stable surfaces and install it vertically for best performance.
- The appliance should be placed at least 50cm away from surrounding objects.
- Keep air inlet and outlet vents free from obstructions.
- Do not operate the appliance near gasoline, solvents or any flammable substances as doing so may damage or deform the exterior plastic finishing and electric parts.

POWER

- Ensure the power plug is in good condition for best operation and performance.
- Always plug the power cord first and press the power key to operate the appliance.

SAFETY PRECAUTIONS

This appliance is only intended for household use. Do not use it for other purposes.

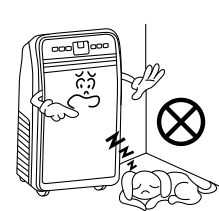

It is intended to be operated inside rooms and dry, warm areas. Do not use it outdoors.

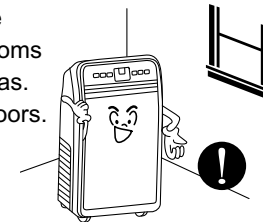

Do not pile objects around the appliance to avoid obstructing optimal air exchange.

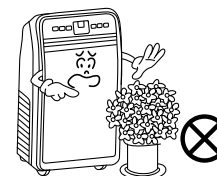

Do not place heavy items & objects on top of the appliance to avoid damaging it.



Do not operate appliance with wet hands or in damp areas.

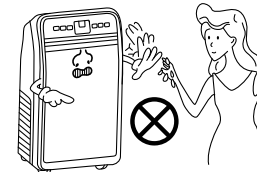

Wipe the appliance with a clean, damp cloth. Do not use wax, thinner or abrasive detergents.

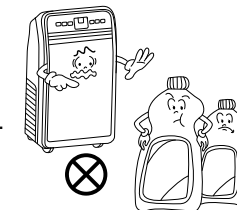

Clean the air filter regularly, or at least once every two weeks.

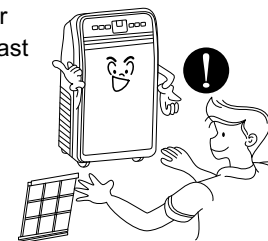

Never drink the condensed water discharged by the appliance.



Detach power cord from power supply if the appliance is not to be used.

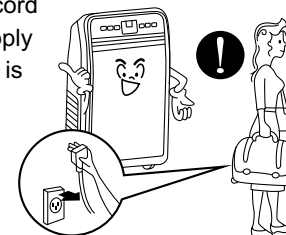

Only qualified technicians are allowed to disassemble and/or repair this appliance.

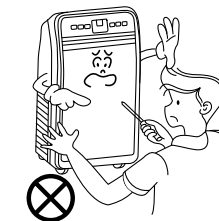

SAFETY TIPS

Do not operate appliance with a damaged power cord or power plug. Do not plug into loose power supply sockets.

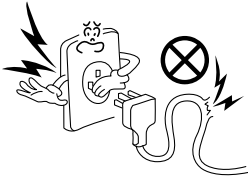

Always ensure the appliance meets the proper voltage requirements before operating.

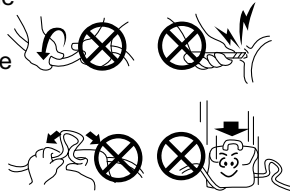

Do not attempt to modify or extend the power cord.

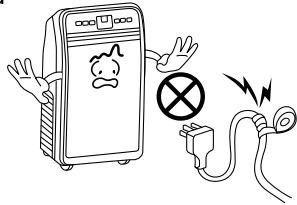

Use only a proper grounded power supply socket to operate the appliance.

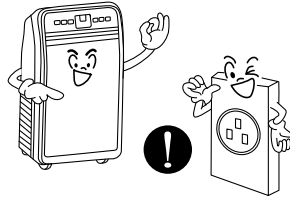

Do not operate appliance with wet hands to avoid the risk of electric shock.

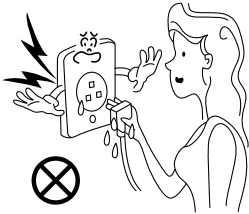

Gently pull the power plug to detach power cord from power supply. Never yank or pull the power cord.

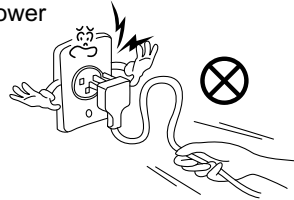

Do not power on/off the appliance by plugging/unplugging the power cord.

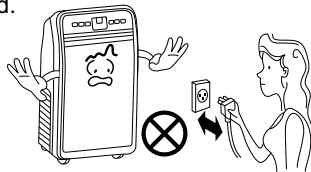

Always power off the appliance before disconnecting from the power supply.

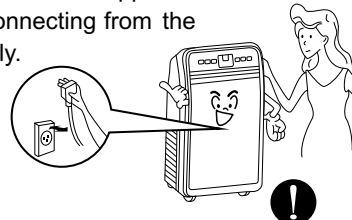

Do not share a power outlet with multiple high-powered appliances at the same time.

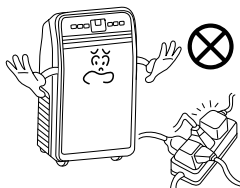

Keep appliance away from heat sources and avoid exposure to direct sunlight.

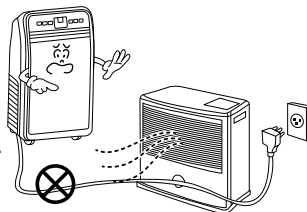

SAFETY TIPS

Disconnect from power supply & contact your authorized service agent immediately if appliance operates with loud noise, smoke or odour.



Do not place heavy objects on the power cord which may bend, twist or deform it to avoid the risk of a power shock.

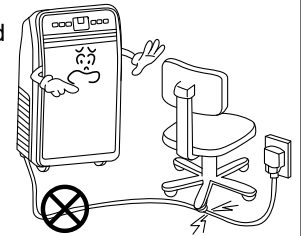

Never insert fingers or hard objects into the air vents.

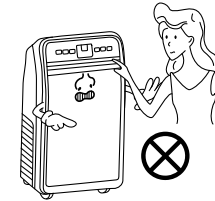

Do not allow water to come into contact with electrical parts.

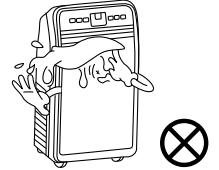

Turn off appliance and detach power plug if there is water inside it. Contact your authorized service agent immediately.



Turn off appliance and detach power plug when cleaning, replacing parts or moving.

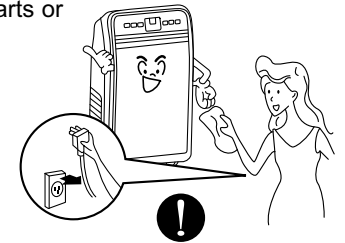

In the event of a gas leak, open windows immediately for proper air ventilation and operate the appliance.

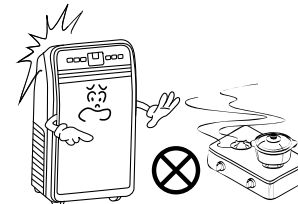

Children must never be allowed to play with this appliance nor should they perform maintenance without direct adult supervision



SPECIAL REMINDERS

It is recommended to place the A/C on stable surfaces and install it vertically for best performance.

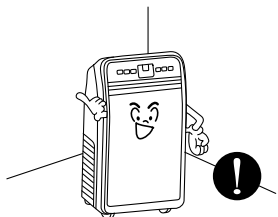

The appliance should be placed at least 50cm away from surrounding objects & the air ventilations must operate unobstructed.

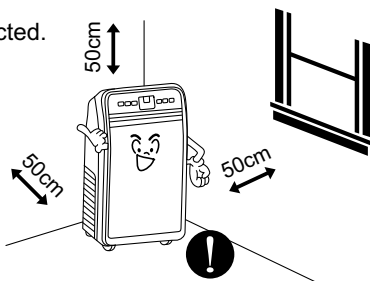

Do not operate the appliance near gasoline or other combustible liquids.

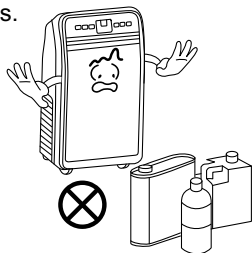

Do not use aerosol sprays or other solvents near the appliance as these may damage the plastic finishing & internal circuitry.

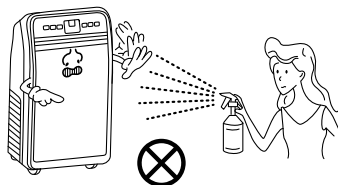

SPECIFICATIONS

MODEL NO.	MAC-121 SIERRAIRE
RATED VOLTAGE	220-240V~
FREQUENCY	50HZ
RATED WATTAGE	1370W
COOLING CAPACITY	3500W
REFRIGERANT	R410A/565G

PARTS IDENTIFICATION

1. Handle
2. Air Inlet
3. Control Panel
4. Wind Guide Bar
5. Caster
6. Remote Controller
7. Air Inlet Grille
8. Air Outlet
9. Dehumidification Drainage Nozzle
10. Power Cord
11. Exhaust Duct Assembly
12. Window Sealing Plate Assembly

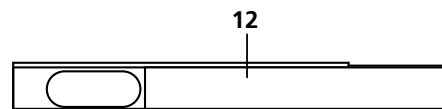
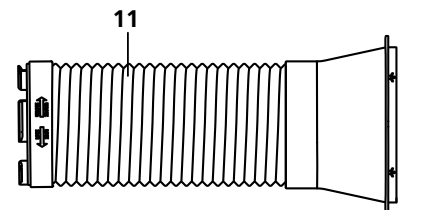
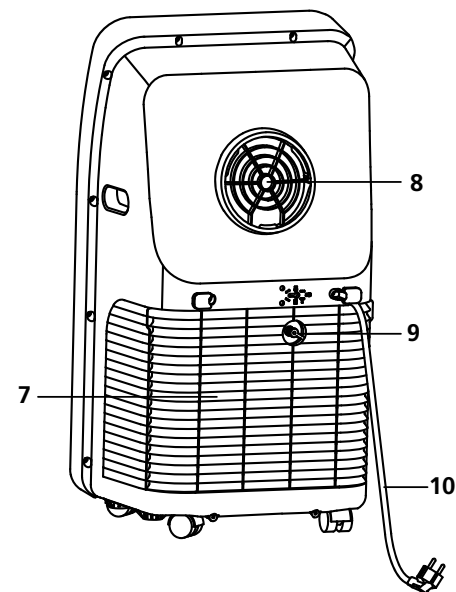
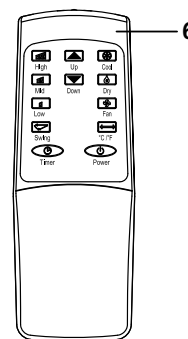
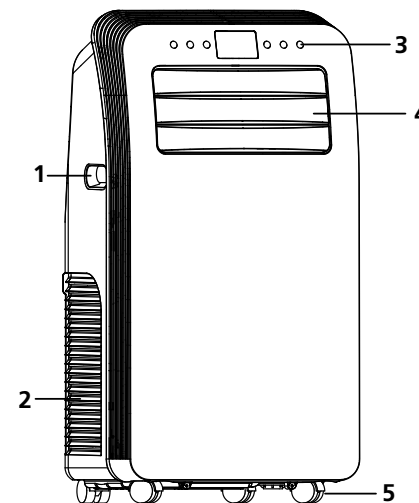

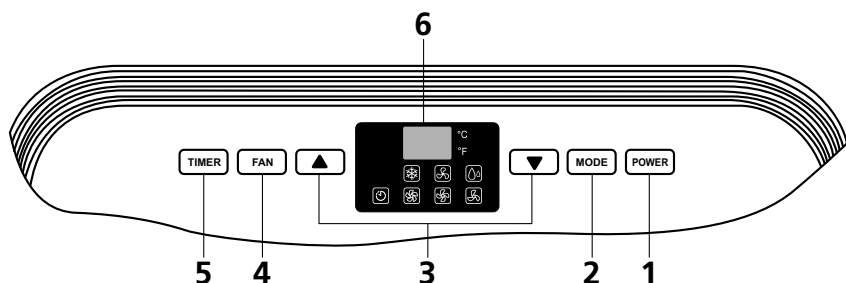

1. POWER KEY

Press the key to turn ON/OFF the A/C.

2. MODE KEY

Select from cooling, wind, dehumidification °

3. TEMPERATURE/ TIME ADJUSTING KEY

Press the key at cooling mode to increase/reduce the setting temperature; press it at timing mode to adjust timing ON/OFF time; press Up and Down keys simultaneously to switch Fahrenheit and Centigrade degree temperature.

4. FAN KEY

Select from high/ low gear wind speed.

5. TIMER KEY

In standby mode, select start & shutdown time.

6. TEMPERATURE/TIMER DISPLAY PANEL

7. °C/ °F SWITCHING KEY

Alternate between °C and °F.

8. SWING KEY

On standby mode, select to swing the wind guide bar automatically.

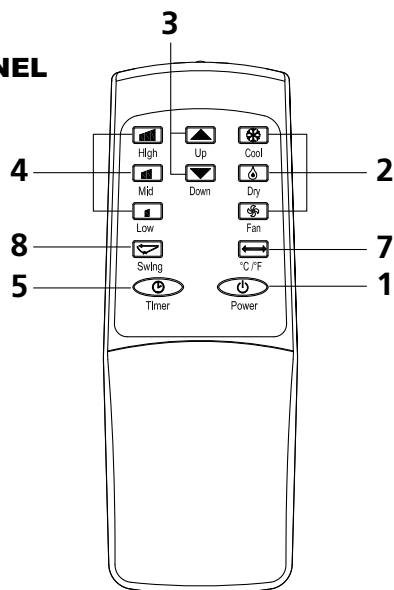

PLACEMENT

- Place the appliance on a flat & sturdy floor, preferably near a window.
- The appliance should be placed at least 50cm away from surrounding objects & the air ventilations must operate unobstructed.

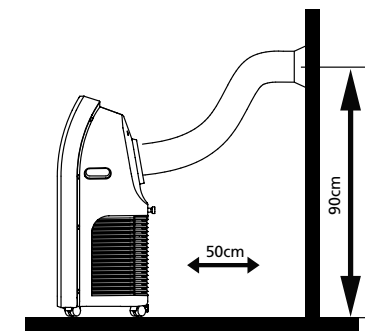

INSTALLATION

Exhaust pipe assembly

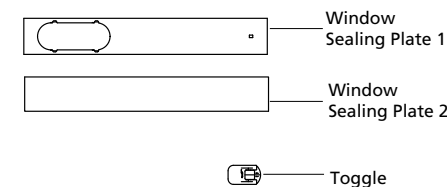
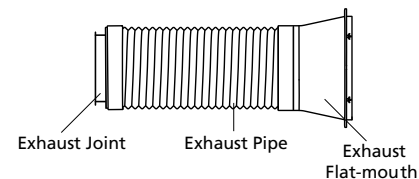

STEP 1:

- Measure window size.
- Adjust length of window sealing plate to fit window size.
- Once length of window sealing plate is determined, fix it by using the toggle.

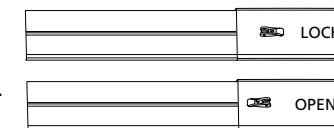

STEP 2:

- Install the fixed window sealing plate on the window.

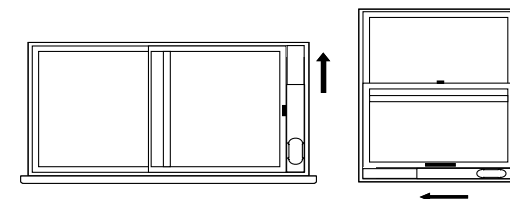

STEP 3:

- Use screws to secure the exhaust duct assembly into the air outlet located behind the panel (anti-clockwise).

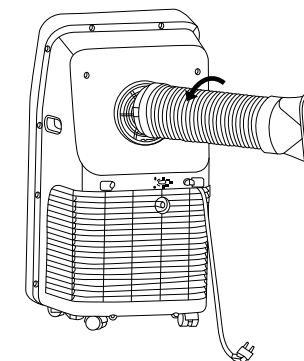

STEP 4:

- Place the exhaust pipe assembly (exhaust flat port) into the window sealing plate assembly & tighten with screws.

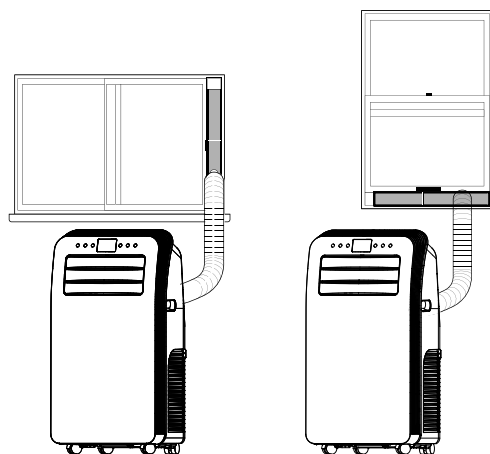
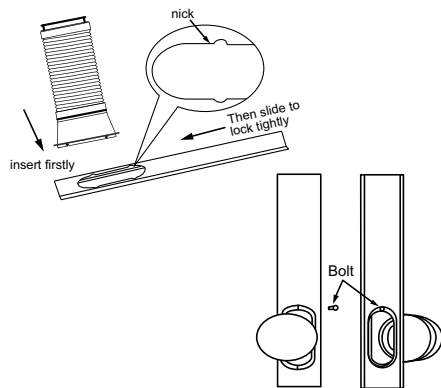

INCORRECT INSTALLATION

- Important! Keep the exhaust duct smooth. Incorrect installation will affect work of the A/C.
- Avoid bending or twisting the exhaust duct.
- Ensure air can flow smoothly in the duct.

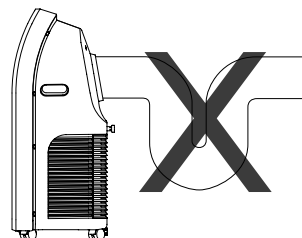

WARNING:

- The exhaust duct is designed exclusively for this model.
- Do not attempt to lengthen, modify or replace it as it will not work.

NOTE: Max. developed length of the exhaust duct is 1,500mm. It is recommended to shorten it and keep it horizontal while installation.

REMOTE CONTROLLER

Install batteries into the remote control before first use:

- Slide to open battery cover on the back of the remote control.
- Insert 2 new AAA batteries into their proper (+) and (-) terminals
- Slide back the battery cover into place.

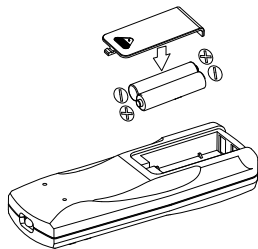

NOTE:

- Use only AAA batteries. Do not use rechargeable or other types of batteries.
- Do not mix old and new batteries.
- Remove batteries from the remote control if appliance is not to be used for a long time.

❄️ COOLING MODE

- Cooling indicator lamp will illuminate when the cooling mode is automatically or manually selected upon POWER ON.
- Press UP/DOWN key to adjust temperature setting (16°C~30°C).
- Press SPEED keys to select desire fan speed: HIGH/MID/LOW.

🌀 FAN MODE

- The WIND indicator lamp will illuminate when mode key or FAN mode is selected using the remote controller.
- Press SPEED key to choose HIGH/MID/LOW speed.
- Temperature cannot be set in FAN mode.

💧 DEHUMIDIFICATION MODE

- When pressing mode key or choosing dehumidification mode, the dehumidification indicator lamp will illuminate using the remote controller.
- To remove dehumidification water wedge, insert water manifold & place the end of the water manifold into the water vessel or drainage passage, as shown in the figure.
- If room temperature is $\geq 17^{\circ}\text{C}$ (62°F) in dehumidification mode, the compressor will automatically POWER ON.
- When room temperature is $\leq 15^{\circ}\text{C}$ (59°F), the compressor will POWER OFF.
- when room temperature increases to $\geq 17^{\circ}\text{C}$, the compressor will resume operation.
- As a protection feature, the compressor will be activated 3 minutes later.
- In dehumidification mode, the default fan speed is LOW. Wind speed cannot be adjusted.
- Temperature cannot be set in dehumidification mode.

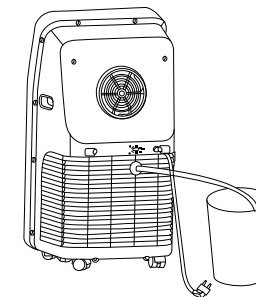

NOTE: It is recommended to detach the exit pipe components when using the dehumidification function, otherwise performance will be affected and a "FL" (water full alarm) will appear.

🕒 TIMER MODE

- In standby, press the TIMER key to set ON time. Press UP/DOWN keys to set ON time (1~24 hours), and the timer indicator lamp will illuminate.
- In standby, press the TIMER key to set OFF time. Press UP/DOWN keys to set OFF time (1~24 hours), and the timer indicator lamp will illuminate.

WATER DRAINAGE

This appliance is equipped with an automatic water vaporization system. The circulation of condensing water cools the condenser to improve cooling efficiency and save energy.

- If the internal vessel is full of water, the display screen will display “FL”, and the compressor will cease operation automatically.
- After POWER OFF, unscrew the water cover and detach the water wedge for water to drain.
- Restart appliance and resume operation.

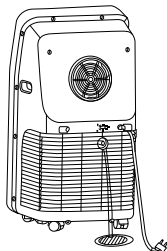

CARE & CLEANING

CAUTION: Always POWER OFF the appliance and disconnect from the power supply to avoid the risk of electric shocks before performing maintenance or repair.

CLEANING

- POWER OFF appliance & disconnect from power supply.
- Wipe with damp cloth. Do not use abrasive chemical agents such as benzene, alcohol, gasoline and so forth to avoid damaging the exterior finishing of the appliance.

IMPORTANT: Do not spatter or spill water into the interior circuits.

FILTER SCREEN

- Wash the filter screen once every two weeks.
- The appliance's operating efficiency will be affected by obstructions.
- Remove the air inlet grille and grip both sides of the filter screen to detach

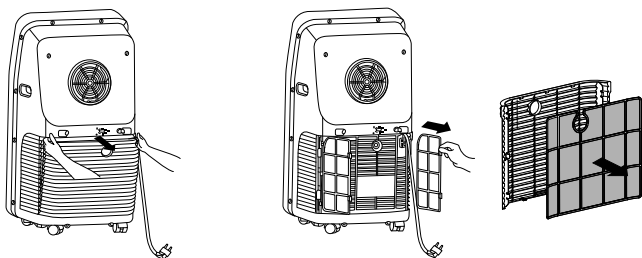

- Immerse the filter screen in warm water and wash using a neutral cleanser.
- Allow it to dry naturally before reassembly.

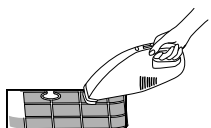

Use a vacuum cleaner to clean the filter screen if it is not too dirty.

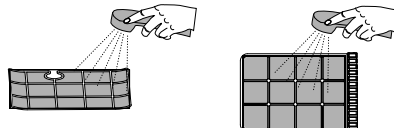

Alternatively, wash the filter screen in warm water (40°C) if it is not too dirty.

CARE & CLEANING

PERIODIC CLEANING

If the appliance is not to be used for long periods of time:

- Detach the water wedge to drain any remaining water inside.
- Operate the appliance in fan mode for 2 hours until its interior is dry.
- POWER OFF and disconnect from power supply.
- Wash the filter screen and reassemble it.
- Dismantle the exhaust duct and store it properly.
- Cover the appliance with a plastic bag and store in a dry place.

COMMON ERRORS & DIAGNOSIS

ERROR CODE	POSSIBLE CAUSES
E1	Coil temperature sensor error
E2	Indoor temperature sensor error
E4	Anti-freezing protection: coil temperature is too low resulting in appliance powering off. When temperature exceeds 8°C, the protection will deactivate & operation will resume.

TROUBLESHOOTING

PROBLEM	POSSIBLE CAUSES	SOLUTIONS
Aircon not functioning	<ul style="list-style-type: none"> • Appliance not connected to power supply. • Display panel shows “FL” • Timer OFF function activated. 	<ul style="list-style-type: none"> • Connect appliance to power supply. • Drain excess water, restart & resume operation. • Restart 3 minutes after power off.
Aircon starts frequently	<ul style="list-style-type: none"> • Appliance exposed to direct sunlight. • Doors & windows ajar with too many heat sources. • Dirty filter screen. • Air inlet/outlet obstructed. 	<ul style="list-style-type: none"> • Draw curtains. • Close doors & windows & remove heat source(s). • Clean or replace air filter. • Remove obstruction.
Noisy operation	<ul style="list-style-type: none"> • Appliance placed on uneven surface. 	<ul style="list-style-type: none"> • Reposition appliance on even & stable surface.
Compressor not functioning	<ul style="list-style-type: none"> • Delay protection activated. 	<ul style="list-style-type: none"> • Wait 3 minutes for temperature to decrease & power on.

NOTE: POWER OFF appliance & contact your authorized service agent in case problem still persists after performing troubleshooting.